



INSTRUCTIONS and PARTS LIST

For J-120 20-inch BAND SAW

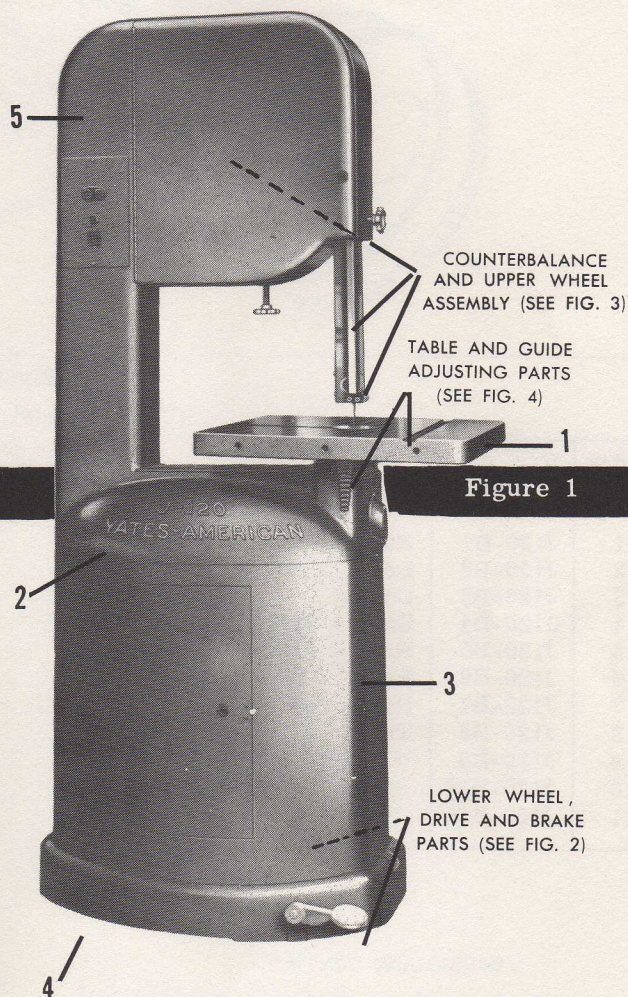

Figure 1

INSTALLATION

The J-120 Band Saw should be bolted to the floor for best results. Do not bolt the machine tightly to an uneven floor as it may distort the frame. Before bolting down, level the machine with a spirit level on the table. Make sure table is set at zero on the gauge indicating the degree of tilt. Use wooden wedges or shims under the feet of the base to level the machine.

Those parts covered with rust preventative coat should be washed off with suitable solvent cleaner.

REPAIR PARTS

When ordering repair parts, always give the Part number in the Parts List.

Parts List for Figure 1

Index No.	Part Number	Part Name
1	J120-A1	Table
2	J120-A2	Base (Upper)
3	J120-A3	Column assembly (Lower)
4	J120-A4	Base (Lower)
5	J120-A5	Column assembly (Upper)

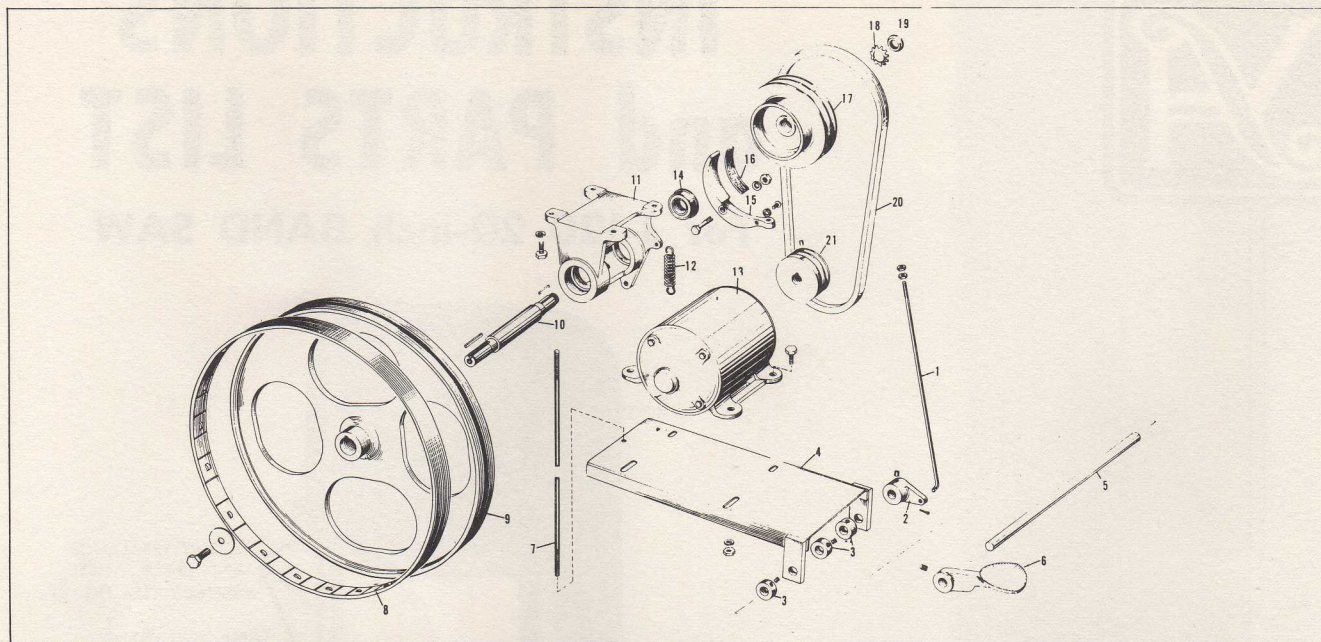

Figure 2

Parts List for Figure 2

Index No.	Part Number	Part Name
1	J120-B1	Rod - Brake
2	J120-B2	Lever - Brake
3	J120-B3	Collar
4	J120-B4	Base - Motor assembly
5	J120-B5	Shaft - Motor hinge
6	J120-B6	Pedal - Brake
7	J120-B7	Rod - Motor base
8	J120-B8	Tire
9	J120-B9	Wheel (Bottom)
10	J120-B10	Spindle - Wheel
11	J120-B11	Yoke - Bearing

Index No.	Part Number	Part Name
12	J120-B12	Spring - Brake
13	J120-B13	Motor (Give full name plate data when ordering)
14	J120-B14	Bearing (2 required)
15	J120-B15	Shoe - Brake
16	J120-B16	Lining - Brake
17	J120-B17	Sheave - Wheel
18	J120-B18	Washer - Lock, Saw
19	J120-B19	Nut - Lock
20	J120-B20	Belt - Vee
21	J120-B21	Sheave - Motor

WIRING AND CONTROL

The electric wiring required depends on the type of motor and switch furnished. The voltage of the motor is specified on packing slip with the machine.

The line wires should be run into hole found in the bottom of the base, from the source of power to the machine switch. Consult wiring diagram for proper connection.

On the front of the control box are the control buttons labeled "Start" and "Stop". One of these buttons may also be labeled "Reset" or there may be a separate reset lever. This reset is used when the switch has kicked out due to an overload, a short, or any other cause which might do damage to the electrical equipment. Always ascertain the cause of the switch kicking out before resetting it - something is wrong and needs attention. Always wait a minute or two for cooling before operating the reset.

When starting a 3 phase motor, if it runs the wrong direction, reverse any two of the line wire connections. The direction of motor rotation should always be checked before these connections are made permanently. Heater coils in the switch must be changed if voltage is changed from that specified on packing slip. When starting be sure main line switch is in. If machine does not start be sure the current is coming to the machine before looking for trouble elsewhere.

VEE BELT DRIVE

To adjust V belts, simply reposition nuts on belt tightener rod at the forward end of the hinged motor base. Use matched belts for replacement. Never use belt dressing of any kind on rubber V belts.

BRAKE ADJUSTMENT

Brake adjustment rod is attached to a lever on the motor base hinge rod.

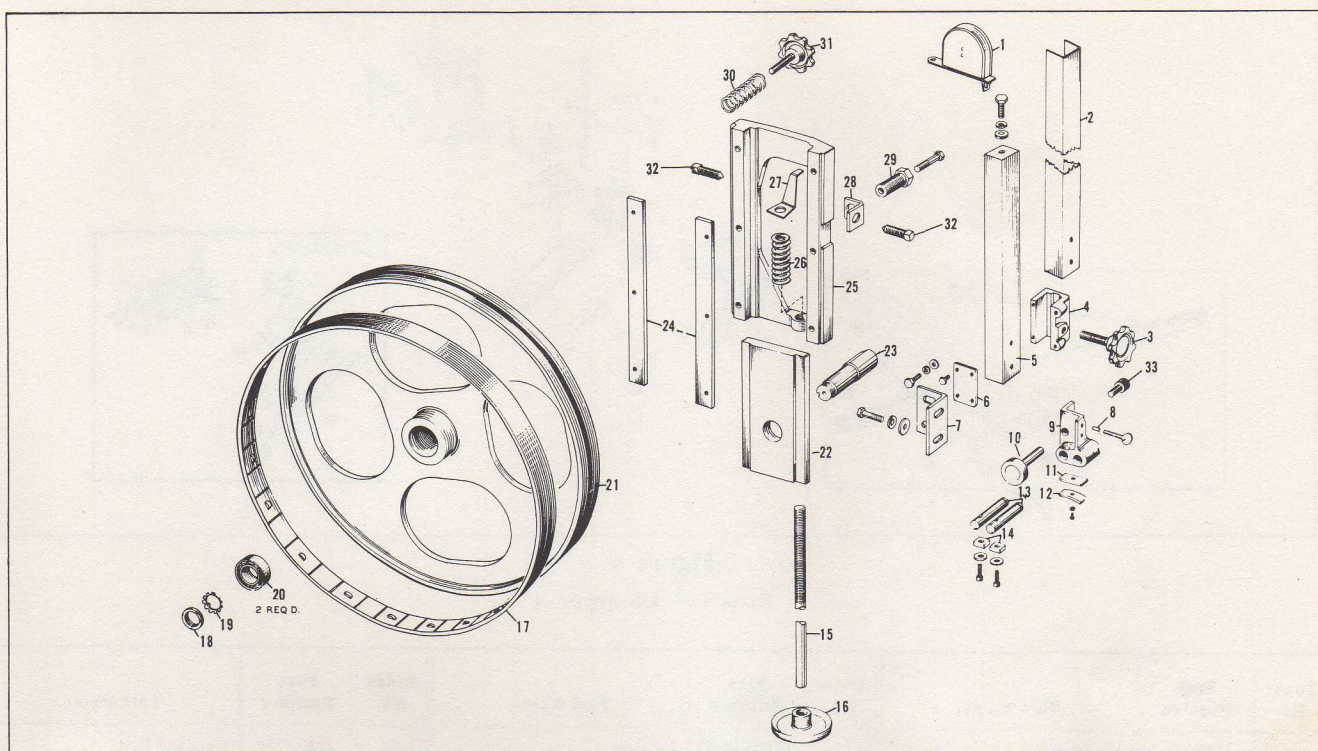

Figure 3

Parts List for Figure 3

Index No.	Part Number	Part Name
1	J120-C 1	Balance
2	J120-C 2	Guard - Saw
3	J120-C 3	Handwheel assembly
4	J120-C 4	Holder - Hoist bar
5	J120-C 5	Bar - Guide hoist
6	J120-C 6	Plate - Hoist bar holder
7	J120-C 7	Support - hoist bar holder
8	J120-C 8	Plugs
9	J120-C 9	Bracket - Guide, top
10	J120-C 10	Roller - Guide, assembly
11	J120-C 11	Gib - Guide post
12	J120-C 12	Spring - Guide
13	J120-C 13	Post - Guide
14	J120-C 14	Guide
15	J120-C 15	Screw - Wheel hoist
16	J120-C 16	Handwheel

Index No.	Part Number	Part Name
17	J120-B 8	Tire
18	J120-C 18	Nut - Lock
19	J120-C 19	Washer - Lock
20	J120-C 20	Bearings
21	J120-C 21	Wheel - Top
22	J120-C 22	Slide
23	J120-C 23	Spindle - Top wheel
24	J120-C 24	Gib - Cross head
25	J120-C 25	Cross head
26	J120-C 26	Spring
27	J120-C 27	Pointer - Strain
28	J120-C 28	Angle, - Top wheel adjusting
29	J120-C 29	Screw, - Top wheel adjusting
30	J120-C 30	Spring, - Wheel tilt
31	J120-C 31	Handwheel assembly
32	J120-C 32	Set Screw - cone pt.
33	J120-C 33	Screw - adjusting

REPLACING SAW BLADES

Open the hinged door over wheel. Raise saw guide to top position. Raise left rear section of table. (Some models have latch under the table). Remove throat plate from table. Ease tension of saw by turning the vertical screw (provided with handwheel) which will be found just below the top wheel. Remove cover of base. The saw can now be removed. After replacing saw, retrack and restrain as per following instructions.

LUBRICATION

No lubrication needed, as all running parts have lubricated-for-life bearings.

WHEELS

Wheels do not need oiling or greasing as they are provided with lubricated-for-life bearings.

MOTOR

The motor does not need any oil or grease as it has lubricated-for-life bearings.

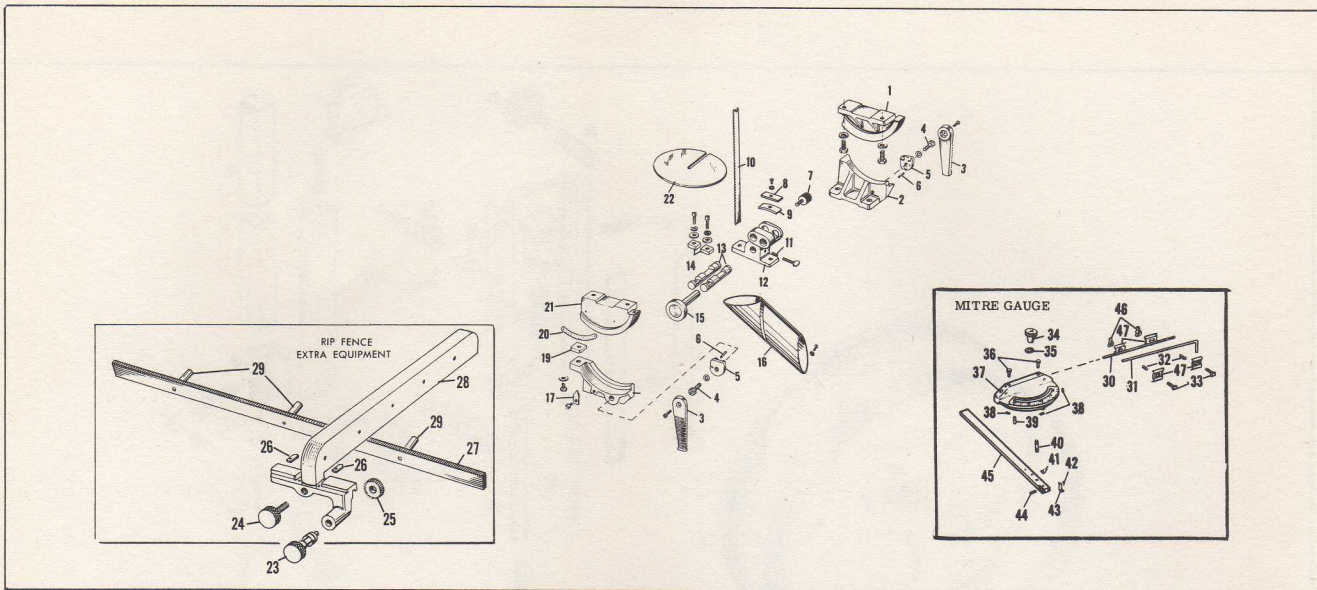

Figure 4

Parts List for Figure 4

Index No.	Part Number	Part Name	Index No.	Part Number	Part Name	Index No.	Part Number	Part Name
1	J120-D1	Arc (Rear)	17	J120-D15	Pointer	33	J120-D33	Carriage Bolt
2	J120-D3	Quadrant (Rear)	18	J120-D16	Quadrant (Front)	34	J120-D34	Knob
3	J120-D10	Handle - Lock	19	J120-D17	Stop - Table	35	J120-D35	Washer
4	J120-D11	Cap screw - Lock	20	J120-D18	Scale - Table, Tilt	36	J120-D36	Screw - Lock
5	J120-D12	Block - Lock	21	J120-D19	Arc (Front)	37	J120-D37	Body - Mitre Gauge
6	J120-D7	$\frac{1}{8} \times \frac{3}{4}$ Rollpin	22	J120-D21	Throat Plate	38	J120-D38	Set Screw
7	J120-C33	Screw - Adjusting	23	J120-D23	Shaft - Pinion	39	J120-D39	Pin - Pivot
8	J120-C11	Gib - Guide Post	24	J120-D24	Knob - Fence Locking	40	J120-D40	Stud - Clamp
9	J120-C12	Spring - Guide	25	J120-D25	Pinion	41	J120-D41	Stop
10	J120-D6	Blade	26	J120-D26	Pointer	42	J120-D42	Machine Screw
11	J120-C8	Plug	27	J120-D27	Rail, Scale	43	J120-D43	Pointer
12	J120-D9	Bracket - Guide (Bottom)	28	J120-D28	Fence	44	J120-D44	Roll Pin
13	J120-C13	Post - Guide	29	J120-D29	Plug for Rail	45	J120-D45	Bar - Mitre Gauge
14	J120-C14	Guide	30	J120-D30	Stop Rod	46	J120-D46	10-24 Wing Nut
15	J120-C10	Guide Assembly Roller	31	J120-D31	90° Stop Rod	47	J120-D47	Rod Clamp
16	J120-D13	Dust Chute	32	J120-D32	Spring			

ADJUSTING THE SAW GUIDES

The J-120 Band Saw has saw guides both below and above the table. These guides must be kept in proper adjustment to obtain long saw life. The side guides (the small steel block on each side of the blade) should be set in toward the blade so that the blade has just barely running clearance between them. They should not rub on the blade. If the faces of these blocks wear unevenly the block may be reversed. At the back of the guides is a knurled knob for forward adjustment of the side guides. This adjustment should be made so that the block just reaches the gullets of the teeth, that is, the entire teeth must project beyond the blocks. If the teeth run between the blocks the tooth set will be lost and the teeth dulled. The back guide, or roller behind the blade should be advanced, (by pushing its stem in) until the roller just clears the back of the blade. This roller should not revolve except when sawing stock. If it revolves all the time, the saw is not properly tracked or the guide is set too far ahead. This roller guide is locked by a thumb screw at the right of the guide. The top guide is adjustable vertically. It should always be run as close to the work as possible.

SAW TENSION

The saw is tensioned by tightening the vertical screw (provided with handwheel) which will be found just below the top wheel. In back of cover for top wheel will be seen a scale which is stamped with various saw widths. Tighten the vertical screw until this scale indicates the width of saw being used.

TRACKING THE SAW

The saw should be tracked to run about in the center of the wheel face. To do this, stand at the right of the saw and revolve the top wheel by hand. With the right hand turn the tracking screw, (the small horizontal screw with the hand wheel) at the back of the top wheel for vertical tilt. For parallel adjustment a double screw appears on the back to the side of the vertical tilt screw. For adjustment, loosen the inner screw and turn the outer screw for alignment. After alignment lock with inner screw. Normally this adjustment is not necessary as this setting is made at the factory.

EXHAUST SYSTEM

The exhaust system should be attached to dust chute on the right hand side of the machine.

FENCE (Extra Equipment)

The fence is made with both sides finished so that it may be used on either side of the saw. To change sides: pull knob to disengage gear and rack. Lift fence from rail and place on other side of saw. A micrometer set is provided for the fence consisting of a rack on the rail meshing with a pinion on the fence, the pinion being turned by the knurled knob at the right hand end of the fence. Set the fence to approximate position by just pushing it along rail, then use the micrometer set for the last line adjustment.

MITER GAUGE (Extra Equipment)

The miter gauge, in addition to the usual scale which indicates angular setting, has positive stops at 0 degrees and 45 degrees. When moving from "Zero" lift finger stop and swing to desired setting.

TILTING TABLE

The table can be tilted 45 degrees right and 12 degrees to the left. The tilt is locked by a hand-wheel, below table front and rear.