

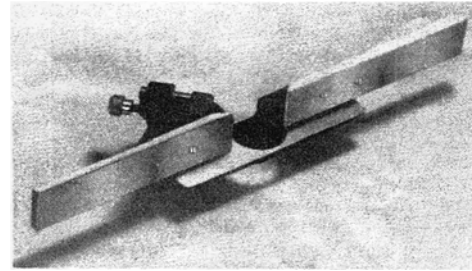

Instructions for
Installation and Operation of
**JOINTER-SHAPER FENCE
and JOINTER CUTTER**



**To Assemble and Install the
Jointer - Shaper Fence:**

1. Bolt metal fences to vertical milled faces of base casting so that counter-sunk screw heads are flush with face of fence or slightly below surface.
Use the short bolts (1" long) on the adjustable side of the base casting.
Use the long bolts (1 1/4" long) on the stationary side of the base casting.
The metal spacers are provided to use when jointing with the 2" Jointer Head. Place these spacers between the metal fence and the stationary side of the base casting.

2. Remove saw table insert from **SHOPSMITH** table.
3. Place Jointer-Shaper Fence in inset opening with adjusting knob toward front of table.
4. Slide fence clamp castings to front and rear of saw table to the limit of their travel.
5. Tighten wing nuts.
6. Fence board must be absolutely parallel. Shim back of boards if required.

To Set Up for Jointing:

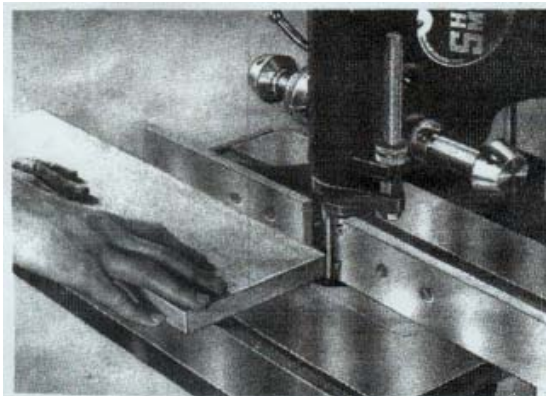

1. Be sure metal spacers are placed between the metal fence and the stationary side of the base casting.
2. Check your Jointer Head to make certain the blades are set properly. Be sure all blades are tightly secured.
3. Secure cutter to **SHOPSMITH** spindle with the two Allen set screws.
4. Tilt table at right angle to cutter.
5. Raise table (use table raiser if available) and adjust height so that rear fence face is flush with outside cutting diameter of the blades.
6. Slide metal fence until end clears cutter by approximately 1/8" . Tighten nuts.
7. Speed for jointing should be approximately 3600 R.P.M. (or more with speed changer).
8. Turn knob to adjust depth of cut. For deep cuts, repeated passes over cutter may be desirable. The maximum cut for each pass should not exceed 1/8". Setting is maintained by securing small Allen set screw.

9. Jointer Operations:

Jointing may be performed with **SHOPSMITH** in either horizontal or vertical position. Choose that position which provides greatest convenience and safety.

- a. To "edge" wide work pieces, use horizontal position so that the table acts as high fence. For narrow work, use **SHOPSMITH** in vertical -position so that hands will not have to pass above cutter.
- b. To rabbet (make an L- shaped cut in end or edge of board):
 - (1) Move cutter away from saw table the distance equal to the desired width of rabbet cut.
 - (2) Pass work through cutter in same manner as edging or on-end cutting.

safty:

As a general rule, do not allow your hands to pass above cutter at any time. The wood may suddenly split under pressure and drop your hand into the blade. *Use push sticks at all times.*

To Use as a Shaper:

(Do not use the metal spacers.)

1. Place desired cutter on shaper-adapter; use collars to achieve correct spacing.
2. Secure shaper adapter to spindle with Allen set screw.
3. If cut desired does not require removal of wood from entire edge of workpiece, both fence boards should be flush. If it does, then depth of cut is adjusted with front fence.
4. Correct cutter blade location is obtained by adjusting saw table.
5. **SHOPSMITH** can be used as a shaper in either vertical or horizontal position.
6. If used without speed changer, use top speed of 3600 **R.P.M.** With speed changer 6000 - 6500 **R.P.M.**
7. Shaping is very similar to jointing except that a contour rather than straight edge is produced. All straight run shaping operations can be accomplished in same manner as the jointer operations previously described. Shaping a curved surface does not require the jointer-shaper fence. It is accomplished by shaping against a collar mounted on the shaper adapter with **SHOPSMITH** in the vertical position.

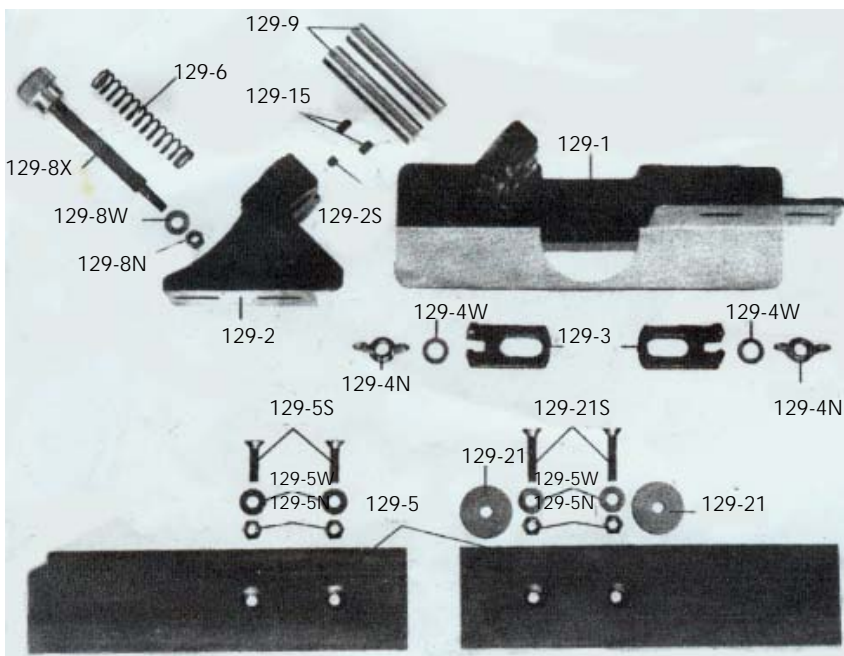
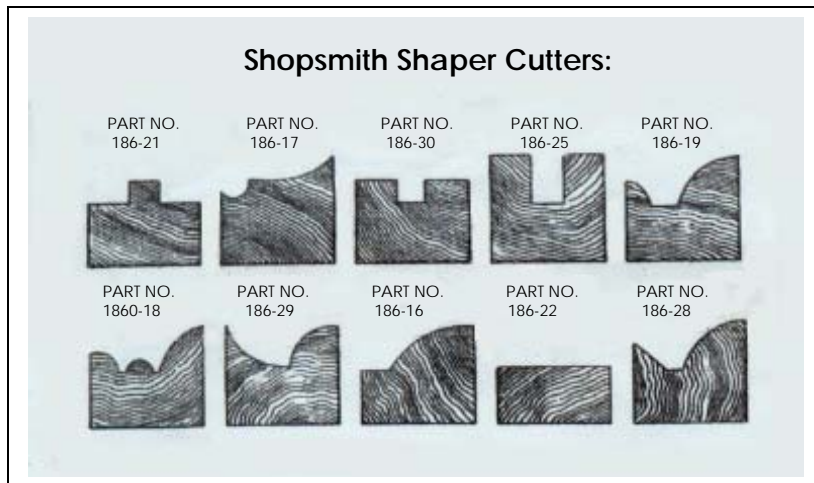
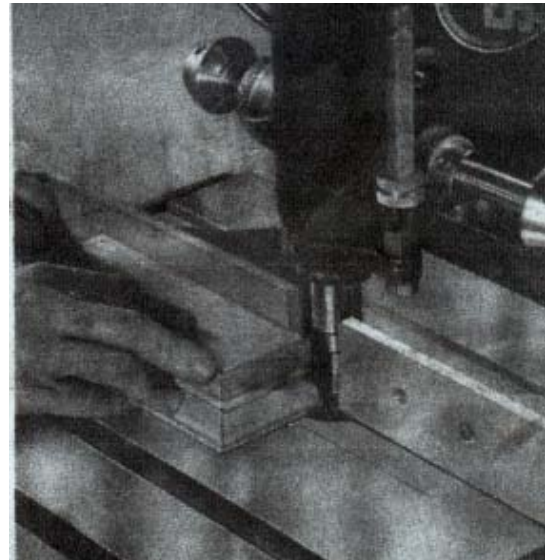

Part Number	Description	List Price	Ship. Wt.	
			Lbs.	Oz.
129-1	Jointer Shaper Base	\$3.95	1	8
129-1S	¼ x20x3/8 Cup Point Allen Set Screw	.60		3
129-2	Fence Adjustment	1.95		11
129-2S	¼ - 20 x1/4 Flat Point Allen Set Screw	.10		3
129-3	Jointer Shaper Clamp	.25		4
129-4N	3/8 -16 Parker Kalon Steel Wing Nut	.10		3
129-4W	AN-960-616 Std. Aircraft Washer	.05		3
129-5	Jointer Shaper Fence	1.25		9
129-5N	¼ - 20 Std. Semi Finish Jam Nut	.05		3
129-5W	¼ SAE Std. Washer	.05		3
129-5S	¼ - 20 x 1 Flat Head Machine screw	.05		3
129-6	Jointer shaper Spring	.10		3
129-8X	Fence adjustment Shaft and knob	.50		6
129-8N	¼ - 28 Elastic Stop Nut	.10		3
129-8W	AN 960-416 Std. Aircraft Washer	.05		3
129-9	Fence guide Pin	.50		7
129-21	Jointer shaper	.10		4
129-21S	¼ - 20 x 1- ¼ Flat head Machine Screw	.05		3