



REG. TRADEMARK

## ROUTER DOUBLE INSULATED

MODEL NO.  
315.17380

**CAUTION:**  
Read Rules for  
Safe Operation  
and Instructions  
Carefully

- Introduction
- Operation
- Repair Parts

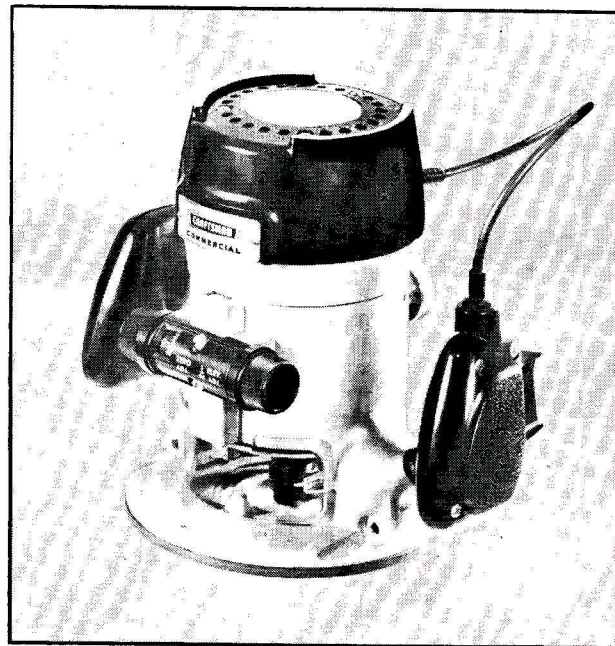

THIS SAFETY SEAL OF THE POWER TOOL INSTITUTE ASSURES YOU:



1. That the manufacturer's power tools, including the particular tool associated with the Seal, are produced in accordance with applicable Standards for Safety of Underwriters' Laboratories and American National Standards (ANSI).
2. That compliance with applicable safety standards is assured by independent inspection and testing conducted by Underwriters' Laboratories (UL).
3. That every motorized tool is inspected under power.
4. That every tool has with it adequate instructions and a list of safety rules for the protection of the user.
5. That the tool manufacturer is a member of the Power Tool Institute and is a sponsor of the Institute's Consumer Safety Education Program.

COPYRIGHT, 1969, BY POWER TOOL INSTITUTE, INC. ALL RIGHTS RESERVED

Designed exclusively for and sold only by  
SEARS, ROEBUCK AND CO.—Chicago, Illinois 60607 U.S.A.  
and SIMPSONS-SEARS LIMITED—Toronto



## GUARANTEE

CRAFTSMAN PORTABLE ELECTRIC TOOLS ARE UNCONDITIONALLY GUARANTEED FOR ONE YEAR TO GIVE COMPLETE SATISFACTION OR RETURN FOR FREE REPLACEMENT.

THIS GUARANTEE SERVICE IS AVAILABLE BY SIMPLY RETURNING THE TOOL TO ANY SEARS STORE.

SEARS, ROEBUCK AND CO. and SIMPSONS-SEARS LTD.

## introduction

### DOUBLE INSULATION

Double Insulation is a concept in safety, replacing the standard grounded supply system, in electric power tools. The construction of a double insulated tool affords compatible protection to a properly grounded tool without the necessity for using a grounded conductor. The double insulation system eliminates the need for the usual three wire grounded power cord and grounded supply system. Whenever there is electric current in the tool there are two complete sets of insulation to protect the user. All exposed metal parts are isolated from the internal metal motor components with protecting insulation. The lead wires, switch, etc. with their

functional insulation have the added protection of non-conductive sleeving or housings to complete the double insulation system.

SERVICING OF A TOOL WITH DOUBLE INSULATION REQUIRES EXTREME CARE AND KNOWLEDGE OF THE SYSTEM AND SHOULD BE PERFORMED ONLY BY A QUALIFIED SERVICE TECHNICIAN. FOR SERVICE WE SUGGEST YOU RETURN THE TOOL TO YOUR NEAREST SEARS STORE FOR REPAIR WHICH WILL BE DONE WITH ORIGINAL FACTORY REPLACEMENT PARTS.

Your Router is the latest development in electric woodworking tools. It has been designed to give you the finest performance in joinery and most beautiful cabinet work. This unit enables the operator to rapidly accomplish inlay work, patternwork and many other types of carving and wood-finishing.

results. Very little practice is needed to guide the router along pattern line onto the workpiece surface. By combining various types of cuts you can obtain original and distinctive effects.

Many exclusive features combine to make this new Router an ideal tool for professional use with precision

The results and beauty of work that can be done in this fashion are limited only by the artistic ability and skill of the operator.

### RULES FOR SAFE OPERATION



1. **KNOW YOUR POWER TOOL** — Read owner's manual carefully. Learn its applications and limitations as well as the specific potential hazards peculiar to this tool.
2. **GROUND ALL TOOLS — UNLESS DOUBLE-INSULATED.** If tool is equipped with three-prong plug, it should be plugged into a three-hole electrical receptacle. If adapter is used to accommodate two-prong receptacle, the adapter wire must be attached to a **known** ground. (Usually the screw securing the receptacle cover plate.) **Never** remove third prong.
3. **KEEP GUARDS IN PLACE** and in working order.
4. **KEEP WORK AREA CLEAN.** Cluttered areas and benches invite accidents.
5. **AVOID DANGEROUS ENVIRONMENT.** Don't use power tool in damp or wet locations. And keep work area well lit.
6. **KEEP CHILDREN AWAY.** All visitors should be kept safe distance from work area.
7. **STORE IDLE TOOLS.** When not in use, tools should be stored in dry, high or locked-up place—out of reach of children.
8. **DON'T FORCE TOOL.** It will do the job better and safer at the rate for which it was designed.
9. **USE RIGHT TOOL.** Don't force small tool or attachment to do the job of a heavy duty tool.
10. **WEAR PROPER APPAREL.** No loose clothing or jewelry to get caught in moving parts. Rubber gloves and footwear are recommended when working outdoors.
11. **USE SAFETY GLASSES** with most tools. Also face or dust mask if cutting operation is dusty.
12. **DON'T ABUSE CORD.** Never carry tool by cord or yank it to disconnect from receptacle. Keep cord from heat, oil and sharp edges.
13. **SECURE WORK.** Use clamps or a vise to hold work. It's safer than using your hand and it frees both hands to operate tool.
14. **DON'T OVERREACH.** Keep proper footing and balance at all times.
15. **MAINTAIN TOOLS WITH CARE.** Keep tools sharp at all times, and clean for best and safest performance. Follow instructions for lubricating and changing accessories.
16. **DISCONNECT TOOLS.** When not in use, before servicing; when changing attachments, blades, bits, cutters, etc.
17. **REMOVE ADJUSTING KEYS AND WRENCHES.** Form habit of checking to see that keys and adjusting wrenches are removed from tool before turning it on.
18. **AVOID ACCIDENTAL STARTING.** Don't carry plugged-in tool with finger on switch.

COPYRIGHT, 1969, BY POWER TOOL INSTITUTE, INC. ALL RIGHTS RESERVED

## CUSTOMER INSTRUCTIONS

1. **DO** read thoroughly INTRODUCTION and OPERATING INSTRUCTIONS before using your ROUTER.
  2. **DO** be sure switch is in "OFF" position before connecting tool to power supply.
  3. **DO** disconnect power cord when cleaning or doing maintenance on tool.
  4. **DO** be sure the voltage of the power supply agrees with the dataplate marking on the unit.
  5. **DO** use correct size extension cord as recommended.
  6. **DO** replace both brushes when either is worn to about 1/4 inch in length.
  7. **DO** use only specified replacement parts.
  8. **DO** disconnect from power source and store in a clean dry place.
  9. **DO** check bits and cutters periodically for tightness.
  10. **DO** keep collet clean.
1. **DON'T** use your ROUTER before reading thoroughly, INTRODUCTION and OPERATING INSTRUCTIONS.
  2. **DON'T** leave Router unattended before disconnecting from power source.
  3. **DON'T** allow the cord near cutter bit when operating.
  4. **DON'T** allow children to operate Router.
  5. **DON'T** carry unit by power cord.
  6. **DON'T** force tool, allow Router to perform as it was designed.
  7. **DON'T** plug or cover air vents to keep dust from flying. Vents must be kept open to keep motor cool.
  8. **DON'T** leave the power cord connected to the power supply when installing or changing cutters.
  9. **DON'T** use dull knives or cutters since they will not produce good work and will cause overloading.

## CAUTION



The operation of any power tool can result in foreign objects being thrown into the eyes, which can result in severe eye damage. Always wear safety glasses or eye shields before commencing power tool operation. We recommend Wide Vision Safety Mask for use over spectacles, or standard safety glasses . . . available at Sears retail or catalog stores.

**AVOID USE OF ALL SOLVENTS WHEN CLEANING PLASTIC PARTS. USE CLEAN CLOTHS AND WIPE PARTS AS MUCH AS POSSIBLE TO REMOVE DIRT, CARBON DUST, ETC. MOST PLASTICS ARE SUSCEPTIBLE TO VARIOUS TYPES OF COMMERCIAL SOLVENTS AND MAY BE DAMAGED BY THE USE OF THESE SOLVENTS.**

**THIS PRODUCT, or any electrical product, requires extreme care when service repairs are made. A dangerous electrical hazard can be created by tampering with the electrical or insulating systems or in the replacement or substitution of repair parts. Repairs should be made only by a qualified technician. If service is required we suggest you return the tool to your nearest Sears store for approved service with original factory replacement parts.**

**WHEN ELECTRIC TOOLS ARE USED ON FIBER-GLASS boats, sports cars, etc. it has been found that they are subject to accelerated wear and possible premature failure, as the fiberglass chips and grindings are highly abrasive to bearings, brushes, commutator, etc. Consequently it is not recommended that this tool be used for continuous production work on any fiberglass material. During any use on fiberglass it is extremely important that the tool is cleaned frequently by blowing with an air jet.**

**EXTENSION CORDS—The use of any Extension cord will cause some loss of power. To keep this to a minimum and to prevent overheating and motor burn-out, use the table below to determine the MINIMUM wire size (A.W.G.) Extension Cord.**

Extension Cord Length	Wire Size A.W.G.
25- 50 Feet	16
50- 75 Feet	14
75-100 Feet	12

**Extension cords suitable for use with your Router are available at your nearest Sears Catalog Order or Retail Store.**

**Another time saving convenience is a cord-lock offered by Sears which prevents separation of cord. Cord-lock is available at your nearest Sears Retail Store or Catalog Order House.**

# operating

**CHUCK**—Your Router chuck is a precision collet type. **IMPORTANT—DO NOT TIGHTEN THE COLLET UNLESS A FULL SIZE 1/4 INCH SHANK BIT IS IN THE COLLET AS THIS MAY CAUSE THE COLLET TO BEND AND PREVENT THE INSERTION OF THE CUTTER SHANK INTO THE COLLET.** Clean collet, collet nut and motor shaft taper frequently to maintain accuracy.

**TO INSTALL CUTTERS—IMPORTANT—BE SURE POWER CORD IS DISCONNECTED FROM POWER SUPPLY.** Insert shank of cutter all the way into collet, then withdraw the shank of the cutter approximately 1/8" away from bottom. Hold lock nut, Key No. 37, (See parts list, page 7), with locking lever, Key No. 39 and tighten collet nut, Key No. 31, securely with wrench provided.

To remove cutter, loosen collet nut, Key No. 31, enough to allow cutter to slip easily from collet.

**TO ADJUST FOR DEPTH OF CUT—IMPORTANT—BE SURE POWER CORD IS DISCONNECTED FROM POWER SUPPLY.** (See Fig. 1) Place the router on a flat surface and loosen lock knob (C). Turn height adjusting knob (A) until tip of router bit just touches the surface. Turn indicator Knob (B) to "O". Position router so that the bit can be projected below the base for desired setting. Now adjust to desired depth of cut by turning height adjusting knob slightly past the desired setting, then returning to the desired setting. This will insure a more accurate depth-of-cut adjustment. Tighten lock knob.

On successive cuts, always set indicator to "O" before loosening lock knob. The amount of cutter movement can then be read directly on the scale. Note that each graduation of the scale indicates 1/64 inch change in setting.

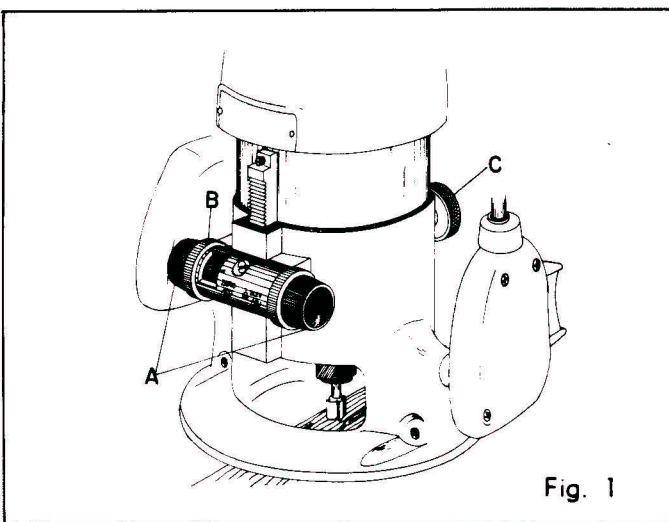

Fig. 1

A clamp bar, Key No. 36, (See parts list page 7) has been provided to assure smooth elevation of the motor with the motor unit unclamped in base. The clamp bar is adjusted until light pressure is applied to the side of the motor housing. This pressure must be sufficient to hold the motor unit in an elevated position, unclamped, yet permit the motor unit to be moved. The clamp bar is adjusted at the factory and should not have to be changed for sometime under normal use, however, after prolonged use normal wear of clamp bar may allow loosened condition. Should this occur loosen hex nuts, Key No. 35 and then tighten set screws, Key No. 71, until desired adjustment is obtained. Hold set screws with an allen wrench to prevent turning and tighten hex nuts.

**SIZE OF CUT**—The average cut should not exceed 1/4" depth per pass when using larger cutters. In hardwoods, two or three passes should be made when using the largest cutters available. Two or three passes in hardwood are more practical than risking possible damage to the motor unit or cutter breakage through overloading.

**PROPER CARE OF CUTTERS**—The best results for fast accurate cutting are obtained by using cutters which are sharp. A properly sharpened cutter will not only prolong the life of the router but will make the job of cutting both faster and easier.

Keep cutters clean. Avoid, if possible, running hot and smoking. Remove any accumulated pitch and gum from sides with kerosene.

Follow procedure described below for sharpening cutters. Grind only the inside of the cutting edge of cutters. When grinding cutters, it is sometimes necessary to touch up the end. Be sure when grinding end of cutters to grind the clearance angle the same as that originally furnished. Never grind the outside diameter of cutters as they are specially ground for proper clearance.

**TO ASSEMBLE EYESHIELD TO ROUTER:** The eyeshield, Key No. 76, attaches to the front of the router, covering the opening below the micrometer adjustment knobs. Gently squeeze the shield at each end so that the two tabs fit into the router base opening. Releasing the shield will cause it to securely grasp the edge of the base "window."

## LUBRICATION

All the bearings in this tool are lubricated with a sufficient amount of high grade lubricant for the life of the unit under normal operating conditions, therefore, no further lubrication is required.

**BRUSH REPLACEMENT**

Periodically check brushes for wear and replace both brushes when either is worn to about 1/4 inch in length. To check length of brushes they must be removed from the unit (see instructions below). Replacement of these relatively inexpensive parts, when necessary, will keep your Router operating more efficiently and prolong the life of the motor.

Replacement of worn-out brushes is considered normal operating maintenance and is not therefore covered by guarantee.

**IMPORTANT—BE SURE POWER CORD IS DISCONNECTED FROM POWER SUPPLY. DEPRESS TRIGGER AND LOCK AND LEAVE IN LOCKED POSITION UNTIL END COVER IS REPLACED AND SECURED WITH SCREWS.** (See Fig. 2) To replace carbon brushes, Key No. 46, (See parts list, Page 7) place router upright on flat surface and remove three screws, Key No. 56. Remove end cap, Key No. 55. Unscrew brush cap, Key No. 47, and remove old brush. Replace both brushes making sure when inserting that curvature of brush matches curvature of the surface of the motor to which it is mated. Make sure brushes move freely in holders. Replace brush caps, end cap and screws.

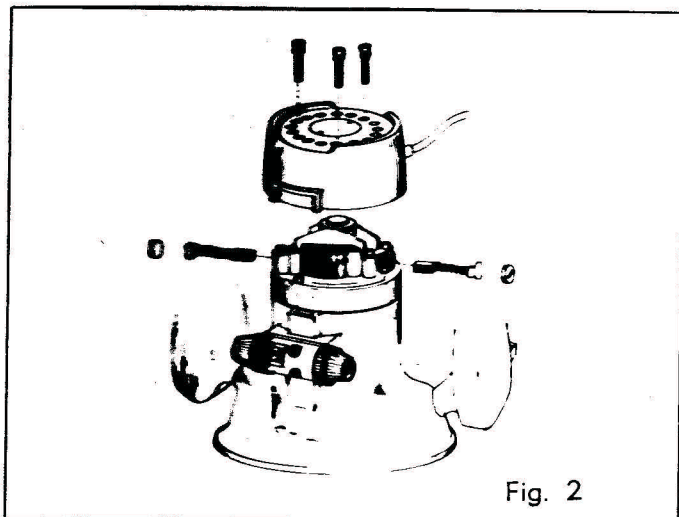
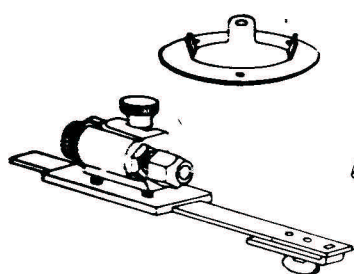
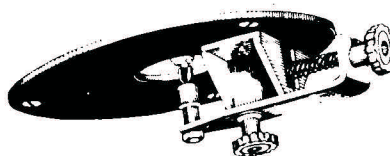

Fig. 2

**ACCESSORIES ADD GREATER VERSATILITY**



**CUTTER GRINDING ATTACHMENT**



**LAMINATE TRIMMER**

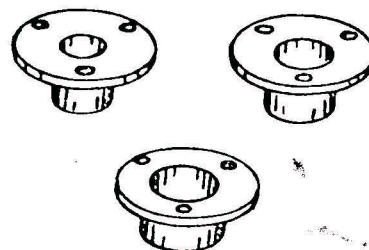

**GUIDE BUSHINGS**



*Buy Craftsman Shop Tested Accessories*

**ATTACH-LITE**

**TRAMMEL POINT**

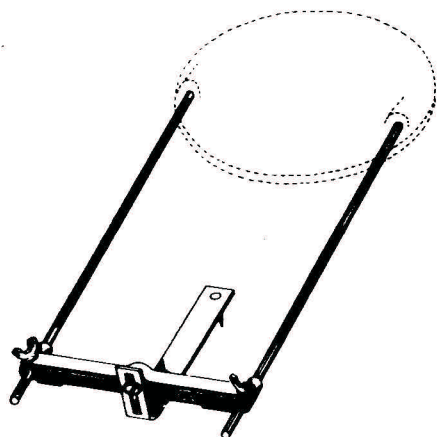

**DOVETAIL TEMPLATE**

**EDGE GUIDE AND CONTOUR FINGER**

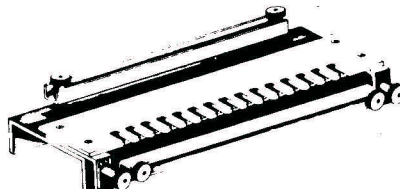
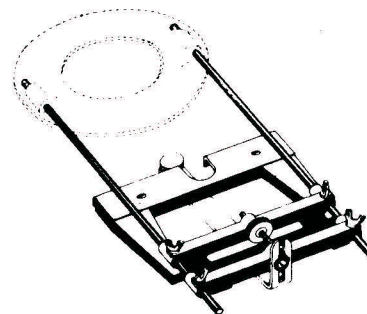

**WHEN USING ATTACHMENTS ALWAYS WEAR SAFETY GLASSES AND FOLLOW MANUFACTURERS RECOMMENDATIONS AS TO THEIR USE**

**ADDITIONAL ACCESSORIES AVAILABLE — VISIT YOUR NEAREST SEARS RETAIL STORE OR CATALOG OFFICE FOR A COMPLETE SELECTION**

CRAFTSMAN ROUTER—MODEL NUMBER 315.17380

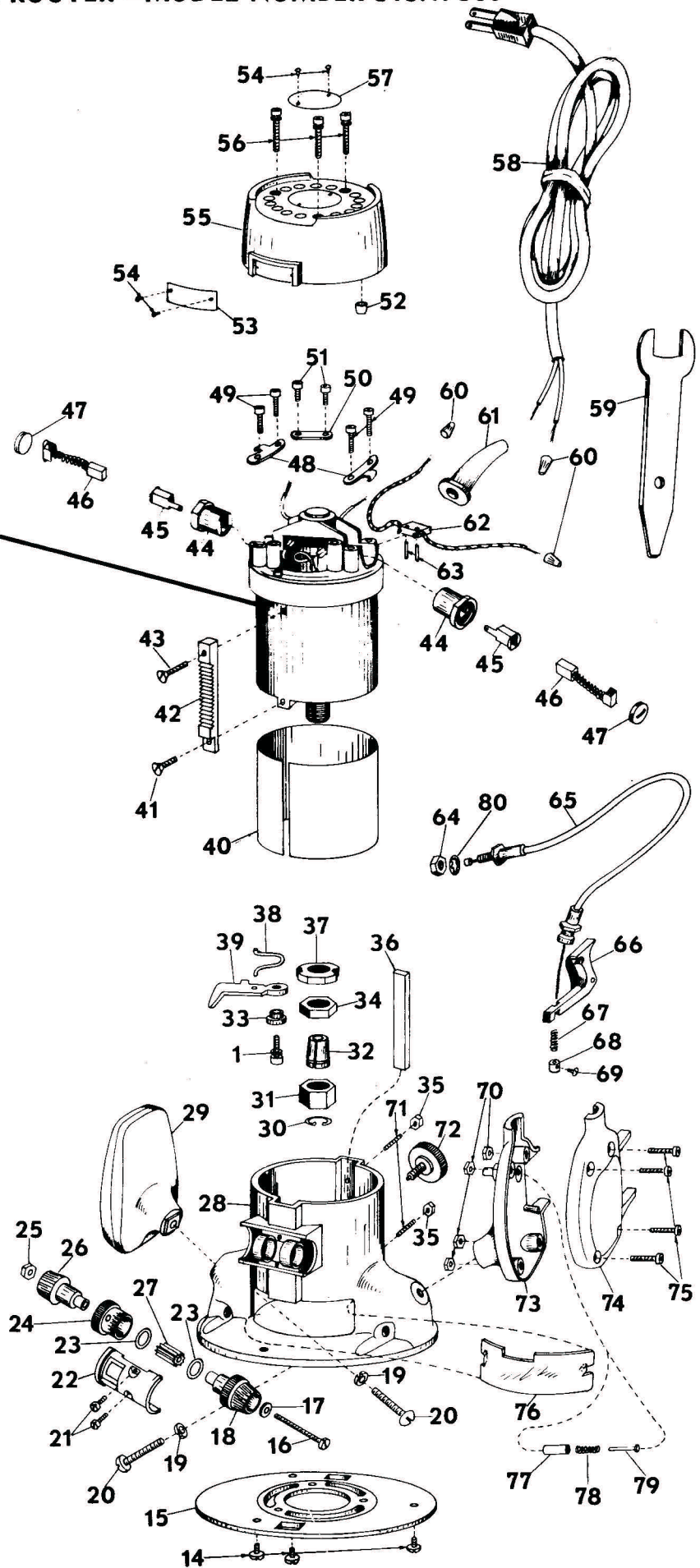
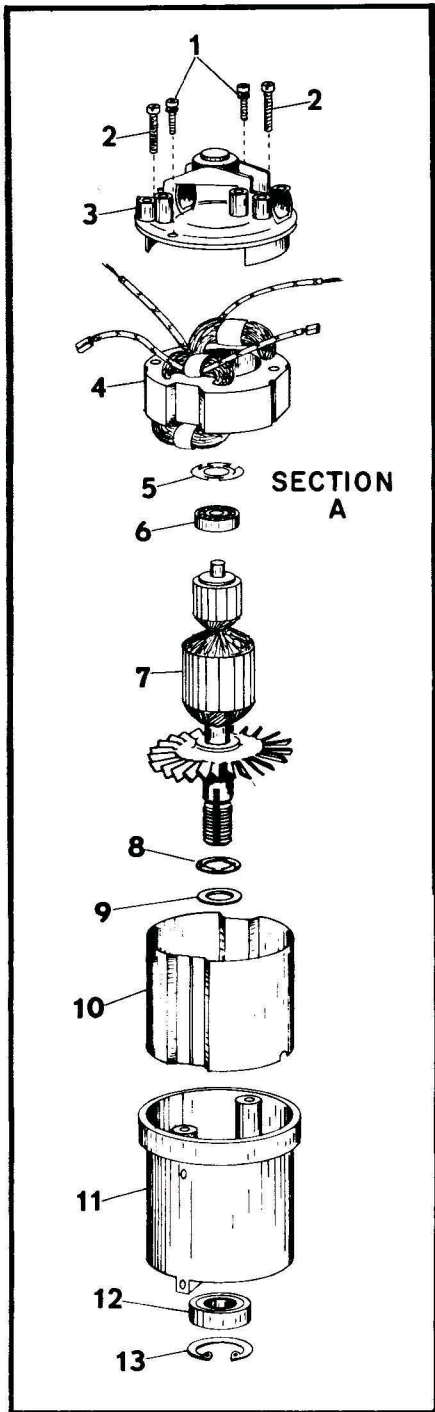

FOR PARTS LIST — SEE PAGE 7

# CRAFTSMAN ROUTER—MODEL NUMBER 315.17380

The Model Number will be found on a plate attached to the End Cap. Always mention the Model Number in all correspondence regarding your ROUTER or when ordering repair parts.

**SEE BACK PAGE FOR PARTS ORDERING INSTRUCTIONS**

## PARTS LIST

Key No.	Part No.	Description	Quan.	Key No.	Part No.	Description	Quan.
1	1-940038-804	Screw (#8-32 x 5/8 Fil. Hd.)	3	41	1-703428-10	*Screw (#8-32 x 3/8 Flat Hd.)	1
2	1-714096-807	Screw (#10-16 x 1 Fil. Hd.)	2	42	3-606532-01	Gear Rack	1
3	3-606904-04	Top Bearing Plate (Includes Key No. 63)	1	43	1-703428-25	*Screw (#8-32 x 1/2 Flat Hd.)	1
4	3-606529-02	Field Core Complete	1	44	2-624197-01	Brush Holder	2
5	1-621463-02	Loading Spring	1	45	2-624196-01	Brush Tube	2
6	1-740943-01	Ball Bearing (Hoover 7038L1AC2)	1	46	2-624203-02	Brush Assembly	2
7	2-606492-01	Armature Complete	1	47	1-624198-01	Brush Cap	2
8	1-623880-01	Retaining Ring	1	48	2-606512-02	Brush Holder Clamp	2
9	1-623881-01	Cupped Washer	1	49	1-616445-01	Screw (#8-32 x 5/8 Fil. Hd. T.C.)	4
10	3-606575-01	Field Insulating Sleeve	1	50	1-616287-01	Cord Clamping Plate	1
11	3-606484-03	Motor Housing	1	51	1-616445-04	Screw (#8-32 x 1/2 Fil. Hd. T.C.)	2
12	1-615972-01	Ball Bearing (Hoover 993LO3AC2)	1	52	1-606579-01	Bumper	1
13	1-912171-801	Retaining Ring	1	53	3-616185-01	Logoplate	1
14	1-623863-01	*Screw (#10-32 x 1/4 Pan Hd.)	3	54	1-795247-06	Drive Screw	4
15	3-606681-01	Sub-Base	1	55	4-606488-03	End Cap	1
16	1-703768-802	*Screw (#6-32 x 2 Rd. Hd.)	1	56	1-940038-805	Screw (#8-32 x 7/8 Fil. Hd.)	3
17	1-621721-03	Washer	1	57	2-607293-01	Dataplate	1
18	3-606535-01	Height Adjusting Knob— Right	1	58	2-614703-03	Cord	1
19	1-703473-32	Lock Washer	2	59	1-623813-03	Wrench	1
20	1-930517-11	*Screw (1/4-20 x 7/8 Rd. Hd.)	2	60	1-623173-01	Wire Connector (For #16 and/or #18 Wire)	3
21	1-622931-02	Screw (#6-32 x 1/4 Fil. Hd.)	2	61	2-613651-01	Bend Relief	1
22	3-607409-01	Height Indicator Cover	1	62	2-606583-01	Switch	1
23	1-623808-01	"O" Ring	2	63	1-615818-04	Pin	2
24	3-606533-01	Indicator Knob	1	64	1-607406-01	*Hex Nut (5/16-18)	1
25	1-623281-02	*Hex Nut (#6-32)	1	65	2-606580-01	Control Cable	1
26	3-606536-01	Height Adjusting Knob— Left	1	66	3-606576-01	Trigger	1
27	2-606534-01	Height Adjusting Pinion	1	67	1-606573-01	Spring	1
28	4-606468-03	Base	1	68	1-606588-02	Collar	1
29	2-606586-01	Handle Assembly	1	69	1-703769-05	*Screw (#4-40 x 1/4 Rd. Hd.)	1
30	1-623772-02	Retaining Ring	1	70	1-623281-01	*Hex Nut (#8-32)	4
31	1-606489-04	Collet Nut	1	71	1-726676-02	*Set Screw (#8-32 x 7/16 Hex Socket Headless)	2
32	1-606490-02	Collet	1	72	2-606508-03	Lock Knob	1
33	1-623795-02	Spacer	1	73	4-606566-02	Power Handle (Includes Key Nos. 77, 78 and 79)	1
34	1-623794-02	Jam Nut	1	74	4-606567-01	Power Handle Cover	1
35	1-706404-07	*Hex Nut (#8-32)	2	75	1-726693-01	Screw (#8-32 x 5/8 Fil. Hd.)	4
36	2-606525-01	Clamp Bar	1	76	2-606688-01	Eye Shield	1
37	1-623793-01	Lock Nut	1	77	1-606571-01	Lock Button	1
38	1-623797-01	Spring	1	78	1-606574-01	Spring	1
39	2-623796-02	Locking Lever	1	79	1-606572-01	Rivet	1
40	2-623804-01	Housing Skirt	1	80	1-931555-39	Lock Washer	1
					EN-704	Instruction Sheet	

"A"—Parts listed in this assembly are shown in the exploded view as Key Numbers 1 through 13 and represent an important part of the Double Insulated Safety System. To avoid the possibility of alteration or damage to the Safety System, service requiring these parts should be performed by a qualified service technician. Service required on these parts should be performed by your nearest Sears Electric Motor Shop. Contact your nearest Catalog Order House or Retail Store for servicing of any parts shown in Section "A".

\*Standard Hardware Item—May Be Purchased Locally

FOR ILLUSTRATION — SEE PAGE 6

# Sears

# owners manual



REG. TRADEMARK

## **ROUTER DOUBLE INSULATED**

**MODEL NO.  
315.17380**

**HOW TO ORDER  
REPAIR PARTS**

**SEARS SERVICE  
IS AT YOUR SERVICE  
WHEREVER YOU LIVE  
OR MOVE  
IN THE U.S.A.**

The Model Number will be found on the plate attached to the end cap. Always mention the Model Number when requesting service or repair parts for your Router.

All parts listed herein may be ordered through SEARS, ROEBUCK AND CO. and SIMPSONS-SEARS LIMITED. When ordering parts by mail, selling prices will be furnished on request or parts will be shipped at prevailing prices and you will be billed accordingly.

WHEN ORDERING REPAIR PARTS, ALWAYS GIVE THE FOLLOWING INFORMATION AS SHOWN IN THIS LIST.

1. The PART NUMBER
2. The PART DESCRIPTION
3. The MODEL NUMBER—315.17380
4. The NAME of ITEM—ROUTER

All fine tools, on occasion, may require service or the replacement of parts due to wear from normal use. To prolong the life of your tool when repairs are needed, call on your nearest Sears Catalog Order or Retail Store. Please do not risk possible electrical hazards, additional cost or damage to the tool through inexperienced repairs.

Your Sears merchandise takes on added value when you discover that Sears has over 2,000 Service Units throughout the country. Each is staffed by Sears — trained, professional technicians using Sears approved parts and methods.

SEARS, ROEBUCK AND CO.—Chicago, Illinois 60607 U.S.A.  
and SIMPSONS-SEARS LIMITED—Toronto