

**CHARACTERISTICS, INSTALLATION AND MAINTENANCE
INSTRUCTIONS WITH PARTS LIST FOR**

**CRAFTSMAN $\frac{1}{3}$ H.P.
Capacitor-Start Electric Bench Grinder**

115 Volts, 60 Cycles, 3450 R.P.M.

MODEL NUMBER 115.7397

This is the model number of your Craftsman grinder. It will be found on the nameplate attached to the grinder. Always mention this model number when communicating with us regarding your grinder or when ordering parts.

How To Order Repair Parts

All parts listed herein may be ordered through any Sears retail or mail order store. In ordering parts by mail from the mail order store which serves the territory in which you live, Selling Prices will be furnished on request or parts will be shipped at prevailing prices and you will be billed accordingly.

WHEN ORDERING REPAIR PARTS, ALWAYS GIVE THE FOLLOWING INFORMATION:

1. The Part Number in this List.
2. The Part Name in this List.
3. The Model Number of the grinder.

This information is valuable. It will assure your being able to obtain proper parts service. We suggest keeping it with other valuable papers.

SEARS, ROEBUCK AND CO.

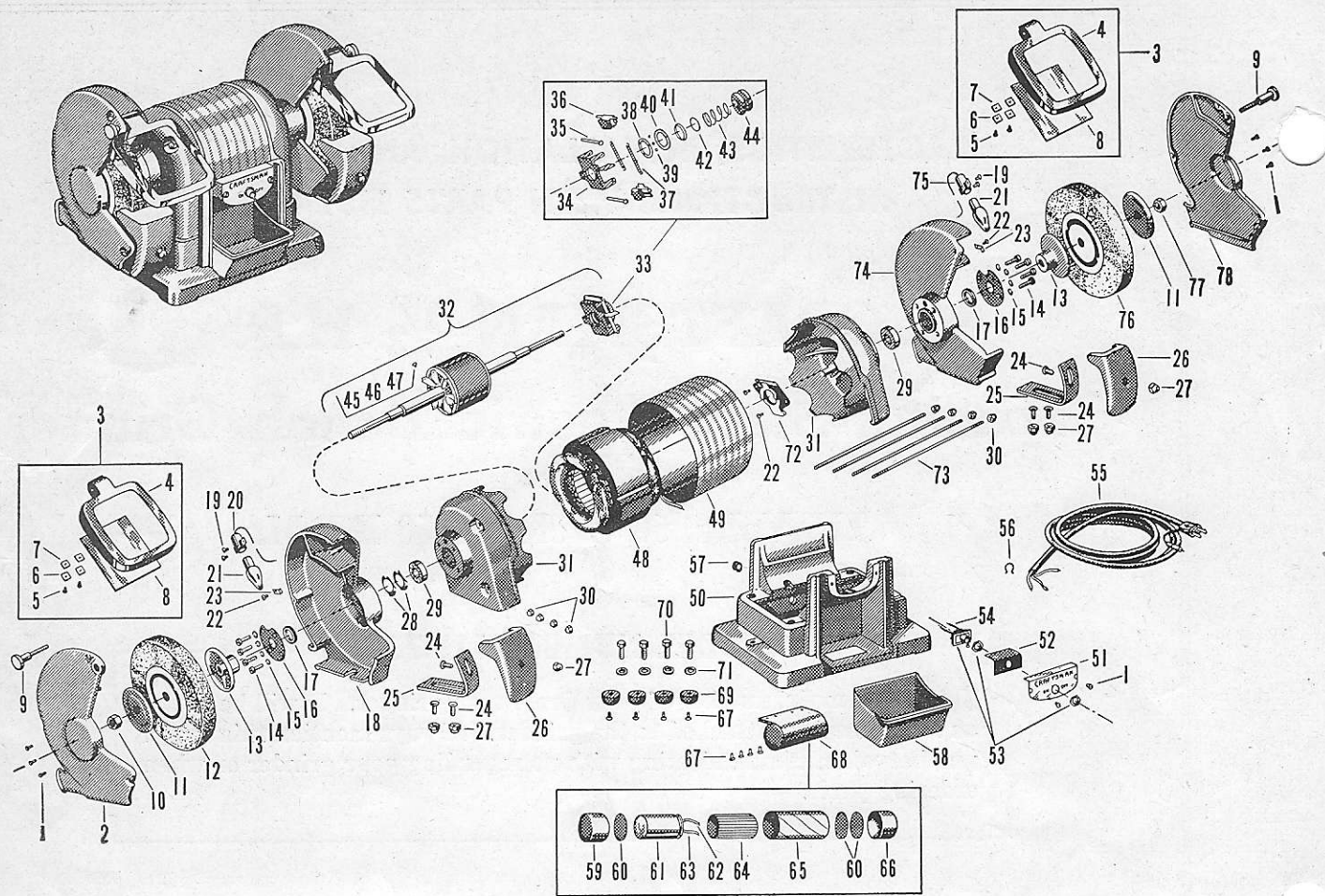

PARTS LIST MODEL 115.7397

Item	Part No.	DESCRIPTION	Item	Part No.	DESCRIPTION
* 1	5217830	Machine Screw—No. 8-32x5/16 Fillister Head	37	5200993	Governor Side Spring
2	5213714	Guard Cover (Left Hand)	38	5211988	Governor Bearing Ball Race
3	5213726	Eye Shield Assembly	39	114072	Governor Bearing Ball
4	5213716	Eye Shield Frame	40	5212249	Governor Washer
* 5	121839	Eye Shield Screw—No.6-32x5/16—Round Head	41	5211990	Governor Spring Cup
6	5213734	Eye Shield Clip	42	5212917	Governor Shaft Washer
7	5214934	Eye Shield Pad	43	5211992	Governor Spring
8	5207160	Eye Shield Glass	44	5211969	Governor Sleeve
* 9	5213718	Eye Shield Thumb Screw—No. 10-24x1-3/8 Round Head	45	5205726	Rotor Balancing Rivet (Heavy)
*10	125996	Shaft Nut (Left Hand)—No. 1/2-20 Hex.	46	5205727	Rotor Balancing Rivet (Medium)
11	5201084	Wheel Flange (Outer)	47	5205728	Rotor Balancing Rivet (Light)
12	5213727	Grinding Wheel (Coarse)	48	5214400	Stator & Coil Assembly
13	5207718	Wheel Flange (Inner)	49	5216887	Stator Cover Band
*14	114355	Machine Screw—No.1/4-20x3/4 Fillister Head	50	5213701	Base
15	120880	Lock Washer	51	5213733	Toggle Switch Plate
16	5213719	Felt Retainer	52	5213725	Toggle Switch Insulation
17	5205305	Bearing Felt	53	5211242	Toggle Switch Assembly
18	5213712	Guard (Left Hand Inner)	54	5216128	Toggle Switch Lead
*19	132756	Lamp Socket Assembly Screw—No. 8-32x7/16 Round Head	55	5216872	Cord Assembly
20	5217307	Lamp Socket Assembly (Left Hand)	56	5212523	Cord Strain Relief
21	5217306	Lamp	57	5216878	Cord Grommet
*22	116021	Machine Screw—No.8-32x1/4 Round Head	58	5213662	Water Pan
23	5213720	Cord Clip	59	5210073	Condenser Bottom Cap
*24	126216	Tool Rest Carriage Bolt—No. 5/16—18x3/4 Round Head	60	5205914	Condenser Insulation Disc
25	5213965	Tool Rest Bracket	61	5205231	Condenser
26	5213715	Tool Rest	62	5206510	Condenser Lead (Yellow)
*27	131469	Tool Rest Crown Nut—No. 5/16-18 Hex.	63	5201678	Condenser Lead (Black)
28	5201078	Bearing Spring	64	5211956	Condenser Tube
29	908502	Ball Bearing (New Departure)	65	5205911	Condenser Packing
30	5201073	Thru Bolt Nut	66	5205913	Condenser Top Cap
31	5213703	End Frame (Opposite Switch End—also switch end)	*67	117730	Machine Screw No. 10-24x3/8 Round Head
32	5216926	Rotor Assembly	68	5206059	Condenser Hanger
33	5212005	Governor Assembly	69	5205089	Base Foot
34	5212003	Governor Back	*70	100133	Base Bolt—No. 3/8—16x3/4 Hex. Head
35	5000221	Governor Hinge Pin	71	108530	Base Bolt Lock Washer
36	5211986	Governor Finger	72	5214963	Switch Assembly
			73	5215168	Thru Bolt
			74	5213708	Guard (Right Hand Inner)
			75	5217308	Lamp Socket Assembly (Right Hand)
			76	5213728	Grinding Wheel (Fine)
			*77	120371	Shaft Nut (Right Hand) No. 1/2—20 Hex.
			78	5213710	Guard Cover (Right Hand)

* Standard Hardware Items—May Be Purchased Locally

CHARACTERISTICS, INSTALLATION AND MAINTENANCE INSTRUCTION

CHARACTERISTICS

The NAMEPLATE of your grinder carries basic information regarding the characteristics that must be taken into consideration if you are to experience the dependable performance and long life that was designed and built into your grinder.

TYPE

This 1/3 H.P. Craftsman grinder is of the capacitor start type and is designed to develop 3450 R.P.M. no load speed. It is suitable for heavy-duty grinding and sharpening in any type of shop.

POWER SUPPLY REQUIRED

This grinder is designed to operate on a power supply with the following characteristics:

1. Volts—115 (at the grinder terminals)
2. Cycles or Frequency—60 (which is generally standard in the United States).

If you are not certain of your supply, inquire of your power company.

BEARINGS

This grinder is equipped with sealed ball bearings protected against dirt, dust, grindings and abrasive particles.

SPEED

3450 Revolutions per minute. It cannot be regulated.

INSTALLATION

PRE-MOUNTING CHECK

This grinder was tested and inspected for electrical and mechanical performance before being packed at the factory, but as a precautionary measure the following steps should be taken before running to make certain it has not been damaged in transit.

1. Rotate the shaft with your fingers. It should turn reasonably free and smoothly.
2. Plug the motor cord into a 115 volt, 60 cycle electrical outlet and move the switch in the "on" position. Operating normally, this motor will have a low electrical hum.

MOUNTING

Before tightening the mounting bolts, be certain all points of the grinder base are in contact with the mounting bracket on the bench. Otherwise, the base may be warped or cracked. Then tighten the grinder bolts securely. This grinder should be installed in as cool and dry a place as possible where it will be protected from excessive deposits of rust and dirt. It should not be confined to the extent that the free flow of air through and about it is restricted.

CIRCUIT

This grinder is not required to start under load and if it is not overloaded after starting, the standard 15 ampere lighting circuit fuses should be satisfactory. Otherwise, a delayed-action type fuse such as a "fustat" or "fusetron", which is designed to meet the demands of motor protection in addition to the demands of lighting circuit protection, should be used.

WIRE SIZE

The following wire sizes are recommended for extensions or special circuits from the source of power supply:

Length of Two-Conductor Extension	Wire Size Required (American Wire Gauge No.)
15 feet or less	No. 14
50 feet or less	No. 12
100 feet or less	No. 10

GROUNDING

As a precaution against the possibility of electrical shock from an internal ground in the grinder an external ground should be provided. This can be accomplished by running a wire from the frame to a water pipe, steam pipe, or any other metal object making direct contact with the earth. Good electrical contact can be established between the metal surfaces and ground lead by removing all paint and other foreign material from the surface of the metal at the point of connection.

MAINTENANCE

Installed as instructed, this grinder should give trouble-free service when properly lubricated, kept clean and supplied with power of the same rating as described on the grinder nameplate. (Usually 115 volts, 60 cycle).

LUBRICATION

Ball Bearings used in this grinder were lubricated for life at the factory.

CLEANING

No internal cleaning of grinder is required due to dust proof construction.

LOW VOLTAGE

Approximately 90% of all motor failures are the result of low voltage at the motor terminals or serious motor overloading. Although your motor is designed for operation on the voltage and frequency specified on the motor nameplate, normal loads can be handled safely on voltages that are not more than 10% above or below the rated voltage. However heavy loads require the specified voltage at the motor terminals.

Some Causes of Low Voltage are:

1. Overloaded circuits
2. Under-sized wires
3. Overloading power company's facilities

Some Effects of Low Voltage are:

1. Motor doesn't develop full power
2. Motor starts slowly
3. Motor overheats
4. Fuses blown frequently

SERVICE

Only qualified persons who have the proper tools and equipment should attempt to service this grinder. The Guarantee covering it is void if either end frame (Items 31) has been removed by anyone other than an Authorized Sears Service Station. External parts such as the cord (Item 55), Base (Item 50), and Stator Cover Band (Item 49) may be removed without voiding the Guarantee. The nearest Sears retail or mail order store will have your grinder serviced for you promptly at a reasonable rate.

GUARANTEE

This Craftsman grinder was thoroughly inspected and tested before shipment. Should it fail due to faulty material or workmanship, we will repair it free of charge if returned to your Sears retail or mail order store within one year from date of purchase. This guarantee is void if the grinder has been misused, abused, or disassembled.

SEARS, ROEBUCK AND CO.