

Tool # 9

1983

Sears

*Owner's
Manual*

**MODEL NO.
257.191601**

SERIAL
NO. 332600065

MODEL AND SERIAL
NUMBER MAY BE FOUND
ON THE NAMEPLATE
LOCATED ON THE
FRONT OF THE TOOL.

YOU SHOULD RECORD
BOTH MODEL AND
SERIAL NUMBER AND
RETAIN IN A SAFE
PLACE FOR FUTURE
USE.

DANGER —
For Your Own
Safety, Read
and Understand
this Manual
Before
Operating
Grinder.

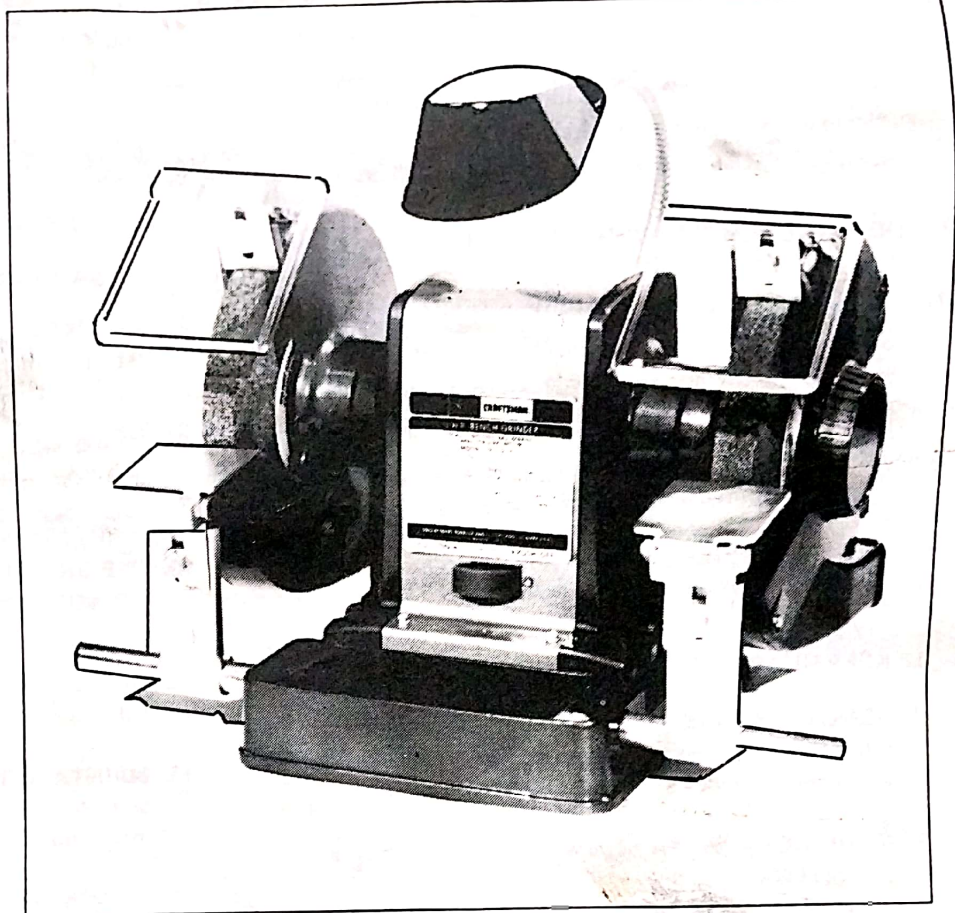

Sears

CRAFTSMAN®

1 H.P. BENCH GRINDER 8" WHEEL

3580 RPM, NO LOAD • 5/8" GRINDING WHEEL ARBOR
USE ONLY GRINDING WHEELS RATED AT 3600 RPM OR HIGHER

- Assembly
- Installation
- Operation
- Repair Parts

Sold by SEARS, ROEBUCK AND CO., Chicago, IL 60684, U.S.A.

RULES FOR SAFE OPERATION

Read instructions before using grinder

— FOR BENCH GRINDERS —

1. **EXAMINE GRINDING WHEELS FOR CRACKS** or other damage before operating.
REPLACE CRACKED WHEEL IMMEDIATELY.
2. **DO NOT OVER-TIGHTEN WHEEL NUTS.**
3. **USE ONLY WHEEL FLANGES FURNISHED WITH GRINDER.** Use of other flanges may cause damage or breakage to the grinding wheel and result in injury to the operator.
4. **MOUNT THE GRINDER SECURELY** to prevent damage. See "INSTALLATION" page.
5. **DO NOT FORCE WORK** against the grinding wheel! Excessive pressure may cause damage or breakage of the grinding wheel, resulting in injury to the operator or bystander.
6. **STOP GRINDER BEFORE MAKING ADJUSTMENTS.**
7. **ALWAYS USE GUARDS AND EYESHIELDS.**
8. **ADJUST DISTANCE BETWEEN WHEEL AND WORK REST** to maintain 1/16 inch or less separation as the diameter of the wheel decreases with use.
9. **READ ALL INSTRUCTIONS** pertaining to 115 volt and 230 volt operation before attempting to change connections.
10. **USE GRINDING WHEEL SUITABLE FOR SPEED OF GRINDER.**

— FOR ALL TOOLS —

1. **KEEP GUARDS IN PLACE** and in working order.
2. **REMOVE ADJUSTING KEYS AND WRENCHES.** Form habit of checking to see that keys and adjusting wrenches are removed from tool before turning it on.
3. **KEEP WORK AREA CLEAN.** Cluttered areas and benches invite accidents.
4. **DON'T USE IN DANGEROUS ENVIRONMENT.** Don't use power tools in damp or wet locations, or expose them to rain. Keep work area well lighted.
5. **KEEP CHILDREN AWAY.** All visitors should be kept a safe distance from work area.
6. **MAKE WORKSHOP KID-PROOF** with padlocks, master switches or by removing starter keys.
7. **DON'T FORCE TOOL.** It will do the job better and safer at the rate for which it was designed.
8. **USE RIGHT TOOL.** Don't force tool or attachment to do a job for which it was not designed.
9. **WEAR PROPER APPAREL.** No loose clothing, neckties, rings, bracelets or other jewelry to get caught in moving parts. Nonslip footwear is recommended. Wear protective hair covering to contain long hair.
10. **ALWAYS USE SAFETY GLASSES.** Also use face or dust mask if cutting operation is dusty. Everyday eyeglasses only have impact resistant lenses, they are **NOT** safety glasses.
11. **SECURE WORK.** Use clamps or a vise to hold work when practical. It's safer than using your hand and it frees both hands to operate tool.
12. **DON'T OVERREACH.** Keep proper footing and balance at all times.
13. **MAINTAIN TOOLS WITH CARE.** Keep tools sharp and clean for best and safest performance. Follow instructions for lubricating and changing accessories.
14. **DISCONNECT TOOLS** before servicing; when changing accessories such as blades, bits, cutters, etc.
15. **REDUCE THE RISK OF UNINTENTIONAL STARTING.** Make sure switch is in off position before plugging in.
16. **USE RECOMMENDED ACCESSORIES.** Consult the owner's manual for recommended accessories. The use of improper accessories may cause risk of injury to persons.
17. **NEVER STAND ON TOOL.** Serious injury could occur if the tool is tipped or if the cutting tool is unintentionally contacted.
18. **CHECK DAMAGED PARTS.** Before further use of the tool, a guard or other part that is damaged should be carefully checked to assure that it will operate properly and perform its intended function — check for alignment of moving parts, binding of moving parts, breaking of parts, mounting, and any other conditions that may affect its operation. A guard or other part that is damaged should be properly repaired or replaced.
19. **DIRECTION OF FEED.** Feed work into a blade or cutter against the direction of rotation of the blade or cutter only.
20. **NEVER LEAVE TOOL RUNNING UNATTENDED.**



power tool institute, inc.

FULL ONE-YEAR WARRANTY ON CRAFTSMAN BENCH GRINDER

If this Craftsman Bench Grinder fails to give complete satisfaction within one year from the date of purchase, RETURN IT TO THE NEAREST SEARS STORE IN THE UNITED STATES and Sears will replace it, free of charge.

This warranty applies only while this product is in use in the United States.

This warranty gives you specific legal rights, and you may also have other rights which vary from state to state.

SEARS, ROEBUCK AND CO., Dept. 698/731A, Sears Tower, Chicago, IL 60684

BOX CONTENTS

THIS BOX SHOULD CONTAIN:

- 1 257.191601 H.P. Bench Grinder
- 1 Base
- 1 Wheel Cover (L.H.)
- 1 Wheel Cover (R.H.)
- 1 Loose parts kit containing:
 - 1 Ea. Lampshade
 - 1 Ea. Lampshade Cover
 - 6 Ea. Nuts Hex 5/16-18
 - 8 Ea. Screws 1/4-20 x 1/2 Hex Hd.
 - 1 Ea. Screw 8-32 x 1/4 Pan Hd.
 - 1 Ea. Eyeshield Pack Containing:
 - 2 Ea. Eyeshields
 - 2 Ea. Wing Nuts 1/4-20 Thd.
 - 2 Ea. Bolts 1/4-20 x 2-1/4 Hex Hd.

- 2 Ea. Shafts
- 2 Ea. Tool Rests
- 2 Ea. Lower Tool Rest Arms
- 2 Ea. Upper Tool Rest Arms
- 4 Ea. Screws 10-32 x 1/2
- 4 Ea. Washers 3/16 I.D.
- 2 Ea. Screws 5/16-18 x 1/4
- 2 Ea. Bolts 5/16-18 x 3/4
- 1 Ea. Spark Arrester pack containing:
 - 2 Ea. Bolts 5/16-18 x 3/8 Hex Hd.
 - 4 Ea. Washers 5/16
 - 2 Ea. Spark Arresters
- 2 Ea. Bolts 5/16-18 x 1
- 2 Ea. Bolts 5/16-18 x 2-1/4
- 4 Ea. Foot and Screw Assys.
- 4 Ea. Washers, Spacers (Accessory)
- 1 Ea. Owner's Manual

TOOLS NEEDED FOR ASSEMBLY

- Medium Blade Screwdriver
- 7/16 Wrench or Socket

Remove grinder from carton and examine it thoroughly to make sure it is not damaged.

CUSTOMER'S RESPONSIBILITIES

This grinder will start and operate on a 115 volt electrical circuit with a 15 ampere "Delayed Action" fuse. It may also be wired for 230 volt operation (see subsequent paragraphs.)

WARNING: MAKE SURE RECEPTACLE BOX IS PROPERLY GROUNDED. OPERATION WITHOUT GROUNDING CAN CAUSE SERIOUS ELECTRICAL SHOCK WHICH MIGHT BE FATAL.

GROUNDING INSTRUCTIONS

In the event of a malfunction or breakdown, grounding provides a path of least resistance for electrical current to reduce the risk of electric shock. This tool is equipped with an electric cord having an equipment-grounding conductor and a ground plug. The plug must be plugged into a matching outlet that is properly installed and grounded in accordance with all local codes and ordinances.

For 115 volt operation use the plug provided. For 230 volt operation use the type plug shown in figure 5. If it will not fit the outlet, have the proper outlet installed by a qualified electrician.

Improper connection of the equipment-grounding conductor can result in a risk of electric shock. The conductor with insulation having an outer surface that is green with or without yellow stripes is the equipment-grounding conductor. If repair or replacement of the electric cord or plug is necessary, do not connect the equipment-grounding conductor to a live terminal.

Check with a qualified electrician or serviceman if the grounding instructions are not completely understood, or if in doubt as to whether the tool is properly grounded.

CUSTOMER'S RESPONSIBILITIES - CONT'D

If necessary to use an extension, use only 3-wire cords which have 3-prong grounding type plugs and 3-pole receptacles which accept the tool's plug. The following chart of lengths and wire sizes are recommended for 115 volt operation only.

Length of Extension	Wire Size Required (American Wire Gauge No.)
15 feet or less	No. 16
50 feet or less	No. 14
100 feet or less	No. 12

Repair or replace damaged or worn cord immediately.

115 VOLT OPERATION

This grinder is equipped with an approved three-conductor cord and a three-prong grounding type plug and it is intended for use on a grounded outlet circuit. The proper plug and outlet box for 115 volt operation are illustrated in figure 1.

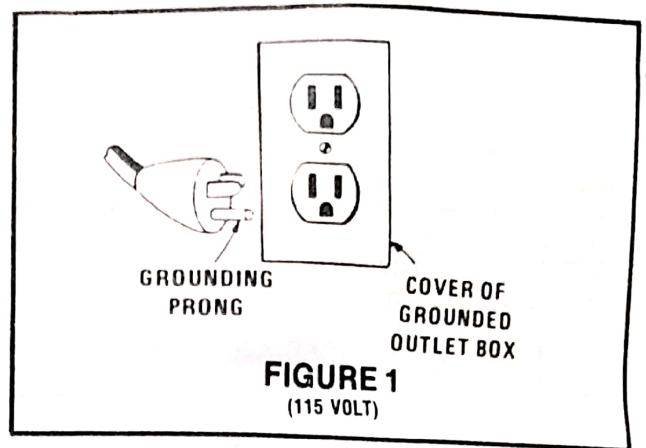

A temporary adapter, as illustrated in figure 2, may be used to connect this plug to a 2-pole receptacle as shown in figure 3, if a properly grounded outlet is not available. THE TEMPORARY ADAPTER SHOULD BE USED ONLY UNTIL A PROPERLY GROUNDED OUTLET CAN BE INSTALLED BY A QUALIFIED ELECTRICIAN. The green-colored rigid ear, lug, etc. extending from the adapter MUST BE CONNECTED TO A PERMANENT GROUND such as a properly grounded outlet box.

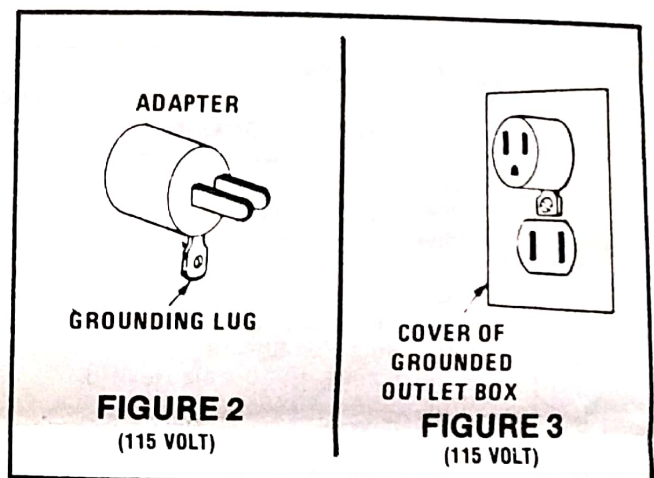

230 VOLT (SINGLE PHASE) OPERATION:

WARNING: BEFORE CHANGING WIRING CONNECTIONS, READ INSTRUCTIONS REGARDING 115 VOLT AND 230 VOLT OPERATION. WRONG CONNECTIONS WILL DAMAGE MOTOR WINDINGS.

To prepare grinder for 230 volt operation, the following 5 steps must be taken:

1. Disconnect from power supply.
2. Remove cover from bottom of grinder. Read all instructions before electrical connections are changed.
3. Study diagram (figure 4) and make changes as directed to revise internal connection for 230 volt operation.
4. Replace cover on bottom of grinder.

Connection can be made to a 15 amp, 230 volt branch circuit receptacle as follows:

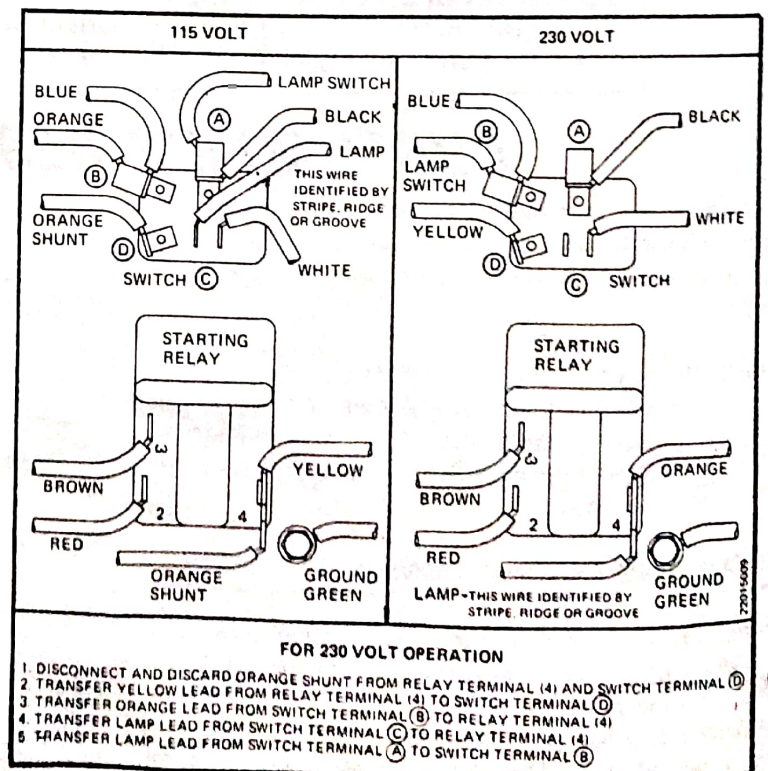

FIGURE 4

CUSTOMER'S RESPONSIBILITIES - CONT'D

Cut off the plug cap attached to the cable (it is for 115 volt connections only). Obtain a 2 pole 3 wire grounding type plug cap rated 15 amp, 250 volt (see figure 5 - note arrangement of blades) and connect black and white wires to blade terminals.

WARNING:

THIS TOOL SHOULD BE GROUNDED WHILE IN USE TO PROTECT THE OPERATOR FROM ELECTRIC SHOCK.

BE SURE TO CONNECT GREEN WIRE FROM CABLE TO GREEN SCREW TERMINAL IN ATTACHMENT PLUG CAP FOR PROPER GROUND. IMPROPER GROUNDING CAN CAUSE SERIOUS ELECTRICAL SHOCKS WHICH MIGHT BE FATAL.

No adapter is available for 230 volt plugs (figure 5).

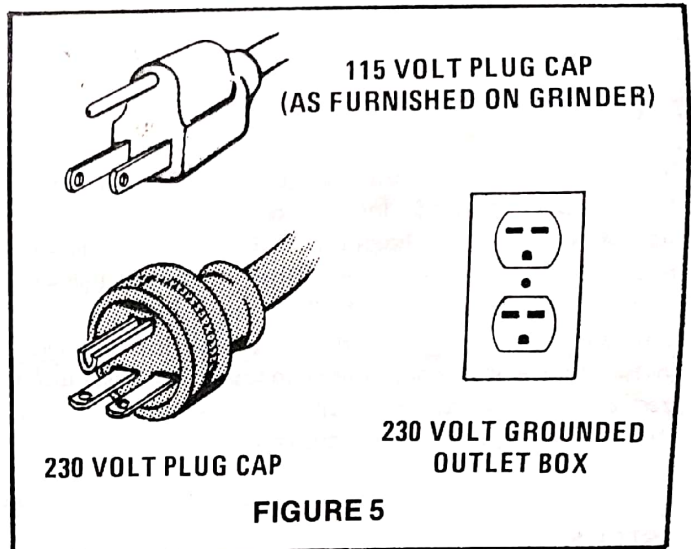

THE OPERATION OF ANY GRINDER CAN RESULT IN FOREIGN OBJECTS BEING THROWN INTO THE EYES, WHICH CAN RESULT IN SEVERE EYE DAMAGE. ALWAYS WEAR SAFETY GLASSES OR EYE SHIELDS BEFORE COMMENCING POWER TOOL OPERATION. WE RECOMMEND WIDE VISION SAFETY MASK FOR OVER SPECTACLES OR STANDARD SAFETY GLASSES. AVAILABLE AT SEARS RETAIL OR CATALOG STORES.

ASSEMBLY

INSPECT GRINDING WHEELS FOR DAMAGE BEFORE USING.

STEP 1

Attach wheel covers to wheel guards using eight screws furnished. See Figure 6.

STEP 2

Attach spark arresters to top front of wheel guards using flat washers and bolts—(5/16-18 x 3/8). Adjust spark arresters to 1/16-inch from wheel and tighten bolts. See Figure 6.

STEP 3

Fasten eyeshield to top of wheel guards using bolts—(1/4-20 x 2 1/4) and wing nuts. See Figure 6.

STEP 4

Install four foot and screw assemblies in bottom of base furnished with your grinder. Mount grinder onto base using four screws and washers. See Figure 7.

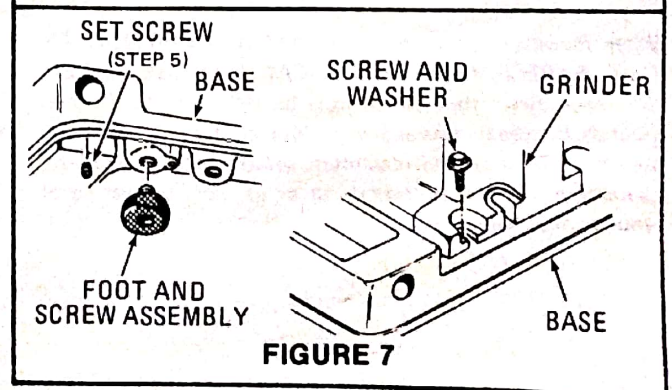
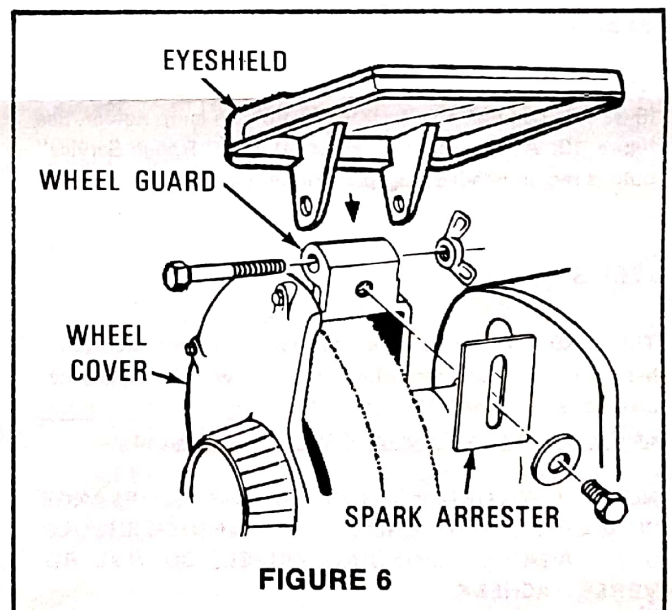

ASSEMBLY-CONT'D

STEP 5

Remove parts from tool rest package and assemble to grinder as shown in figure 8. Insert a tool rest shaft into each side of grinder base in holes provided and retain using set screws. Install set screws from bottom of base and tighten against flat in tool rest shaft. Slide lower tool rest arms onto shafts and clamp vertically using mounting bolts and nuts. Attach upper tool rest arms to top hole of lower tool rest arms using bolts, washers and nuts. Assemble tool rests to upper tool rest arms using bolts and nuts.

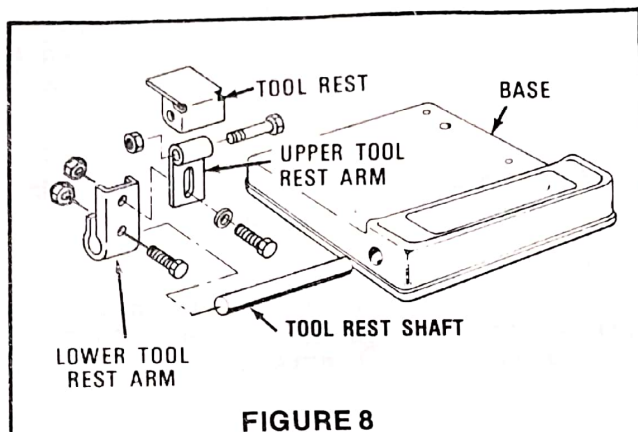

STEP 6

Adjust the tool rest so that the material to be ground will contact the wheel slightly above center-line of shaft at the desired angle, as shown in figure 9. The tool rests should be positioned securely so that a clearance of approximately 1/16 inch can be maintained between wheel and tool rests.

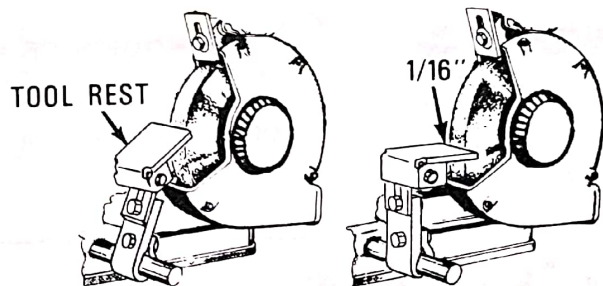

STEP 7

Assemble lamp shade cover to metal lamp shade with screw (8-32 x 1/4 pan hd). Clamp this assembly to lamp holder. See figure 10. A 40 watt regular or 50 watt "Rough Service" bulb is recommended for your grinder lamp.

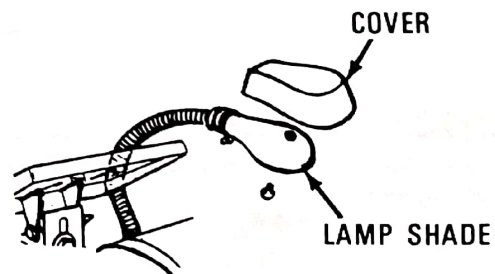

STEP 8

The illustration shows how the washer spacers are assembled to your grinder when buffing wheels and other accessories are used. See figure 11. Spacer washers are not used or required with standard grinding wheels.

NOTE THE ORIENTATION OF WHEEL FLANGE WASHERS. LARGE DIAMETER OF WASHER SHOULD BEAR AGAINST GRINDING WHEEL. DO NOT REVERSE WASHERS.

When mounting grinding wheels DO NOT OVERTIGHTEN NUT. EXCESSIVE PRESSURE CAN DAMAGE WHEEL. We recommend that wheel nuts be tightened to 75 inch pounds. Be sure flanges and wheel blotters are free of foreign particles. Be sure the maximum speed rating of your replacement wheel corresponds to or exceeds the rating of your grinder nameplate.

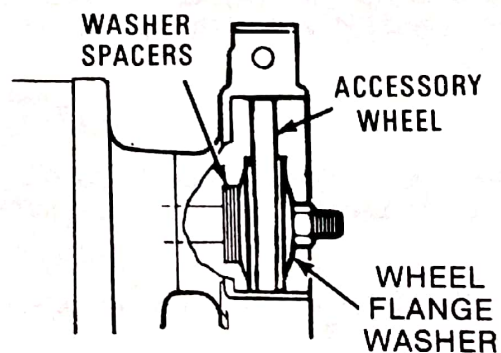

INSTALLATION

Grinder must be mounted on horizontal surface.

The Craftsman grinder pedestal available at Sears retail or catalog store is designed specifically for your grinder. Use of the pedestal will permit greater accessibility to your unit for grinding, buffing and many other uses.

To mount your grinder to the pedestal, align tapped holes in base with corresponding holes in table of the pedestal. Use two 5/16"-18 x 1-7/8" bolts (with flat washers beneath the heads) to secure the grinder. See figure 12.

A Craftsman workbench provides a good mounting for your grinder.

To mount your grinder to the bench top use four 1/4 wood screws. 3-1/2 inches long with flat washers beneath the heads. See figure 13.

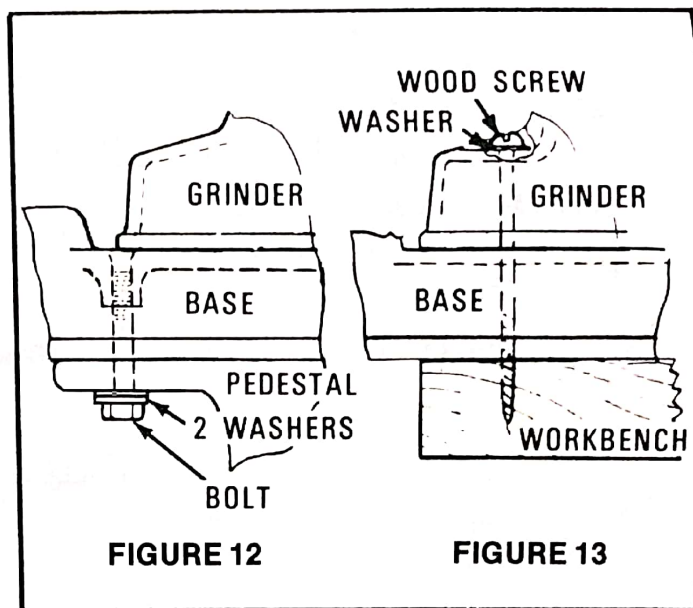

OPERATION

1. **WARNING:**

BE SAFE! PROTECT YOUR EYES, WEAR APPROVED SAFETY GOGGLES WHICH COMPLY WITH ANSI Z87.1-1968, AND ASSEMBLE EYE SHIELDS FURNISHED WITH YOUR GRINDER. STAND AWAY FROM FRONT OF GRINDER DURING FIRST MINUTE OF OPERATION.

THE OPERATION OF ANY POWER TOOL CAN RESULT IN FOREIGN OBJECTS BEING THROWN INTO THE EYES, WHICH CAN RESULT IN SEVERE EYE DAMAGE. ALWAYS WEAR SAFETY GOGGLES BEFORE COMMENCING POWER TOOL OPERATION.

2. To start, move switch to "ON" position. If grinder does not start immediately, disconnect power and check for voltage at power source.

3. **WARNING:**

DO NOT GRIND ON SIDE OF WHEEL!
DO NOT FORCE WORK AGAINST THE GRINDING WHEEL! EXCESSIVE PRESSURE MAY CAUSE DAMAGE OR BREAKAGE OF THE GRINDING WHEEL, RESULTING IN INJURY TO THE OPERATOR OR BYSTANDER.

SEE CUSTOMER'S RESPONSIBILITIES ON PAGE 3

CRAFTSMAN I.H.P GRINDER — MODEL NUMBER 257.191601

REPAIR PARTS

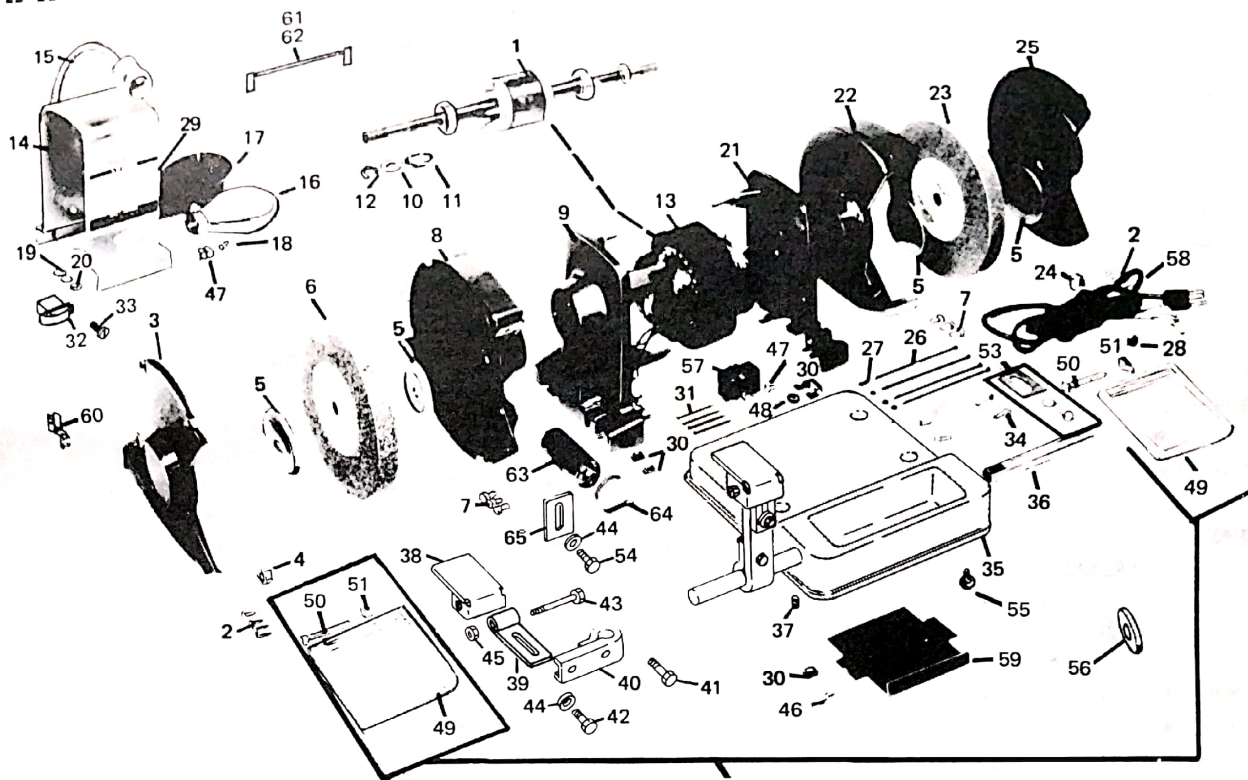

Key Part No.	Part Name	Qty.	Key Part No.	Part Name	Qty.
1	22013261 Rotor, Shaft and Bearing Assembly	1	36	5219087 Tool Rest Shaft	2
2	9437383 *Screw, 8-32 x 1/16 Hex Hd Self Tap	8	37	STD503102 *Set Screw—(5/16-18)	2
3	4376-0-16 Cover Guard (L.H.)	1	38	22005398 Tool Rest Table	2
4	192461 Nut, 5/8-18 (L.H. Thread)	1	39	4374-0-16 Tool Rest Arm (Upper)	2
5	22001525 Wheel Flange	4	40	4373-0-16 Tool Rest Arm (Lower)	2
6	964236 *Grinding Wheel 8"x1" (Coarse-36 Grit)	1	41	STD523110 *Bolt (Lower Arm) 5/16-18x1)	2
7	4505 *Screw, 1/4-20 x 5/8 Hex Hd Self Tap	6	42	STD523107 *Bolt (Upper Arm) 5/16-18x3/4)	2
8	4370-0-16 Wheel Guard, Inner (L.H.)	1	43	STD523122 *Bolt (Tool Rest) 5/16-18x2-1/4)	2
9	4686-0-16 End Frame (L.H.)	1	44	STD551031 *Washer, 5/16 Flat	6
10	3167424 Felt Washer	2	45	STD541031 Nut 5/16-18	6
11	5211995 Ball Bearing Spring	2	46	22014035 *Screw, 8-15x1/2 Hex Head Self Tap	5
12	9418441 Retaining Ring	2	47	STD600803 *Screw, 8-32x3/8 Hex Head Self Tap	3
13	22013885 Stator and Coil Assembly	1	48	STD551108 *Lockwasher, No. 8 (Ground Screw)	1
14	4342-0-19 Band	1	49	491778 Eyeshield	2
15	4978189 Lamp Assembly	1	50	STD522522 *Bolt, 1/4-20x2-1/4 Hex Head	2
16	4971959 Lamp Shade—Metal	1	51	STD541625 *Wing Nut, 1/4-20 Thread	2
17	4971958 Cover—Lamp Shade Plastic	1	52	4998798 Eyeshield Package (2 each)	1
18	STD600802 Screw, 8-32 x 1/4 Pan Head Self Tap	1	53	5538409 Spark Arrester Pack (2 each)	1
19	STD551237 *Lockwasher, 3/8 Internal	2	54	121817 *Bolt, 5/16-18 x 3/8 Hex Head	2
20	5219097 *Nut—1/8-27 Pipe Thd	1	55	5219033 Foot and Screw Assembly	4
21	4686-1-16 End Frame (R.H.) Córdoba	1	56	STD551062 *Spacer—(Accessory) 5/8 I.D. Washer	4
22	4369-0-16 Wheel Guard—Inner (R.H.)	1	57	22013279 Starting Relay	1
23	964355 *Grinding Wheel (Fine—60 Grit)	1	58	4978534 Power Cord	1
24	STD541562 *Nut 5/8-18 Hex	1	59	22015010 Cover and Decal Assy.	1
25	4375-0-16 Cover Guard (R.H.)	1	60	4945969 Adaptor	1
26	4971779 Thru Bolt, 10-32 Thread	4	61	5558855 Lead (Red)	1
27	STD541110 *Nut, 10-32 Thread	4	62	4957357 Lead (Orange)	1
28	3169206 Strain Relief	1	63	5539080 Capacitor	1
29	4283-1 Name Plate	1	64	5373379 Clamp	1
30	3161432 Spring Clip	5	65	3175504 Spark Arrester	2
31	9437509 *Screw, 8-32 x 2-1/4 Hex Hd Self Tap	4	66	4398 Washer 3/16 I.D.	4
32	4986704 Switch	1	67	88-384-01 Owner's Manual	1
33	STD510602 Screw, 6-32x1/4 Pan Hd	2			
34	4397 Screw, 10-32x1/2 Self Tap	4			
35	4352-0-18 Base	1			

*Standard hardware items—May be purchased locally.

CRAFTSMAN I.H.P GRINDER — MODEL NUMBER 257.191601

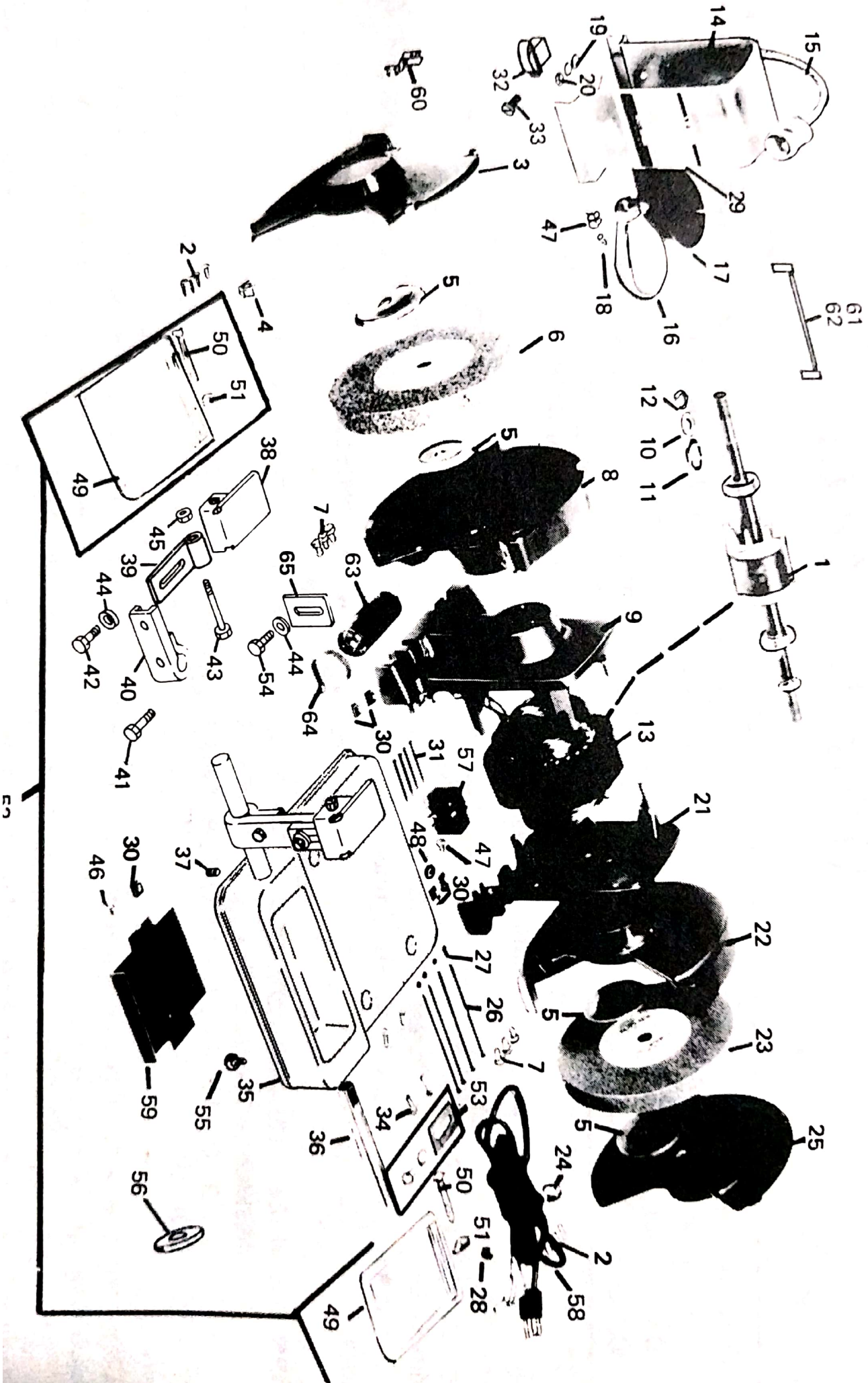

MAINTENANCE

- Replace cracked wheel immediately.
- Always use guards and eye shields.
- Do not overtighten wheel nut.
- Use only flanges furnished with this grinder.

1. When vitrified wheels become irregular or glazed from use, they may be trued and cleaned, returning them to near-new condition with the cutting face fresh and square. Use a Sears wheel dresser to keep your wheels in good condition. Available at Sears retail stores or through catalog.

WARNING: WHEEL GUARD AND COVER MUST BE ASSEMBLED WHEN WHEEL DRESSER IS USED TO PROTECT OPERATOR FROM INJURY.

2. Clean out any accumulation of cuttings and abrasive each time outer wheel cover is removed.
3. Keep spark arrester and tool rest adjusted to within 1/16 inch from wheel. When grinding wheel has worn to a point where 1/16 inch adjustment can not be maintained, replace wheel with new 8 inch diameter wheel. See step 2 and 6 (figure 6 and 9)

4. Replace grinding wheel when diameter has been reduced 1" through wear. Undersize wheels are a hazard to operator safety as proper spark arrester and tool rest adjustments cannot be maintained with undersize wheels. Replacement wheels are available at Sears retail or catalog stores.

5. Examine replacement grinding wheel for cracks or other damage before assembling to spindle.

6. **WHEEL WOBBLE.** This Bench Grinder has been inspected for excessive wheel wobble. However, it is inherent in this type of tool to have some wheel wobble due to manufacturing variations in the parts. Wheel wobble has no effect on grinding ability since grinding is only done on the outside diameter and not on the sides. Before trying to reduce wheel wobble make sure it is actually wheel wobble and not an optical illusion caused by the wheel blotter. Wheel wobble may be reduced by rotating the wheel flange and/or the grinding wheel 1/2 turn and then re-tightening the nut.

7. Lubrication was provided at the factory for the life of the ball bearings.

BE SAFE—OBSERVE ALL THE RULES FOR SAFE OPERATION !

FOLD OUT FOR PAGES 7 & 8

INSTALLATION

Grinder must be mounted on horizontal surface.

The Craftsman grinder pedestal available at Sears retail or catalog store is designed specifically for your grinder. Use of the pedestal will permit greater accessibility to your unit for grinding, buffing and many other uses.

To mount your grinder to the pedestal, align tapped holes in base with corresponding holes in table of the pedestal. Use two 5/16"-18 x 1-7/8" bolts (with flat washers beneath the heads) to secure the grinder. See figure 12.

A Craftsman workbench provides a good mounting for your grinder.

To mount your grinder to the bench top use four 1/4 wood screws. 3-1/2 inches long with flat washers beneath the heads. See figure 13.

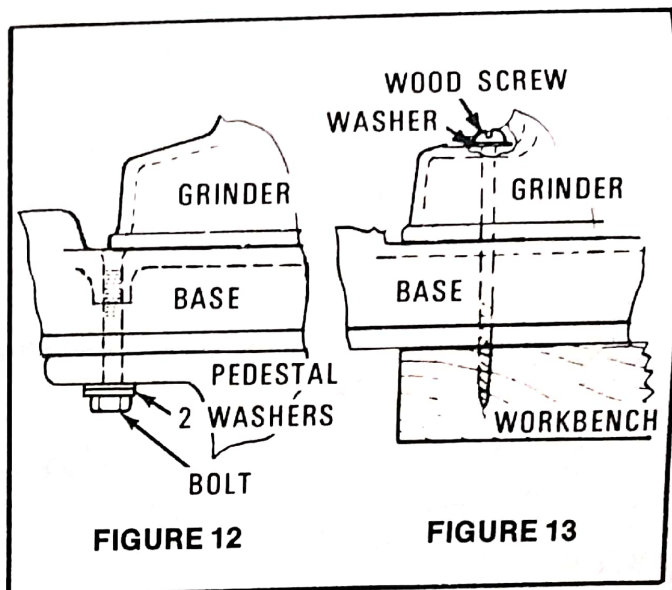

OPERATION

1. **WARNING:**
BE SAFE! PROTECT YOUR EYES, WEAR APPROVED SAFETY GOGGLES WHICH COMPLY WITH ANSI Z87.1-1968, AND ASSEMBLE EYE SHIELDS FURNISHED WITH YOUR GRINDER. STAND AWAY FROM FRONT OF GRINDER DURING FIRST MINUTE OF OPERATION.

THE OPERATION OF ANY POWER TOOL CAN RESULT IN FOREIGN OBJECTS BEING THROWN INTO THE EYES, WHICH CAN RESULT IN SEVERE EYE DAMAGE. ALWAYS WEAR SAFETY GOGGLES BEFORE COMMENCING POWER TOOL OPERATION.

2. To start, move switch to "ON" position. If grinder does not start immediately, disconnect power and check for voltage at power source.

3. **WARNING:**
DO NOT GRIND ON SIDE OF WHEEL!
DO NOT FORCE WORK AGAINST THE GRINDING WHEEL! EXCESSIVE PRESSURE MAY CAUSE DAMAGE OR BREAKAGE OF THE GRINDING WHEEL, RESULTING IN INJURY TO THE OPERATOR OR BYSTANDER.

SEE CUSTOMER'S RESPONSIBILITIES ON PAGE 3

Sears

***Owner's
Manual***

**MODEL NO.
257.191601**

**Sears
SERVICE
is at
YOUR
SERVICE**

How to Order Repair Parts

The Model Number will be found on the nameplate attached to the front of your grinder. Always mention the Model Number when requesting service or repair parts for your Craftsman Grinder.

All parts listed herein may be ordered from any SEARS, ROEBUCK AND CO. or SIMPSONS-SEARS LIMITED retail or catalog store.

WHEN ORDERING REPAIR PARTS, ALWAYS GIVE THE FOLLOWING INFORMATION.

1. PART NUMBER
2. PART DESCRIPTION
3. MODEL NUMBER—257.191601
4. NAME OF ITEM—BENCH GRINDER

USE ONLY SEARS REPLACEMENT PARTS.

If the parts you need are not stocked locally, your order will be electronically transmitted to a Sears Repair Parts Distribution Center for expedited handling.

Your Sears merchandise has added value when you consider that Sears has service units staffed with Sears trained technicians . . . professional technicians specifically trained on Sears products, having the parts, tools and equipment to insure that we meet our pledge to you . . . we service what we sell.

Sold by SEARS, ROEBUCK AND CO., Chicago, IL 60684, U.S.A.