

**CHARACTERISTICS, INSTALLATION AND MAINTENANCE  
INSTRUCTIONS WITH PARTS LIST FOR**

**CRAFTSMAN  $\frac{1}{4}$  H.P.  
Split-Phase Electric Bench Grinder**

**115 Volts, 60 Cycles, 3450 R.P.M.**

**MODEL NUMBER 115.19500**

This is the model number of your Craftsman grinder. It will be found on the nameplate attached to the grinder. Always mention this model number when communicating with us regarding your grinder or when ordering parts.

**How To Order Repair Parts**

All parts listed herein may be ordered through any Sears retail or mail order store. In ordering parts by mail from the mail order store which serves the territory in which you live, Selling Prices will be furnished on request or parts will be shipped at prevailing prices and you will be billed accordingly.

**WHEN ORDERING REPAIR PARTS, ALWAYS GIVE THE FOLLOWING INFORMATION:**

1. The Part Number in this List.
2. The Part Name in this List.
3. The Model Number of the grinder.

This information is valuable. It will assure your being able to obtain proper parts service. We suggest keeping it with other valuable papers.

**SEARS, ROEBUCK AND CO. - - - U. S. A.  
AND SIMPSONS - SEARS, LTD. - CANADA**

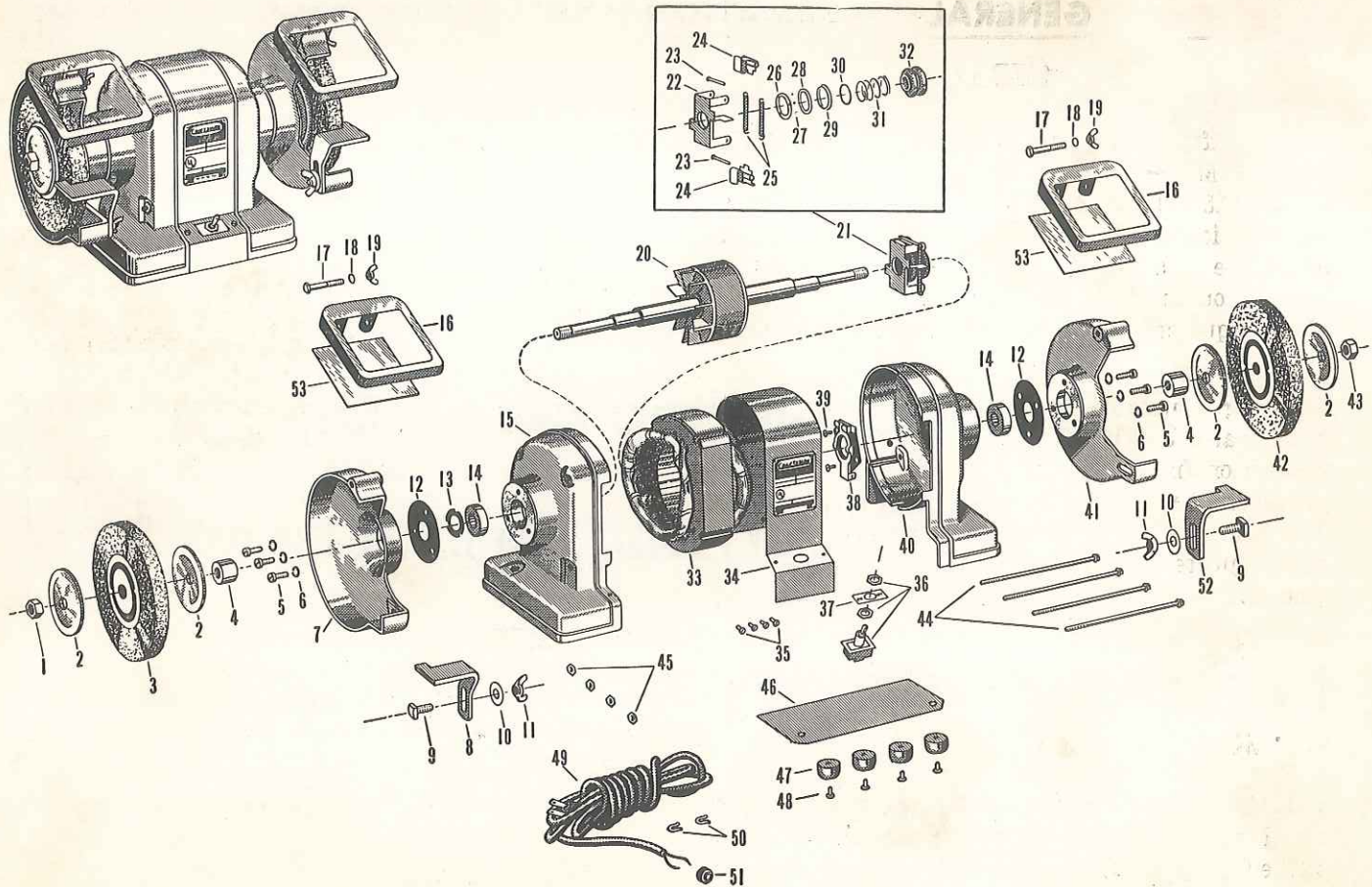

## PARTS LIST      Model 115.19500

Key No.	Part No.	Description	Key No.	Part No.	Description
* 1	125996	1/2-20 Left Hand Thread Hex Nut	29	5211990	Governor Spring Cup
2	5218554	Wheel Flange	30	5212917	Governor Spring Cup Washer
* 3	5201093	Grinding Wheel (Coarse) 6"x3/4"	31	5211992	Sliding Sleeve Spring
4	5218556	Wheel Spacer	32	5211969	Sliding Sleeve
* 5	132264	1/4-20x3/4 Fillester Head Screw	33	5218644	Stator Assembly
* 6	121637	1/4 Light Spring Lockwasher	34	5218645	Stator Cover Band
7	5218651	Wheel Guard (Left Hand)	*35	435885	# 6-32x5/16 Pan Head Slotted Machine Screw
8	5218559	Tool Rest (Left Hand)	36	5214281	Toggle Switch Assembly
* 9	149535	5/16-18x3/4 Square Head Bolt	37	5213741	Toggle Switch Assembly Plate
*10	120387	5/16 Flat Steel Washer	38	5218663	Starting Switch Assembly
*11	142745	5/16-18 Wing Nut	*39	5216591	# 8-32x5/16 Round Head Machine Screw
12	5218563	End Cap	40	5218655	End Frame (Right Hand)
13	5201078	Ball Bearing Spring	41	5218648	Wheel Guard (Right Hand)
14	954832	Ball Bearing	*42	5201092	Grinding Wheel (Fine) 6"x3/4"
15	5218658	End Frame (Left Hand)	*43	120371	1/2-20 Hex Nut
16	5218638	Eye Shield Frame Assembly	44	5218767	Hood Bolt
*17	121947	1/4-20x1-7/8 Bolt	45	111101	Hood Bolt Nut
18	5218640	Washer	46	5218915	Base Inclosure
*19	126177	1/4-20 Wing Nut	47	5205089	Rubber Foot
20	5218660	Rotor Assembly	48	117730	# 10-24x3/8 Round Head Machine Screw
21	5218633	Governor Assembly	49	5218639	Cord Assembly
22	5212003	Governor Back	50	044617	Cord Strain Relief
23	5000221	Governor Hinge Pins	51	5216376	Cord Grommet
24	5213643	Governor Fingers	52	5218558	Tool Rest (Right Hand)
25	5218176	Governor Side Springs	53	5218630	Eye Shield Glass
26	5213090	Governor Washer		5218984	Instructions & Parts List
27	114072	Governor Ball Bearing			
28	5211988	Governor Ball Bearing Race			

\* Standard Hardware Items—May Be Purchased Locally

# GENERAL INFORMATION AND INSTRUCTIONS

## GENERAL

Your Craftsman grinder is powered by a 1/4 HP, 3450 RPM split phase motor designed to operate on 115 volts 60 cycle single phase power. This information can be found on the nameplate fastened on the front of the motor housing. Be sure the power you intend to use agrees with the nameplate requirements before attempting to operate your grinder.

For long trouble free life your grinder is equipped with sealed ball bearings and totally enclosed for protection from dust, dirt, grindings and abrasive particles. It is suitable for use in any type of shop. The wheels of your grinder are shielded for maximum protection to the operator and to the wheels.

## INSTALLATION

### PRE-MOUNTING CHECK

This grinder was tested and inspected for electrical and mechanical performance before being packed at the factory, but as a precautionary measure the following steps should be taken before running to make certain it has not been damaged in transit.

1. Remove the shaft nut and wheel flange (Key Nos. 1, 2, and 43) and inspect the grinder wheels for possible fractures. Make sure the shaft nuts (Key Nos. 1 and 43) are secure. (If there is any doubt as to the condition of the grinding wheels remove them from the shaft, support each separately through the bore on a loosely fitting spindle, rod, or dowel. Strike the edge of the wheel lightly with a metal object. **The wheel should ring.** A dull sound indicates a fracture and the wheel should be replaced immediately.)
2. Rotate the shaft with your fingers. It should turn reasonably free and smoothly.
3. Plug the motor into a 115 volt 60 cycle electrical outlet and move the switch to the "on" position. Operating normally, this motor will have a low electrical hum.

### MOUNTING

Before tightening the mounting bolts, be certain all points of the grinder base are in contact with the mounting bracket or the bench. Otherwise, the base may be warped or cracked. Then tighten the grinder bolts securely. This grinder should

be installed in as cool and dry a place as possible where it will be protected from excessive deposits of dust and dirt. It should not be confined to the extent that the free flow of air about it is restricted.

## CIRCUIT

If this grinder is not required to start under load and if it is not overloaded after starting, the standard 15 ampere lighting circuit fuses should be satisfactory. Otherwise, a delayed-action type fuse such as a "fusetron", which is designed to meet the demands of motor protection in addition to the demands of lighting circuit protection, should be used.

## WIRE SIZE

The following wire sizes are recommended for extensions or special circuits from the source of power supply:

Length of Extension	Wire Size Required (AWG NO.)
15 ft. or less	No. 16
15 to 50 ft.	No. 14
50 to 100 ft.	No. 12

## GROUNDING

As a precaution against the possibility of electrical shock from an internal ground in the grinder an external ground should be provided. This can be accomplished by running a wire from the frame to a water pipe, steam pipe, or any other metal object making direct contact with the earth. Good electrical contact can be established between the metal surfaces and ground lead by removing all paint and other foreign material from the surface of the metal at the point of connection.

## OPERATION

### CAUTION!!!

Wear grinding goggles or a protective face shield whenever you operate a grinder.

## GRINDER ACCESSORIES

Get the most from your Craftsman Grinder. Make it a multipurpose tool. The following accessories, available from your closest Sears retail and mail order store will fit your grinder and will permit

faster, easier, better work on many jobs now done by hand. For instance: Clean and polish shoes, polish silverware, clean pots and pans, sand, cut metals, etc.

9-2929	Rubber Wheel
9-6480	Wire Wheel 1/2" hole
9-6486	Tampico Wheel
9-6493	Buffing Wheel
9-2896	Buffing Compound Kit of 4 bars, 1 ea.: Emery black, Tripoli brown, Red rouge and White rouge
9-6428	Bayflex Abrasive Wheel 6 x 1/8 w 1/2" hole
9-2524	Sanding Drum
9-2533	Lambs Wool Drum (goes over 9-2524 above)
9-2610	Sander Disc, rubber back up plate
9-2612	5 1/2" cloth backed pre-gummed Sanding Discs — fine, coarse, medium, for use on 9-2610 above
9-2976	Jacobs 1/4" Geared Key Chuck
9-2594	Arbor for Disc Accessories to fit 1/4" Chuck 9-2976 above
9-2499	Sanding Drum for 1/4" Chuck 9-2976 above
28-6085	Plastic Face Shield
28-6060	Industrial Chipping, Grinding Goggles

## MOUNTING ACCESSORIES

Since some of the accessories are not as thick as the grinder wheels supplied, adequate support for the inside wheel flange can be obtained by inserting the necessary amount of wrought steel washers (all of same diameter with 1/2" holes) between the wheel spacer (Key No. 4) and the shoulder on the motor shaft. **Be sure all accessories are firmly secured before operating the grinder.** The wheel guards (Key Nos. 7 and 41) can be readily removed if necessary for some cleaning or polishing operations. If grinder is operated with wheel guards removed be sure end caps (Key No. 12) are replaced and held firmly in place with screws and washers (Key Nos. 5 and 6). However, for safety sake, do not remove wheel guards unless necessary.

## MAINTENANCE

Installed as instructed and given proper care as outlined below this grinder will give long trouble free operation.

## LUBRICATION

The ball bearings in this grinder were pre-lubricated at the factory for about 5,000 hours operation. Should they require repacking, clean thoroughly with gasoline, dry and repack. Do not fill more than 25% of the free air space. Overpacking causes bearings to overheat besides increasing the motor load. Do not oil ball bearings.

## CLEANING

No internal cleaning of grinder is required due to dust proof, totally enclosed construction.

## LOW VOLTAGE

Approximately 90% of all grinder failures are the result of low voltage at the grinder terminals or serious grinder overloading. Although your grinder is designed for operation on the voltage and frequency specified on the grinder nameplate, normal loads can be handled safely on voltages that are not more than 10% above or below the rated voltage. However heavy loads require the specified voltage at the grinder terminals.

### Some Causes of Low Voltage are:

1. Overloaded circuits
2. Under-sized extension cord or wiring
3. Overloading of power company's facilities

### Some Effects of Low Voltage are:

1. Grinder doesn't develop full power
2. Grinder starts slowly
3. Grinder overheats
4. Fuses blown frequently

## SERVICE

Your nearest Sears retail or mail order store will have your grinder serviced for you promptly at a reasonable rate.

## GUARANTEE

This Craftsman grinder was thoroughly inspected and tested before shipment. Should it fail due to faulty material or workmanship, we will repair it free of charge if returned to your Sears retail or mail order store within one year from date of purchase. This guarantee is void if either end frame (Key Nos. 15 and 40) has been removed by anyone other than an authorized Sears Service Station or if the grinder has been misused, abused or disassembled.

SEARS, ROEBUCK AND CO.  
AND SIMPSONS - SEARS, LTD.