

OPERATING INSTRUCTIONS
AND PARTS LIST FOR



CRAFTSMAN

REG. U. S. PAT. OFF.

Flexible Shaft

—Model Number 239.26331—

The model number of your shaft will be found on the motor coupling. Always mention this model number when communicating with us regarding this shaft or when ordering repair parts.

This list is valuable. It will assure your being able to obtain proper parts service. We suggest you keep it with other valuable papers.

SEARS, ROEBUCK AND CO.

IMPORTANT—Read before using your Flexible Shaft.

OPERATION AND CARE OF

CRAFTSMAN FLEXIBLE SHAFT

REG. U. S. PAT. OFF.

The New CRAFTSMAN Flexible Shaft is a high grade tool and should be given reasonable care. By following the instructions given regarding its operation and maintenance you will obtain continuous satisfactory service.

OUTER CASE: This is of two-wire galvanized steel construction—the inner wire is made from tempered spring steel and forms a bearing for the core; the outer wire acts as a filler to retain the shaft lubricant. The casing is compactly made, has maximum flexibility and is light in weight. However, it is not to be placed in a small circle or sharp bend as this may cause a permanent kink.

CORE: This is made up of a center wire and 23 high carbon steel wires helically wound; each layer being wound in the opposite direction to keep the backlash to a minimum. End fittings are heavy and strong enough for the load to be carried and are attached securely to the core. Read complete instructions to avoid overloading.

BALL BEARING HANDPIECE: This unit is fitted with oversize ball bearings throughout. The spindle is $\frac{1}{2}$ "—20 thread to accommodate any adapter or tool having this size hole and internal thread.

BALL BEARING MOTOR COUPLING: Designed to slip on the end of any $\frac{1}{2}$ " diameter driving shaft to which it can be securely attached by tightening the set screw in the motor coupling against the motor or drive shaft.

DIRECTION OF ROTATION: The arrow on the motor coupling indicates the direction in which the flexible shaft is to be operated. Check rotation of driving shaft before connecting and operating.

OPERATING SPEED: The shaft should not be operated at less than 1750 R.P.M. Higher speeds (not to exceed 3600 R.P.M.) are better, as the working capacity of the shaft is increased in proportion to its speeds. If operated at less than 1750 R.P.M. THE SHAFT SHOULD ONLY BE USED ON VERY LIGHT WORK. For DRILLING a maximum of $\frac{1}{4}$ H.P., 1750 R.P.M. motor is recommended. For GRINDING AND BUFFING a maximum of $\frac{1}{2}$ H.P., 3450 R.P.M. motor is recommended.

DO NOT USE TOOLS LARGER THAN THESE:

Operating at 1750 R.P.M.— $\frac{3}{16}$ " High Speed Drill (for Metal)	} Twisting of the shaft indicates overload which means you are using attachments that are too large, too heavy or that too much pressure is being applied.
Operating at 3450 R.P.M.—	
{ 3" Saw 4" Wire Brush 4" Grinding Wheel	

BENDING SHAFT: Keep the bend in your shaft as large as possible. Sharp bends reduce shaft's efficiency and life. Keep shaft as nearly straight as possible when not in use.

LUBRICATION: Lubricate handpiece and motor coupling with light machine oil (SAE 10 automobile engine oil, electric motor oil, sewing machine oil, or its equivalent). Too much oil or too heavy oil will cause heating. Core should be lubricated by using a small amount of ball bearing grease or vaseline about every 50 hours of use or every 3 months if shaft is not used very much.

CAUTION: Play safe. Always wear grinding goggles or a face shield when using a flexible shaft.

INSTRUCTIONS FOR TAKING CRAFTSMAN FLEXIBLE SHAFT APART

1. Both the motor coupling and handpiece are removable.
2. Remove the motor coupling by unscrewing housing 7861-1 from outer casing. Then grasp the core fitting with pliers and unscrew the motor coupling spindle 7862-1.
3. To remove the handpiece, unscrew housing 6055-2 from outer casing. Then grasp the core fitting at that end with pliers and unscrew handpiece spindle 6158-2.
4. Core can now be withdrawn from casing.

DIAGRAM AND PARTS LIST FOR **CRAFTSMAN** FLEXIBLE SHAFT

REG. U. S. PAT. OFF.

Model Number 239.26331

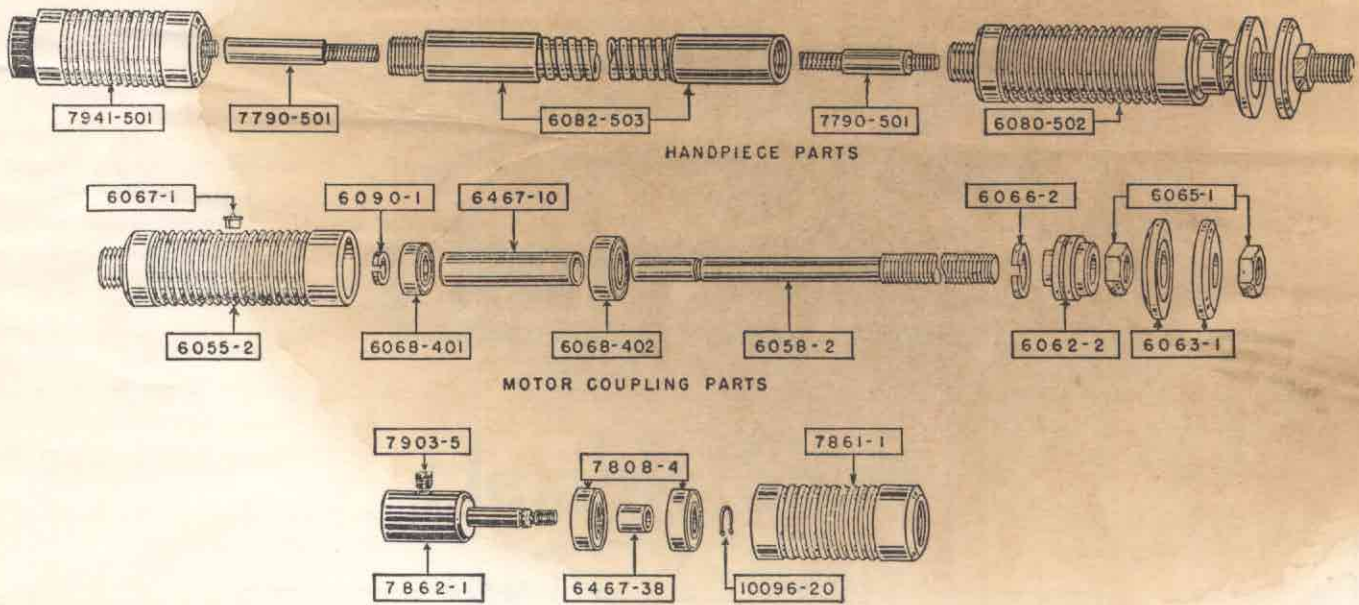

Part Number	Name of Part	Prepaid Selling Price Each
7941-501	BALL BEARING MOTOR COUPLING, Complete	6.50
7790-501	COMPLETE CORE	3.50
6082-503	COMPLETE CASE	3.93
6080-502	BALL BEARING HANDPIECE, Complete	8.00
6055-2	Handpiece Housing Only	2.90
6067-1	Oil Fitting	.20
6090-1	Snap Ring	.14
6068-401	Ball Bearing	.56
6467-10	Bearing Spacer	.22
6068-402	Ball Bearing	.60
6058-2	Spindle (1/2" 20 Thread Arbor End)	2.17
6066-2	Snap Ring	.14
6062-2	Spindle Nut	.52
6065-1	Standard Hexagon Jam Nut (1/2" 20 Thread) 2 required	.10
6063-1	Wheel Flanges—2 required	.25
7862-1	Coupling Spindle (1/2" Diam. Bore)	2.40
7903-5	Standard Cup Point Slotted Head Set Screw (5/16"—18 x 5/16")	.08
7808-4	Ball Bearing—2 required	.70
6467-38	Bearing Spacer	.22
10096-20	Retaining Ring	.22
7861-1	Motor Coupling Housing Only	2.40

Note: Above prices are subject to change without notice.

HOW TO ORDER REPAIR PARTS FOR **CRAFTSMAN** FLEXIBLE SHAFT

REG. U. S. PAT. OFF.

Parts must be ordered from your nearest Sears Retail Store or mail order house. Order parts by mail from the mail order store which serves the territory in which you live.

When ordering repair parts always give the following information:

1. The part number, part name and price shown in above list.
2. The Model Number of your shaft which is number 239.26331 and will be found on Motor Coupling Housing.

TO INCREASE THE LENGTH OF YOUR **CRAFTSMAN** FLEXIBLE SHAFT

REG. U. S. PAT. OFF.

Order Catalog No. 9-2634, CRAFTSMAN EXTENSION—LENGTH 38 INCHES