

REPAIR PARTS
for
BROWN & SHARPE
No. **13** UNIVERSAL AND TOOL
GRINDING MACHINE
(Motor and Overhead Driven)



THE parts are arranged in the illustrations so far as possible in the same relative positions as in the machine. This is to facilitate stripping and assembling as well as identifying the parts.

The parts are shown separated to make the construction of the machine more readily understood and to show each part to the best advantage. In some cases, when a particular part is ordered, not only that part but one or more supplementary parts also may be sent when, from our experience, this is known to be advisable for a more satisfactory repair job.

Repair parts, in some cases, will require fitting and therefore may need holes to be drilled, shoulders to be squared or similar machining in order to make them fit properly.

When ordering repair parts, it is essential that the size, style and serial number of the machine be stated in addition to the part number and name given in this booklet.

Please keep this booklet in the hands of the individual in your organization who is responsible for the *repair* of this machine.

BROWN & SHARPE MFG. CO.

PROVIDENCE 1, R. I., U. S. A.

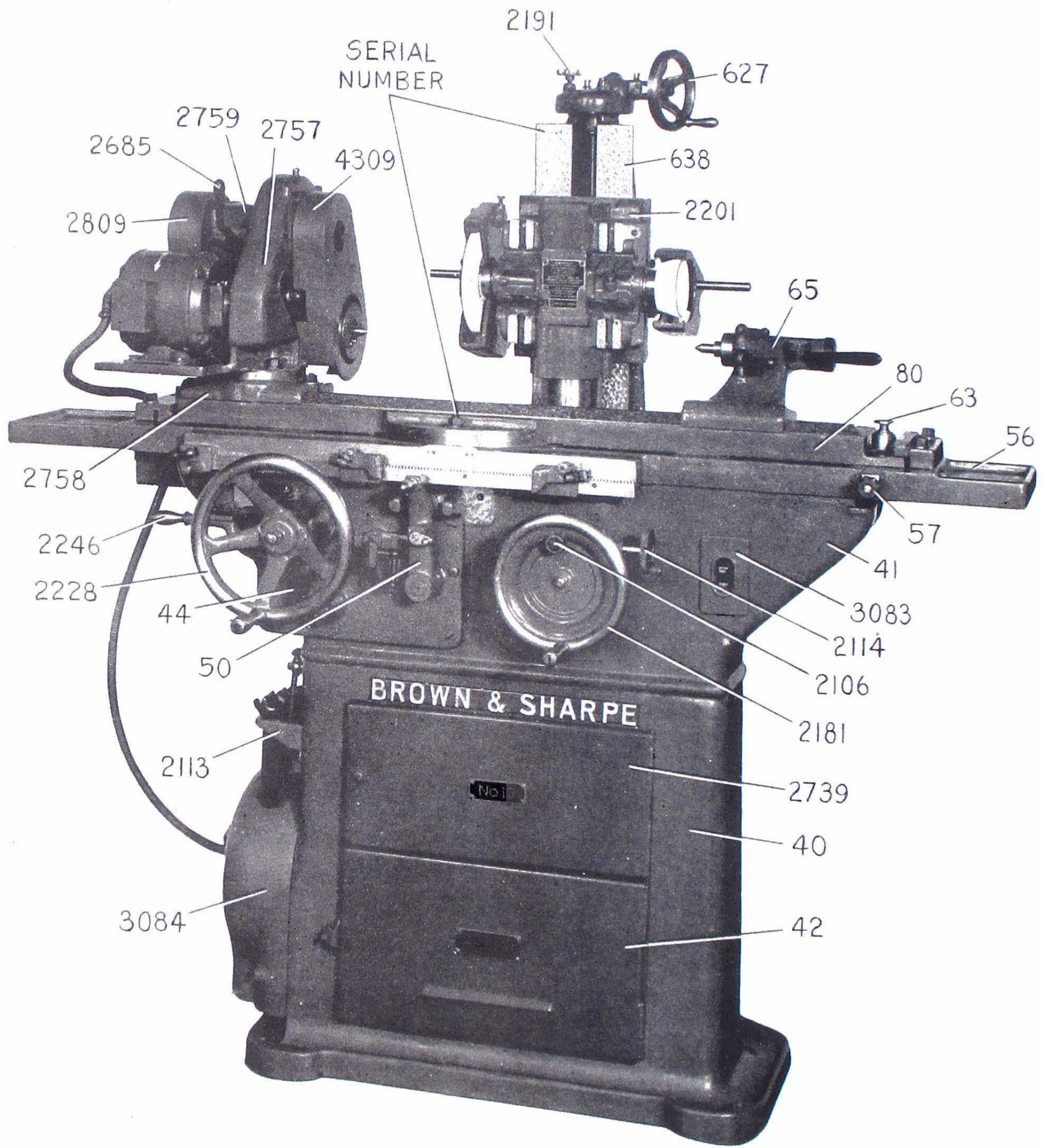

Front View
 (Motor Driven Machine Shown)

When ordering parts, state the size, style and serial number of the machine in addition to the part number and name.

Front View

40	Base
41	Table Bed
42	Base Door
44	Bed Front Plate
50	Reversing Lever
56	Sliding Table
57	Swivel Table Adjusting Knob
63	Swivel Table Locking Pin Knob
65	Footstock
80	Swivel Table
627	Elevating Handwheel
638	Upright
2106	Cross Feed Dial Clamp Bolt Knob
2113	Wrench Rack
2114	Cross Feed Worm Knob
2181	Cross Feed Dial and Handwheel
2191	Elevating Gear Guard Clamp Screw
2201	Wheel Slide
2228	Table Feed Handwheel
2246	Table Feed Lever
*2685	Clutch Fork Lever
2757	Headstock Body
*2758	Headstock Base
*2759	Headstock Cover
*2809	Headstock Pulley Guard, Left
3083	Push Button Hole Cover
*3084	Motor Guard
*4309	Headstock Pulley Guard, Right
2739	Electrical Controls Door

* Motor Driven Machine

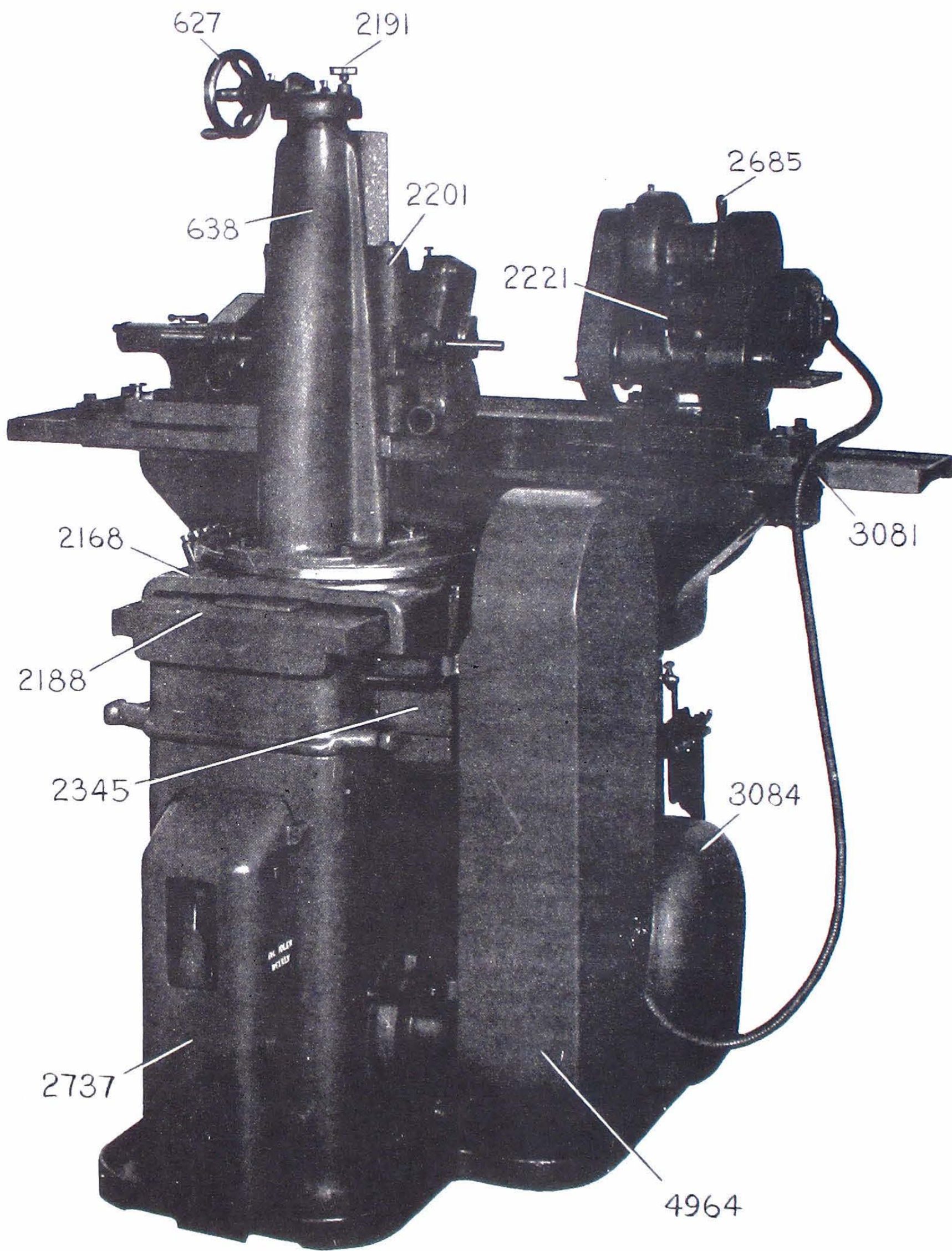

Rear View
(Motor Driven Machine Shown)

When ordering parts, state the size, style and serial number of the machine in addition to the part number and name.

Rear View

627	Elevating Handwheel
638	Upright
2168	Cross Slide
2188	Cross Slide Guard, Large
2191	Elevating Gear Guard Clamp Screw
2201	Wheel Slide
2221	Headstock Spindle Clamp Screw
2345	Reversing Mechanism Bracket
*2685	Clutch Fork Lever
*2737	Swinging Idler Pulley Bracket Guard
*3081	Cable Guide
*3084	Motor Guard
4964	Feed Cone Pulley Guard

* Motor Driven Machine

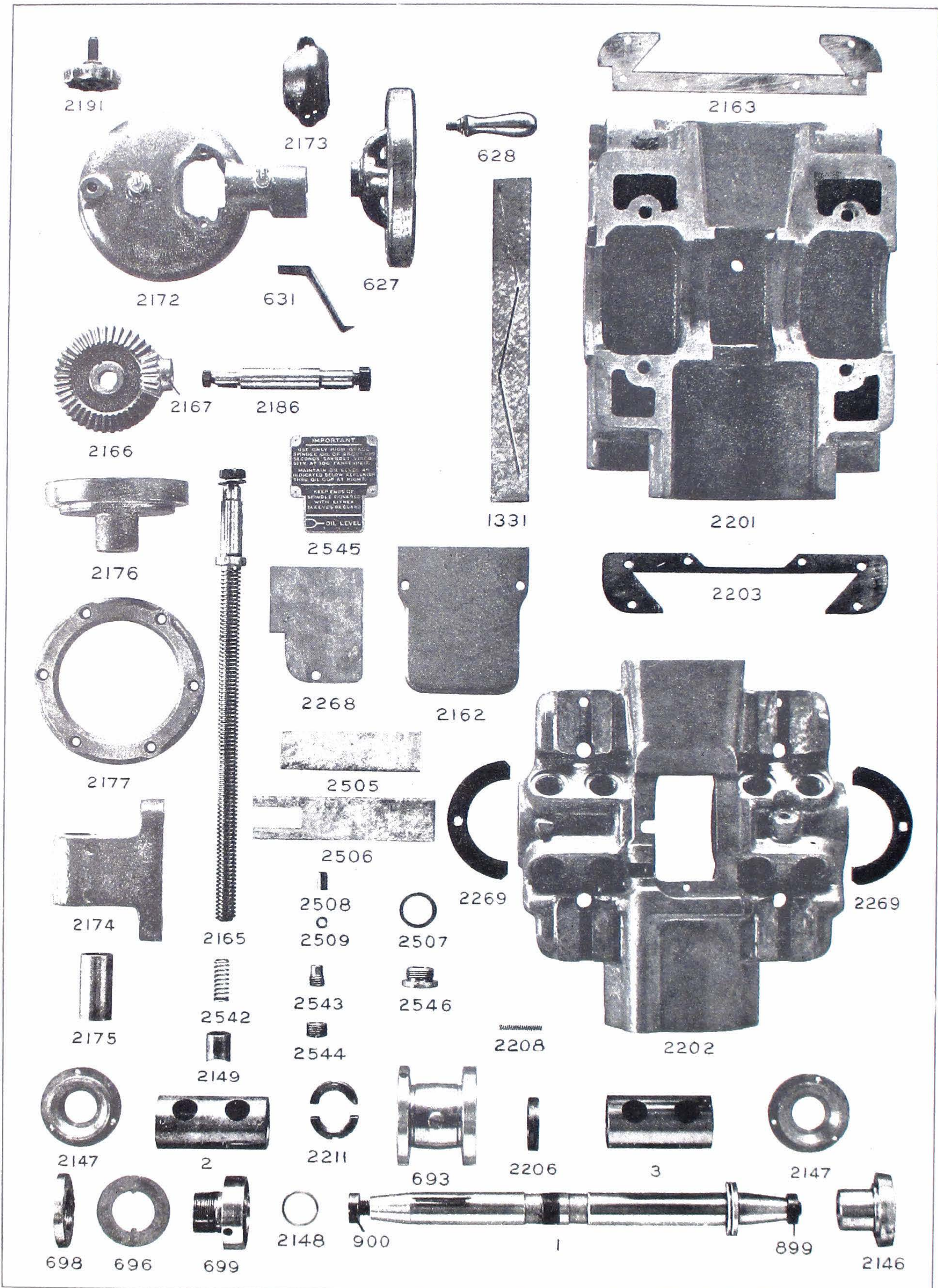

Elevating Mechanism and Wheel Spindle Parts

When ordering parts, state the size, style and serial number of the machine in addition to the part number and name.

Elevating Mechanism and Wheel Spindle Parts

1	Wheel Spindle
2	Wheel Spindle Box, Left
3	Wheel Spindle Box, Right
627	Elevating Handwheel
628	Elevating Handwheel Handle
631	Elevating Screw Index Finger
693	Spindle Pulley
696	Wheel Sleeve Washer
698	Wheel Sleeve Nut
699	Wheel Sleeve
899	Wheel Spindle Nut, Right Hand
900	Wheel Spindle Nut, Left Hand
1331	Wheel Slide Gib
2146	Wheel Spindle Guard
2147	Spindle Dust Guard
2148	Spindle Oil Slinger
2149	Spindle Bearing Spring Plunger
2162	Wheel Slide Belt Opening Cover (Motor Driven Machine)
2163	Wheel Slide Wiper Plate, Upper
2165	Elevating Screw
2166	Elevating Screw Gear
2167	Elevating Screw Pinion
2172	Elevating Bevel Gear Guard
2173	Elevating Bevel Gear Guard Cap
2174	Elevating Screw Nut Bracket
2175	Elevating Screw Nut
2176	Elevating Screw Bearing
2177	Elevating Gear Guard Ring
2186	Elevating Screw Bevel Pinion Shaft
2191	Elevating Gear Guard Clamp Screw
2201	Wheel Slide
2202	Wheel Slide Cover
2203	Wheel Slide Wiper Plate, Lower
2206	Spindle Pulley Thrust Collar
2208	Spindle Pulley Spring
2211	Spindle Pulley Nut
2268	Spindle Pulley Guard
2269	Wheel Slide End Guard
2505	Spindle Box Felt, Left
2506	Spindle Box Felt, Right
2507	Spindle Bearing Spring Screw Gasket
2508	Oil Gage Glass
2509	Oil Gage Glass Cork Washer
2542	Spindle Bearing Plunger Spring
2543	Oil Glass Retainer Screw
2544	Oil Reservoir Drain Plug
2545	Spindle Notice Plate
2546	Spindle Bearing Spring Screw
*3213	Wheel Spindle Driving Belt (Not illustrated)

*Smooth running, oil-resistant, endless flat belt; 1¼" wide; 118" inside circumference.

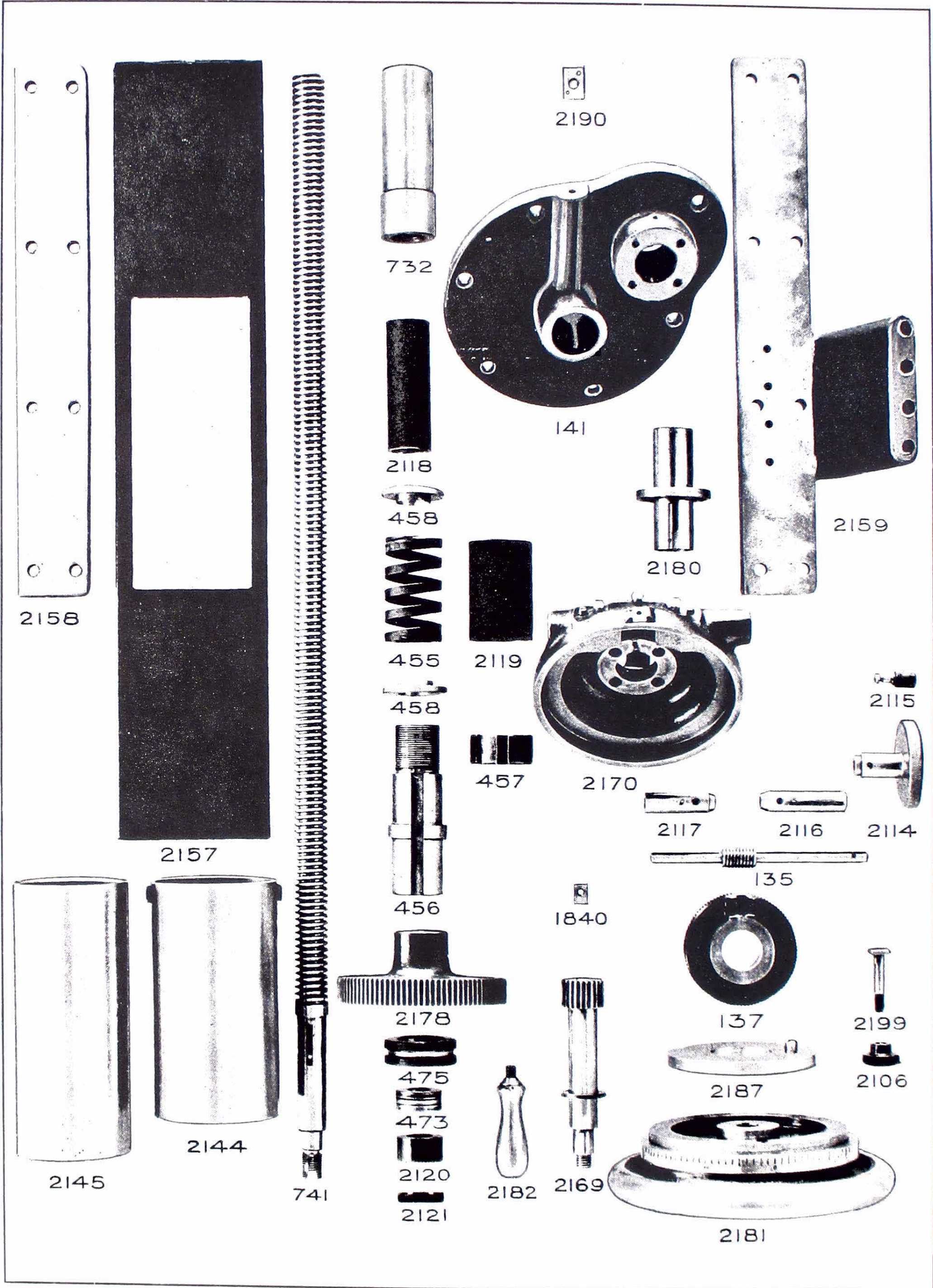

Cross Feed Parts

When ordering parts, state the size, style and serial number of the machine in addition to the part number and name.

Cross Feed Parts

135	Cross Feed Worm
137	Cross Feed Wormwheel
141	Cross Feed Bracket
455	Cross Feed Screw Spring
456	Cross Feed Screw Nut, Front
457	Cross Feed Screw Nut Collar
458	Spring Retainer Collar
473	Cross Feed Screw Ball Thrust
475	Cross Feed Bracket Ball Thrust
732	Cross Feed Screw Nut, Rear
741	Cross Feed Screw
1840	Cross Feed Dial Finger
2106	Cross Feed Dial Clamp Bolt Knob
2114	Cross Feed Worm Knob
2115	Cross Feed Worm Knob Handle
2116	Cross Feed Worm Bearing, Long
2117	Cross Feed Worm Bearing, Short
2118	Cross Feed Screw Guard
2119	Cross Feed Screw Spring Guard
2120	Cross Feed Screw Locking Nut
2121	Cross Feed Screw Locking Nut Stop
2144	Wheel Spindle Belt Guard, Upper (Motor Driven Machine)
2145	Wheel Spindle Belt Guard, Lower (Motor Driven Machine)
2157	Cross Slide Guard, Small
2158	Cross Slide Clamp, Left
2159	Cross Slide Clamp, Right
2169	Cross Feed Driving Gear
2170	Cross Feed Worm Case
2178	Cross Feed Screw Gear
2180	Cross Feed Bracket Bushing
2181	Cross Feed Dial & Handwheel
2182	Cross Feed Dial Handle
2187	Cross Feed Dial Clamp Disk
2190	Upright Swivel Index Finger
2199	Cross Feed Dial Clamp Bolt

Bed Front Plate Parts

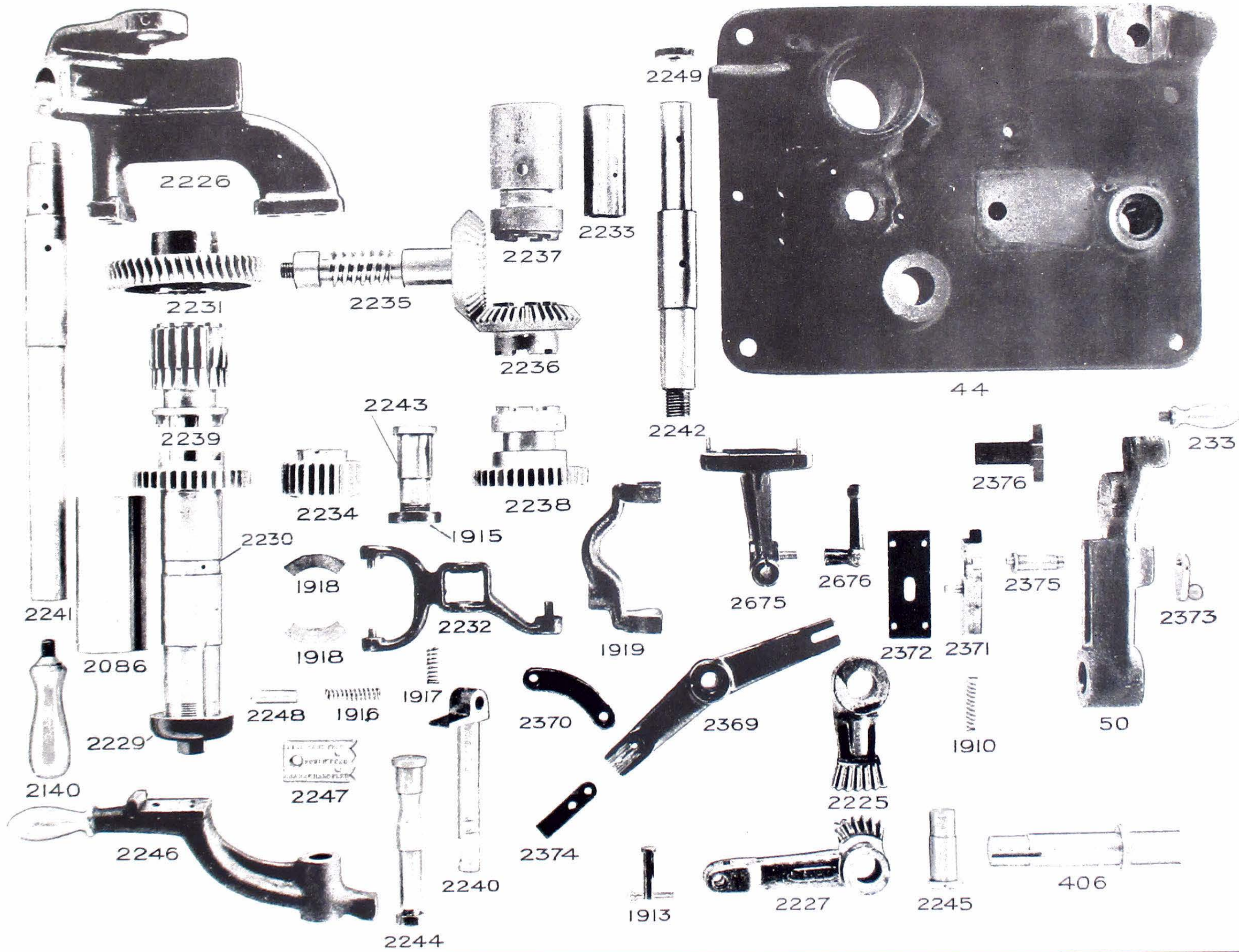

When ordering parts, state the size, style and serial number of the machine in addition to the part number and name.

Bed Front Plate Parts

44	Bed Front Plate
50	Reversing Lever
233	Reversing Lever Handle
406	Reversing Lever Shaft
1910	Reversing Lever Plunger Spring
1913	Reversing Segment Pin
1915	Table Feed Lever Rod Sleeve Nut
1916	Table Feed Lever Stop Plunger Spring
1917	Table Feed Clutch Fork Lever Spring
1918	Table Feed Clutch Fork Lever Shoe
1919	Table Feed Clutch Fork
2086	Table Feed Handwheel Sleeve
2140	Table Feed Handwheel Handle
2225	Reversing Lever Segment
2226	Table Feed Worm Bracket
2227	Reversing Segment
2229	Table Feed Handwheel Nut
2230	Table Feed Handwheel Gear
2231	Table Feed Wormwheel
2232	Table Feed Clutch Fork Lever
2233	Table Feed Worm Clutch Sleeve
2234	Table Feed Intermediate Pinion
2235	Table Feed Worm
2236	Table Feed Worm Clutch
2237	Table Feed Clutch
2238	Table Feed Clutch Gear
2239	Table Feed Rack Pinion
2240	Table Feed Lever Rod
2241	Table Feed Shaft
2242	Table Feed Clutch Gear Shaft
2243	Table Feed Lever Rod Sleeve
2244	Table Feed Lever Stud
2245	Reversing Segment Stud
2246	Table Feed Lever
2247	Table Feed Lever Plate
2248	Table Feed Lever Stop Plunger
2249	Table Feed Clutch Gear Shaft Washer
2369	Lever Rod Stop Lever
2370	Lever Rod Stop Lever Bridge
2371	Reversing Lever Plunger
2372	Reversing Lever Plunger Plate
2373	Reversing Lever Plunger Eccentric Arm
2374	Lever Rod Stop Lever Extension
2375	Reversing Lever Plunger Eccentric
2376	Reversing Lever Stop
2675	Dial Indicator Holder
2676	Dial Indicator Holder Clamp Handle

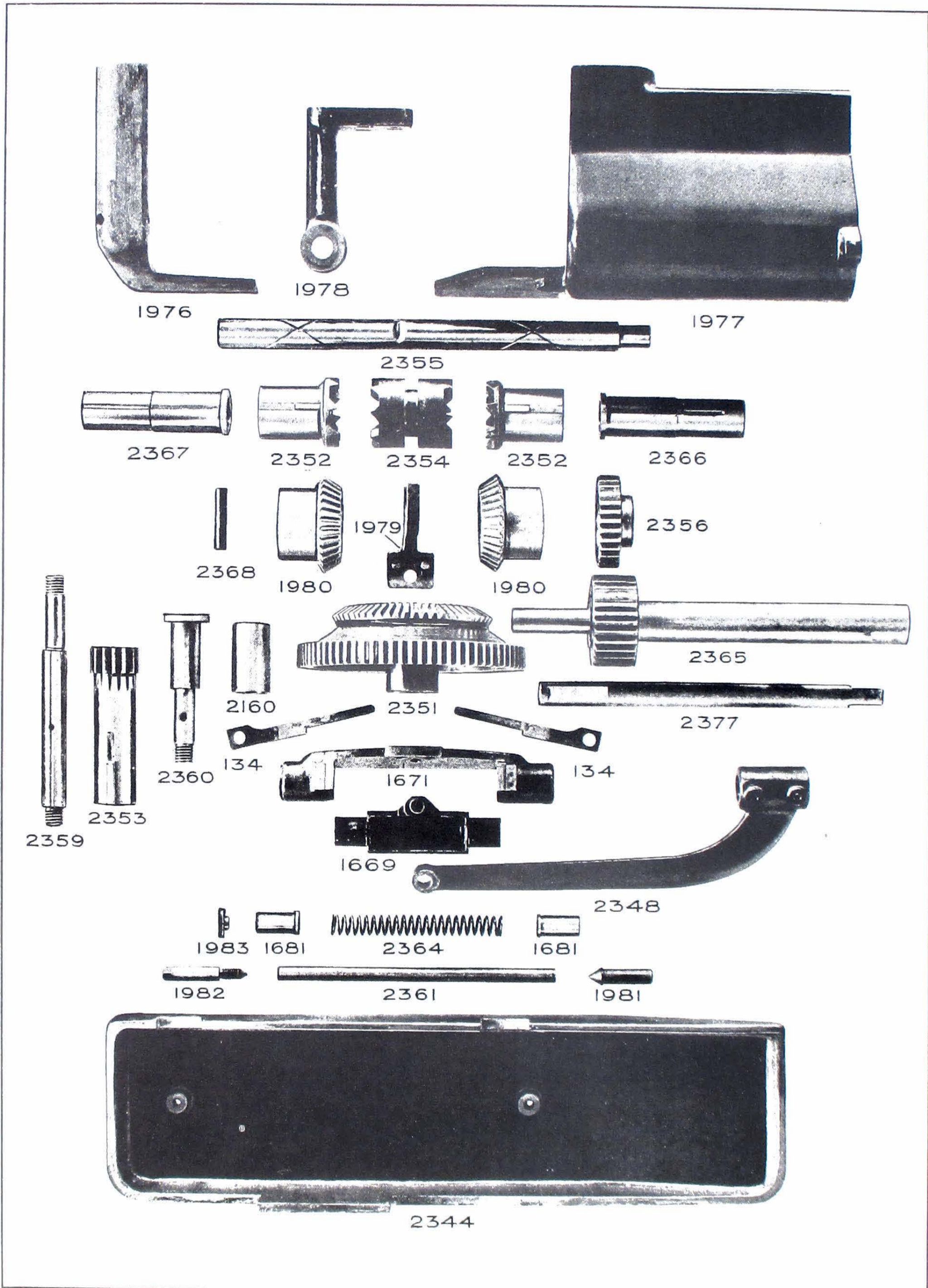

Reversing Mechanism Parts

When ordering parts, state the size, style and serial number of the machine in addition to the part number and name.

Reversing Mechanism Parts

134	Locking Pawl
1669	Spring Case
1671	Reversing Shipper
1681	Spring Case Bushing
1976	Reversing Mechanism Guard, Rear
1977	Reversing Mechanism Guard, Front
1978	Driving Gear Bracket
1979	Clutch Fork
1980	Driving Clutch Shaft Pinion
1981	Table Feed Clutch Shipper Center, Rear
1982	Table Feed Clutch Shipper Center, Front
1983	Shipper Center Lock Nut
2160	Driving Gear Bushing
2344	Reversing Mechanism Oil Tray
2348	Reversing Rod Link
2351	Driving Gear
2352	Driving Clutch Face
2353	Driving Cone Pulley Pinion
2354	Driving Clutch
2355	Driving Clutch Shaft
2356	Driving Clutch Shaft Gear
2359	Driving Cone Pinion Stud
2360	Driving Gear Stud
2361	Reversing Spring Rod
2364	Reversing Spring
2365	Driving Gear Shaft
2366	Clutch Face Bushing, Right
2367	Clutch Face Bushing, Left
2368	Driving Clutch Pin
2377	Reversing Segment Rod

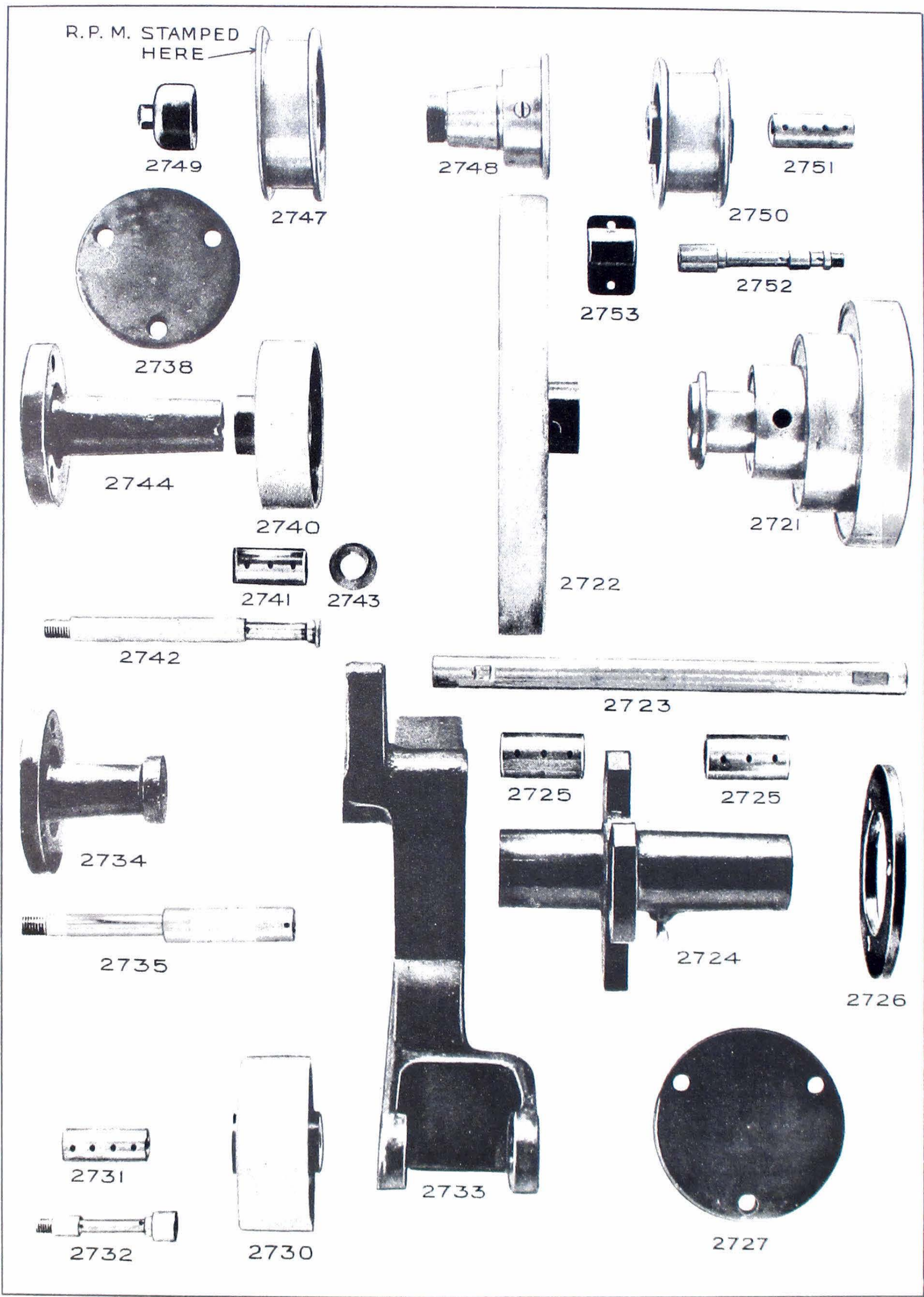

Driving Parts
Motor Driven Machine

When ordering parts, state the size, style and serial number of the machine in addition to the part number and name.

Driving Parts

Motor Driven Machine

- 2721 Feed Driving Cone Pulley (State Upper or Lower)
- 2722 Feed Driving Pulley
- 2723 Driving Cone Pulley Shaft
- 2724 Driving Cone Pulley Bearing
- 2725 Driving Cone Pulley Bearing Bushing
- 2726 Driving Cone Pulley Bearing Cap
- 2727 Driving Cone Bearing Opening Cover (Belt Driven Machine)
- 2730 Swinging Idler Pulley
- 2731 Swinging Idler Pulley Bushing
- 2732 Swinging Idler Pulley Stud
- 2733 Swinging Idler Arm
- 2734 Swinging Idler Arm Support
- 2735 Swinging Idler Arm Stud
- 2738 Idler Support Opening Cover (Belt Driven Machine)
- 2740 Stationary Idler Pulley
- 2741 Stationary Idler Pulley Bushing
- 2742 Stationary Idler Pulley Stud
- 2743 Stationary Idler Pulley Washer
- 2744 Stationary Idler Pulley Support
- 2747 Motor Pulley, Specify R. P. M.
- 2748 Motor Pulley Sleeve
- 2749 Motor Pulley Sleeve Nut
- 2750 Idler Pulley
- 2751 Idler Pulley Bushing
- 2752 Idler Pulley Stud
- 2753 Idler Pulley Stud Opening Cover (Belt Driven Machine)
- *3218 Feed Driving Cone Pulley Belt (Not illustrated)
- **3219 Base Motor Feed Belt (Not illustrated)

*Smooth running, flat belt with cemented lap; 1 $\frac{1}{4}$ " wide; 65" inside circumference.

**Smooth running, flat belt with cemented lap; 1" wide; 59 $\frac{1}{2}$ " inside circumference.

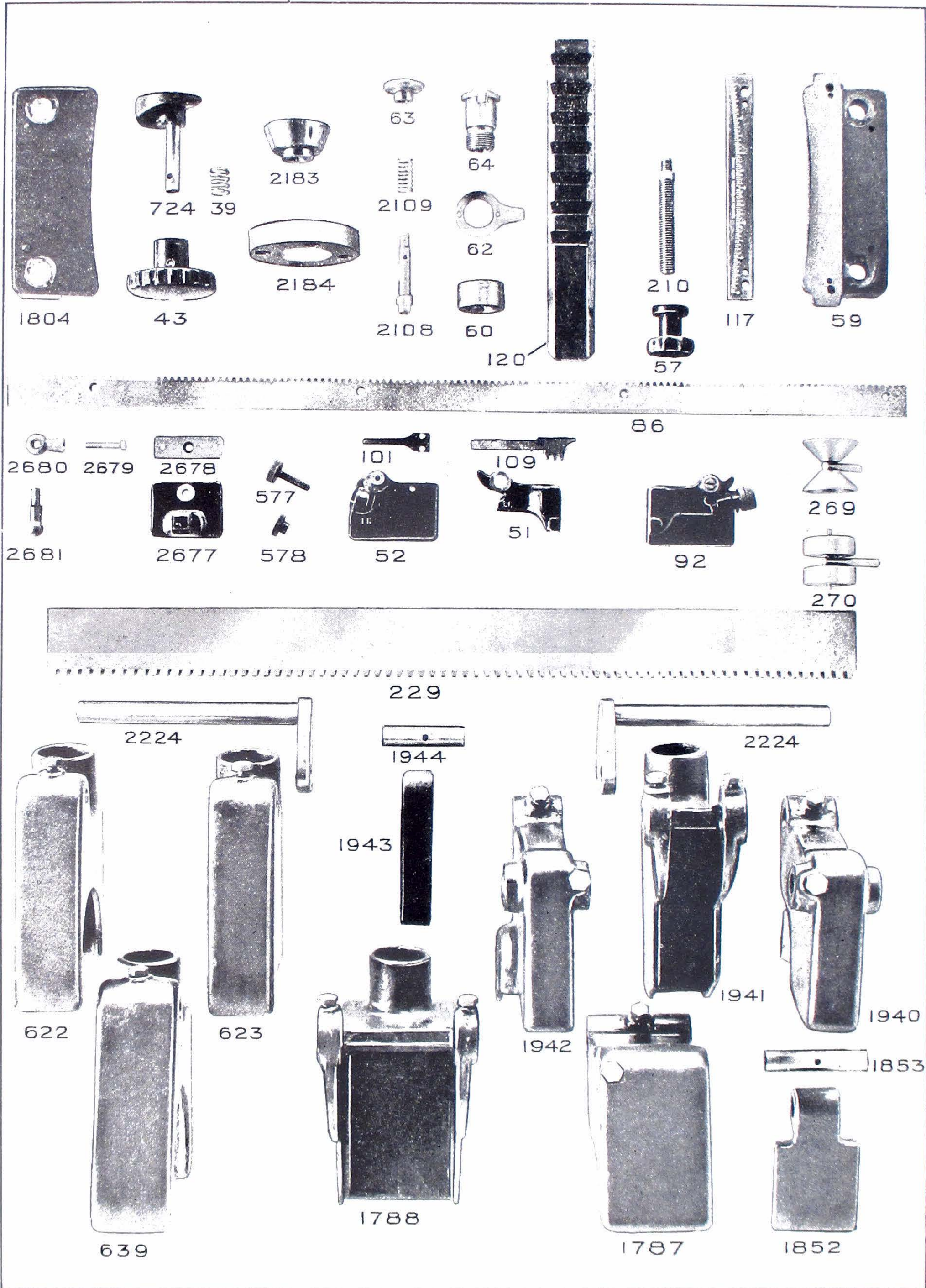

Wheel Guards and Miscellaneous Parts

When ordering parts, state the size, style and serial number of the machine in addition to the part number and name.

Wheel Guards and Miscellaneous Parts

39	Base Door Latch Spring
43	Base Door Knob
51	Table Dog, Specify Right or Left Hand
52	Table Dog Bracket, Specify Right or Left Hand
57	Swivel Table Adjusting Knob
59	Swivel Table Clamp, Right
60	Swivel Table Index Finger Bushing
62	Swivel Table Index Finger
63	Swivel Table Locking Pin Knob
64	Swivel Table Locking Pin Bushing
86	Table Dog Rack
92	Table Dog Complete, Specify Right or Left Hand
101	Table Dog Pawl Spring
109	Table Dog Pawl
117	Table Scale
120	Table Adjusting Plate
210	Swivel Table Adjusting Screw
229	Table Rack
269	Oil Roll, Back
270	Oil Roll, Front
577	Table Dog Adjusting Screw
578	Table Dog Adjusting Nut
622	Wheel Guard, Left
623	Wheel Guard, Right
639	Wheel Guard
724	Base Door Latch
1787	Wheel Guard, Wide Upper
1788	Wheel Guard, Wide Lower
1804	Swivel Table Clamp, Left
1852	Wheel Guard Wide Tongue
1853	Wheel Guard Wide Tongue Fulcrum
1940	Wheel Guard, Narrow Upper, R. H.
1941	Wheel Guard, Narrow Lower
1942	Wheel Guard, Narrow Upper, L. H.
1943	Wheel Guard Narrow Tongue
1944	Wheel Guard Narrow Tongue Fulcrum
2108	Swivel Table Locking Pin
2109	Swivel Table Locking Pin Spring
2183	Swivel Table Center
2184	Swivel Table Center Ring
2224	Wheel Guard Support
2677	Dial Indicator Stop
2678	Dial Indicator Stop Clamp
2679	Dial Indicator Stop Clamp Bolt
2680	Dial Indicator Stop Clamp Nut
2681	Dial Indicator Stop Clamp Handle

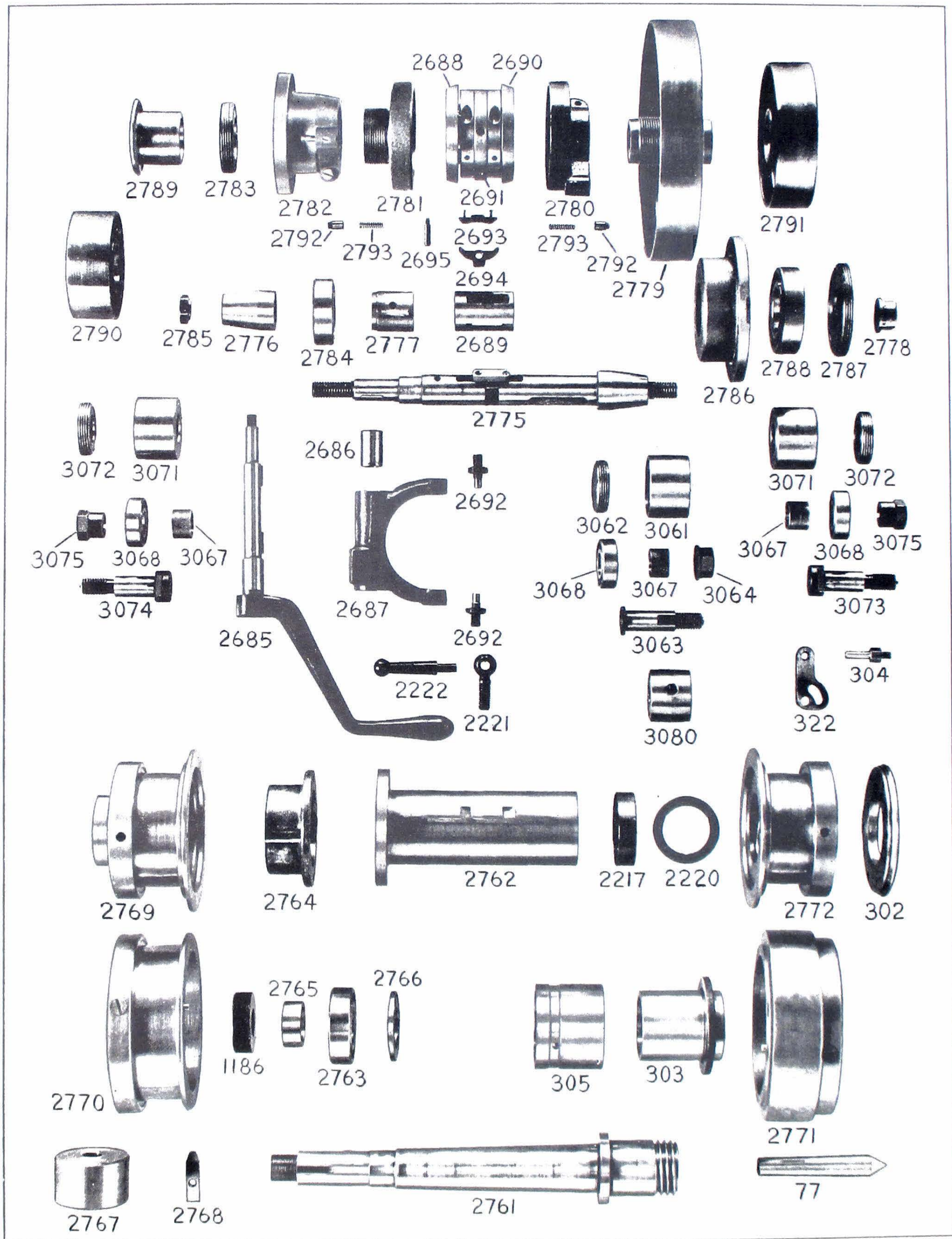

Headstock Parts
Motor Driven Machine

When ordering parts, state the size, style and serial number of the machine in addition to the part number and name.

Headstock Parts

Motor Driven Machine

77	Headstock Center	2777	Headstock Countershaft Collar
302	Dead Center Pulley Flange	2778	Headstock Countershaft Nut, Right
303	Dead Center Pulley Bearing	2779	Countershaft Driving Pulley
304	Work Driving Pin	2780	Countershaft Driving Pulley Clutch
305	Dead Center Pulley Bushing	2781	Countershaft Brake
322	Work Driving Arm	2782	Countershaft Bearing Container, Rear
1186	Headstock Spindle Nut		
2217	Headstock Spindle Dust Guard	2783	Countershaft Bearing Container Nut, Rear
2220	Headstock Spindle Thrust Washer		
2221	Headstock Spindle Clamp Screw	2784	Countershaft Ball Bearing, Rear
2222	Headstock Spindle Clamp Screw Handle	2785	Countershaft Nut, Inner
		2786	Countershaft Bearing Container, Front
2685	Clutch Fork Lever		
2686	Clutch Fork Lever Sleeve	2787	Countershaft Bearing Container Nut, Front
2687	Clutch Fork		
2688	Clutch Body	2788	Countershaft Ball Bearing, Front
2689	Clutch Body Bushing	2789	Countershaft Change Pulley, 1 1/2" Diameter
2690	Clutch Sleeve		
2691	Clutch Sleeve Ring	2790	Countershaft Change Pulley, 3" Diameter
2692	Clutch Sleeve Ring Screw		
2693	Clutch Shoe	2791	Countershaft Change Pulley, 4" Diameter
2694	Clutch Lever		
2695	Clutch Body Fulcrum	2792	Countershaft Driving Pulley and Brake Plunger
2761	Headstock Spindle		
2762	Headstock Bushing	2793	Countershaft Driving Pulley and Brake Plunger Spring
2763	Headstock Spindle Ball Bearing		
2764	Headstock Spindle Ball Bearing Container	3061	Motor Idler Pulley
		3062	Motor Idler Nut
2765	Headstock Spindle Ball Bearing Spacing Collar	3063	Motor Idler Stud
		3064	Motor Idler Stud Nut
2766	Headstock Spindle Thrust Washer, Rear	3067	Idler Sleeve
		3068	Idler Pulley Ball Bearing
2767	Headstock Body Pivot	3071	Change Pulley Idler Pulley
2768	Headstock Base Index Pointer	3072	Change Pulley Idler Nut
2769	Headstock Spindle Driving Pulley	3073	Change Pulley Idler Stud, Front
2770	Spindle Change Pulley, 4" Diameter	3074	Change Pulley Idler Stud, Rear
2771	Spindle Change Pulley, 5" Diameter	3075	Change Pulley Idler Stud Nut
2772	Dead Center Pulley	3080	Headstock Motor Pulley
2775	Headstock Countershaft	*5195	Headstock Motor Belt (Not illustrated)
2776	Headstock Countershaft Taper Sleeve	**5353	Headstock Spindle Belt (Not illustrated)

*Smooth running, oil-resistant, endless flat belt; 1" wide; 26 3/4" inside circumference for 60 cycle motor or 27 1/2" for 50 cycle motor.

**Smooth running, oil-resistant, endless flat belt; 1" wide; 24" inside circumference.

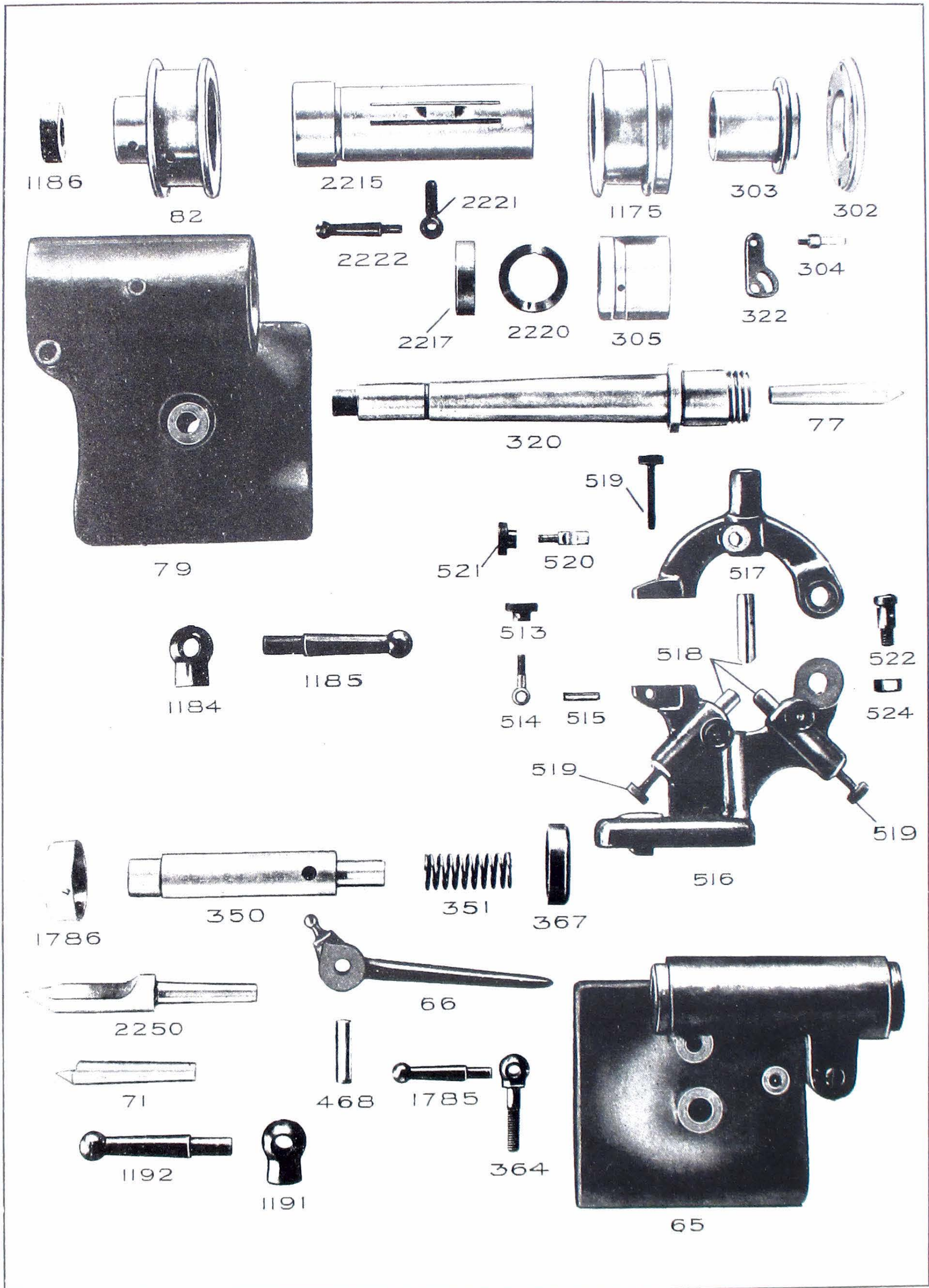

Headstock Parts
Overhead Driven Machine

Footstock and Center Rest Parts

When ordering parts, state the size, style and serial number of the machine in addition to the part number and name.

Headstock Parts

Overhead Driven Machine

Footstock and Center Rest Parts

65	Footstock
66	Footstock Lever
71	Footstock Center
77	Headstock Center
79	Headstock Body
82	Headstock Driving Pulley
302	Dead Center Pulley Flange
303	Dead Center Pulley Bearing
304	Work Driving Pin
305	Dead Center Pulley Bushing
320	Headstock Spindle
322	Work Driving Arm
350	Footstock Spindle
351	Footstock Spindle Spring
364	Footstock Spindle Clamp Screw
367	Footstock Nut
468	Footstock Lever Fulcrum
513	Center Rest Clamp Bolt Nut
514	Center Rest Clamp Bolt
515	Center Rest Clamp Bolt Fulcrum
516	Center Rest Base
517	Center Rest Top
518	Center Rest Jaw
519	Center Rest Jaw Adjusting Screw
520	Center Rest Jaw Clamp Bolt
521	Center Rest Jaw Clamp Bolt Nut
522	Center Rest Fulcrum Screw
524	Center Rest Fulcrum Nut
1175	Dead Center Pulley
1184	Headstock Clamp Bolt Nut
1185	Headstock Clamp Bolt Nut Handle
1186	Headstock Spindle Nut
1191	Footstock Clamp Bolt Nut
1192	Footstock Clamp Bolt Nut Handle
1785	Footstock Spindle Clamp Screw Handle
1786	Footstock Spindle Dust Guard
2215	Headstock Bushing
2217	Headstock Spindle Dust Guard
2220	Headstock Spindle Thrust Washer
2221	Headstock Spindle Clamp Screw
2222	Headstock Spindle Clamp Screw Handle
2250	Reamer Grinding Center

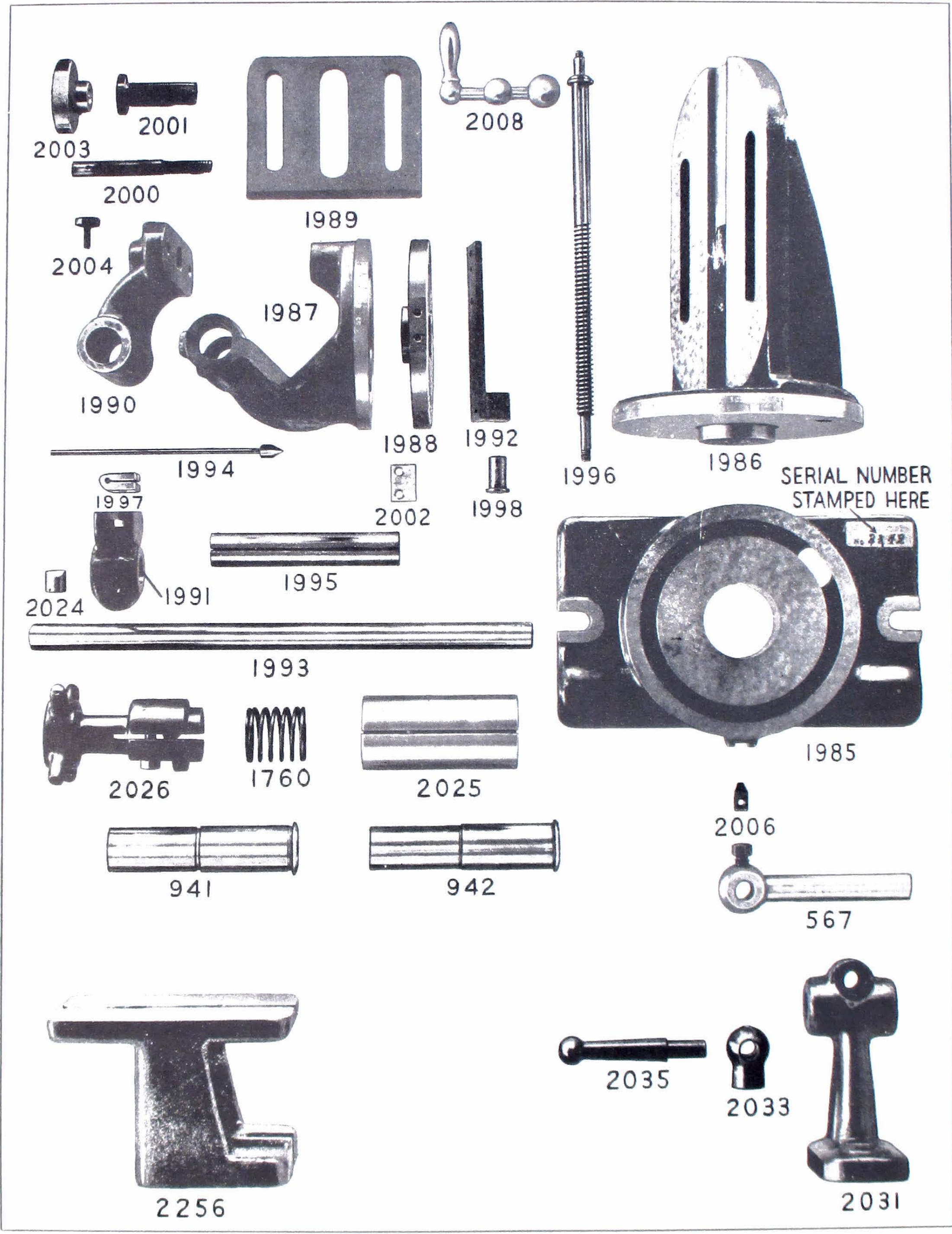

Universal Head Parts

When ordering parts, state the size, style and serial number of the machine in addition to the part number and name.

Universal Head Parts

567	Diamond Tool Holder
941	Taper Shank Mill Bushing, No. 7 Taper
942	Taper Shank Mill Bushing, No. 9 Taper
1760	Taper Shank Mill Bushing Sleeve Spring
1985	Universal Head Base
1986	Upright
1987	Swivel
1988	Swivel Plate
1989	Jaw Plate
1990	Jaw
1991	Stop Dog
1992	Nut
1993	Stop Dog Rod
1994	Stop Rod
1995	Sleeve
1996	Screw
1997	Stop Rod Clamp
1998	Screw Sleeve
2000	Clamp Screw
2001	Jaw Adjusting Screw
2002	Swivel Plate Index Finger
2003	Clamp Screw Knob
2004	Jaw Adjusting Screw Clamp Screw
2006	Index Finger
2008	Screw Crank
2024	Stop Dog Clamp Bushing
2025	Taper Shank Mill Bushing Sleeve
2026	Taper Shank Mill Bushing Handle
2031	Diamond Tool Bracket
2033	Diamond Tool Bracket Clamp Bolt Nut
2035	Diamond Tool Bracket Clamp Bolt Nut Handle
2256	Tool Rest

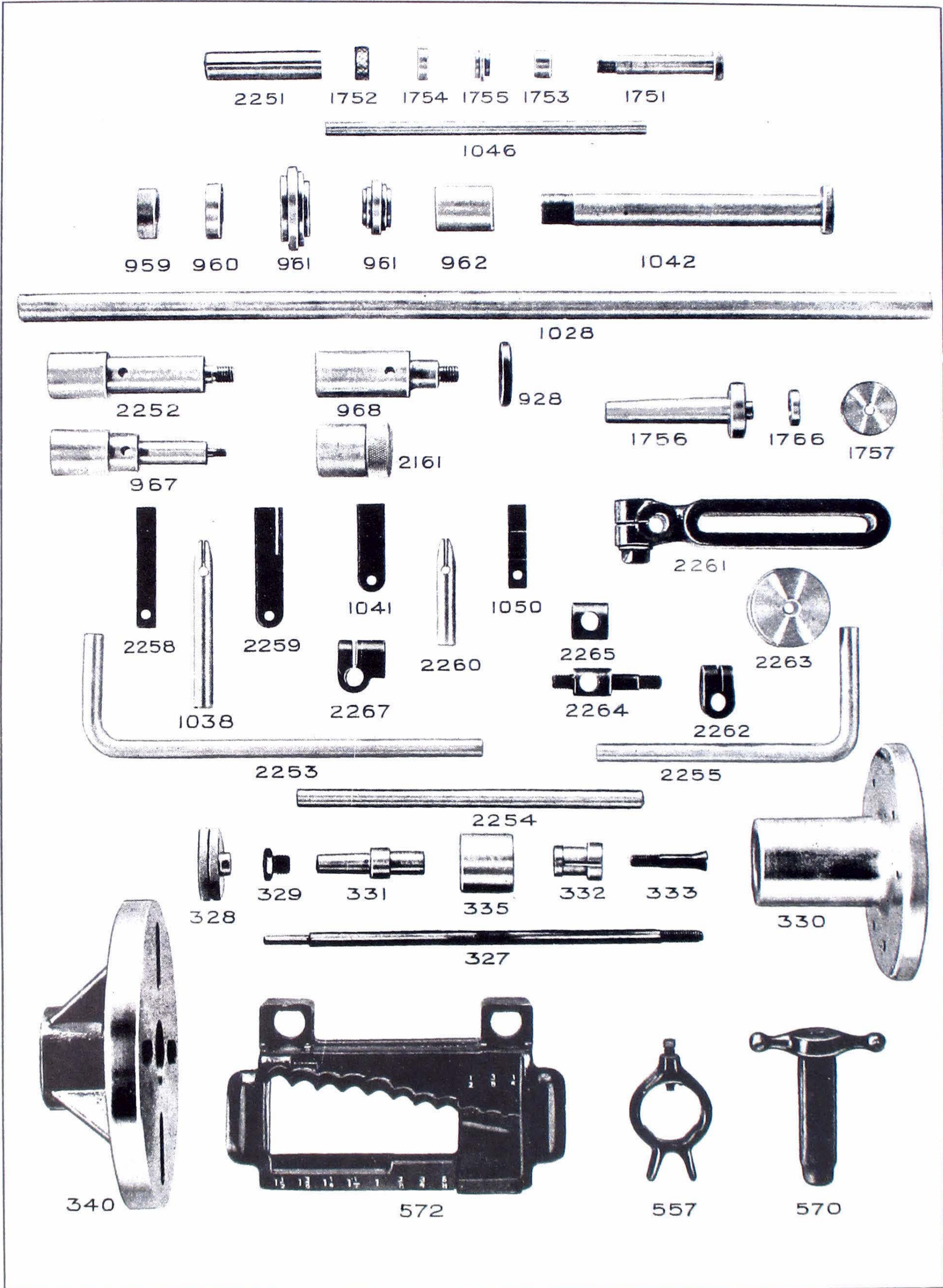

Miscellaneous Parts

When ordering parts, state the size, style and serial number of the machine in addition to the part number and name.

Miscellaneous Parts

327	Face Chuck Socket Rod
328	Chuck Socket Rod Knob
329	Chuck Thrust Screw
330	Face Chuck
331	Face Chuck Socket
332	Face Chuck Bushing
333	Face Chuck Bushing Screw
335	Face Chuck Shell
340	Face Plate
557	Work Driving Dog, Specify Size
570	Socket Wrench, Specify Size
572	Dog Tray
928	$\frac{3}{4}$ " Wheel Arbor Washer
959	$\frac{7}{8}$ " Sliding Shell Collar Nut
960	$\frac{7}{8}$ " Sliding Shell Collar, Recessed
961	$\frac{7}{8}$ " Sliding Shell Step Collar, Specify Large or Small
962	$\frac{7}{8}$ " Sliding Shell Collars, Specify Length
967	$\frac{1}{4}$ " Wheel Arbor, Specify Right or Left Hand
968	$\frac{3}{4}$ " Wheel Arbor
1028	$\frac{3}{4}$ " Cutter Bar
1038	Tooth Rest Holder, Long
1041	Tooth Rest, Angular
1042	$\frac{7}{8}$ " Sliding Shell
1046	$\frac{3}{8}$ " Cutter Bar
1050	Tooth Rest, Short
1751	$\frac{1}{2}$ " Sliding Shell
1752	$\frac{1}{2}$ " Sliding Shell Collar Nut
1753	$\frac{1}{2}$ " Sliding Shell Collars, Specify Length
1754	$\frac{1}{2}$ " Sliding Shell Collar, Recessed
1755	$\frac{1}{2}$ " Sliding Shell Step Collar
1756	Straddle Mill Arbor
1757	Straddle Mill Arbor Washer
1766	Straddle Mill Arbor Collar, Specify Diameter
2161	Wheel Spindle Guard, Specify Right or Left Hand
2251	Small Cutter Bar Bushing
2252	$\frac{1}{2}$ " Wheel Arbor
2253	Tooth Rest Elbow, Long
2254	Tooth Rest Post
2255	Tooth Rest Elbow, Short
2258	Tooth Rest, Long
2259	Tooth Rest, Side
2260	Tooth Rest Holder, Short
2261	Tooth Rest Holder Bracket
2262	Tooth Rest Holder Clamp, Short
2263	Tooth Rest Holder Bracket Washer
2264	Tooth Rest Stud
2265	Tooth Rest Sleeve
2267	Tooth Rest Holder Clamp, Long

Countershaft
Overhead Driven Machine

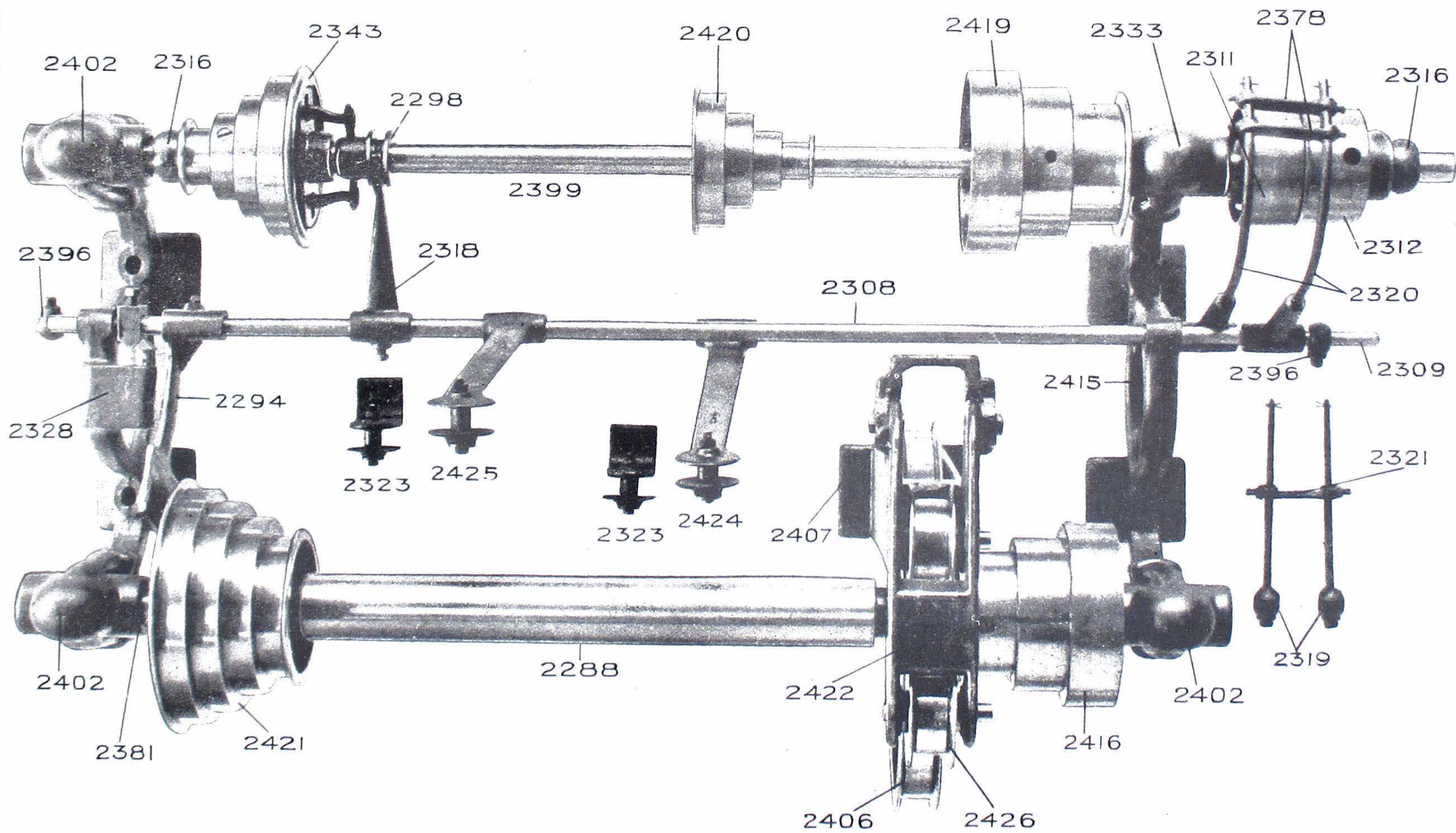

When ordering parts, state the size, style and serial number of the machine in addition to the part number and name.

Countershaft Parts

Overhead Driven Machine

2288	Work Drum
2294	Brake
2298	Thimble
2308	Clutch Shipper Rod
2309	Tight and Loose Pulley Shipper Rod
2311	Standard Tight Pulley
2312	Standard Loose Pulley
2316	Collar
2318	Shipper Fork
2319	Belt Guide
2320	Wire Belt Guide
2321	Belt Guide Yoke
2323	Shipper Bracket
2328	Hanger, with Plunger
2333	Drip Complete, Open Both Ends
2343	Headstock Driving Cone Pulley
2378	Wire Belt Guide Yoke
2381	Drum Pulley Shaft
2396	Shipper Stop
2399	Countershaft, Main Driving
2402	Drip Complete, Open One End
2406	Spindle Driving Pulley
2407	Belt Tightener Bracket
2415	Hanger, 2 Box
2416	Wheel Driven Cone Pulley
2419	Wheel Driving Cone Pulley
2420	Feed Driving Cone Pulley
2421	Headstock Driven Cone Pulley
2422	Belt Tightener
2424	Shipper Arm, Curved
2425	Shipper Arm, Straight
2426	Swinging Idler Pulley

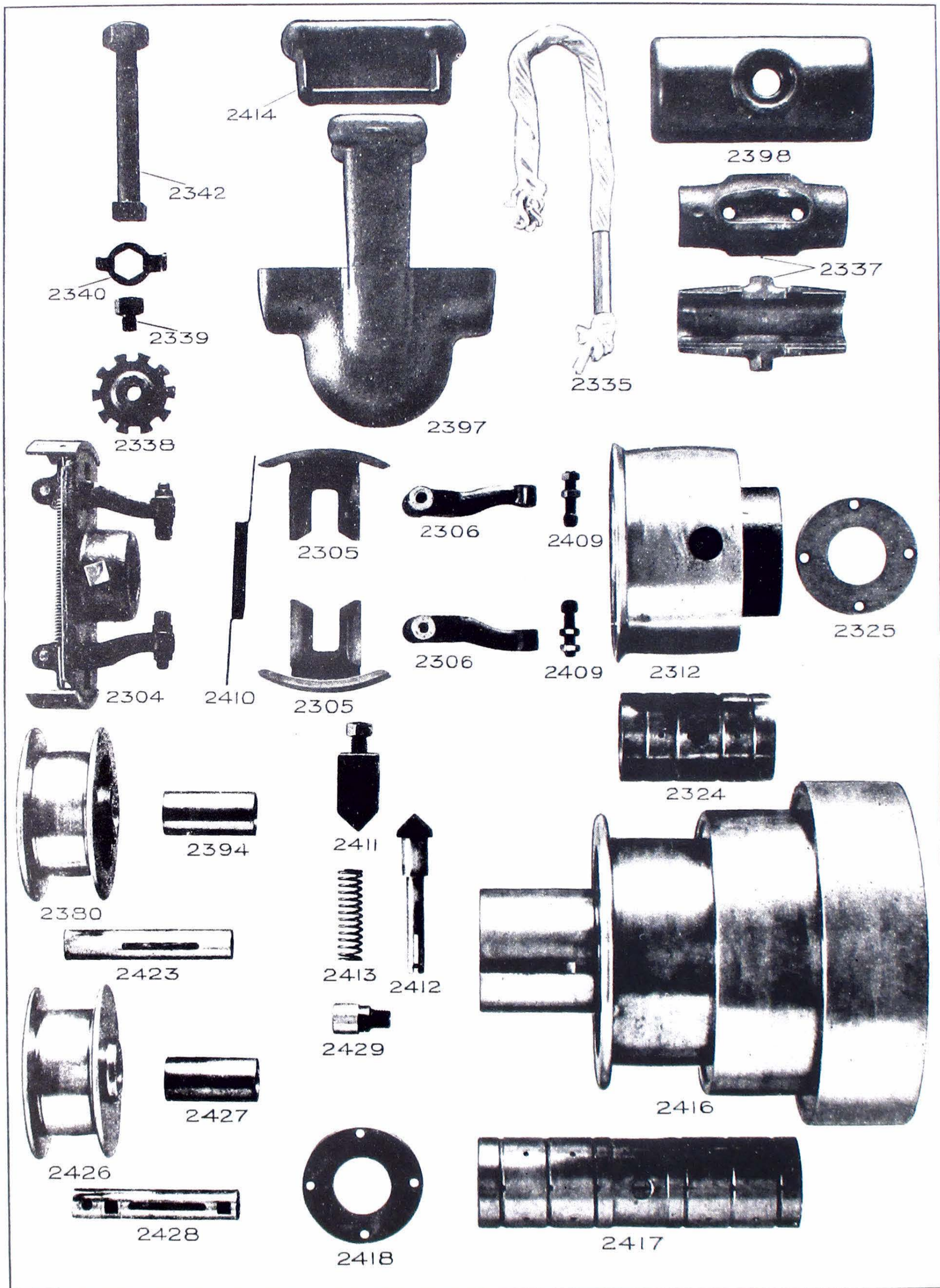

Countershaft Parts
Overhead Driven Machine

When ordering parts, state the size, style and serial number of the machine in addition to the part number and name.

Countershaft

Overhead Driven Machine

2304	Friction Pulley Back, Complete
2305	Friction Pulley Slide
2306	Friction Pulley Lever
2312	Standard Loose Pulley
2324	Standard Loose Pulley Bushing
2325	Loose Pulley Cap
2335	Wick
2337	Box, Complete
2338	Drip Cover Washer
2339	Drip Cover Washer Screw
2340	Drip Cover Screw Lock
2342	Hanger Bolt
2380	Idler Pulley
2394	Idler Pulley Bushing
2397	Drip, Specify Open One End or Both Ends
2398	Drip Cover, Specify Open One End or Both Ends
2409	Friction Pulley Lever Screw
2410	Friction Pulley Spring
2411	Plunger Stop
2412	Plunger
2413	Plunger Spring
2414	Hanger Drop Extension
2416	Wheel Driven Cone Pulley
2417	Wheel Driven Cone Pulley Bushing
2418	Wheel Driven Cone Pulley Bushing Cap
2423	Idler Pulley Shaft
2426	Swinging Idler Pulley
2427	Swinging Idler Pulley Bushing
2428	Swinging Idler Pulley Shaft
2429	Belt Tightener Bracket Stud

3858 548 552 550 549 550 552 548 553

541 540

544

3859

3861 3860

543 545 3871

546 555 554

3863

542 529 621

3864

FIXTURE SERIAL NUMBER STAMPED HERE

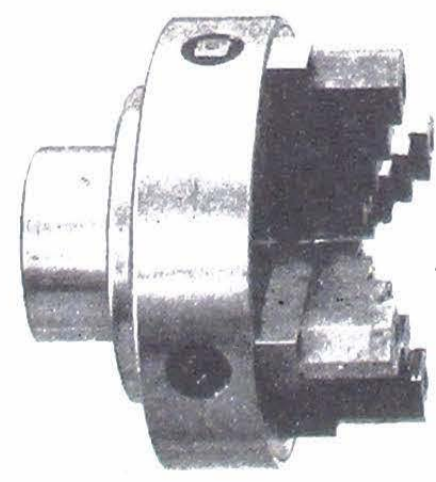

3870

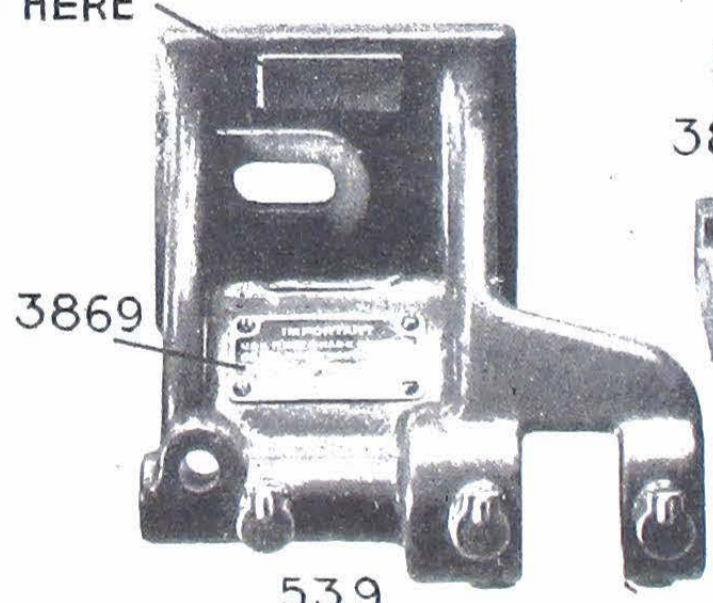

539

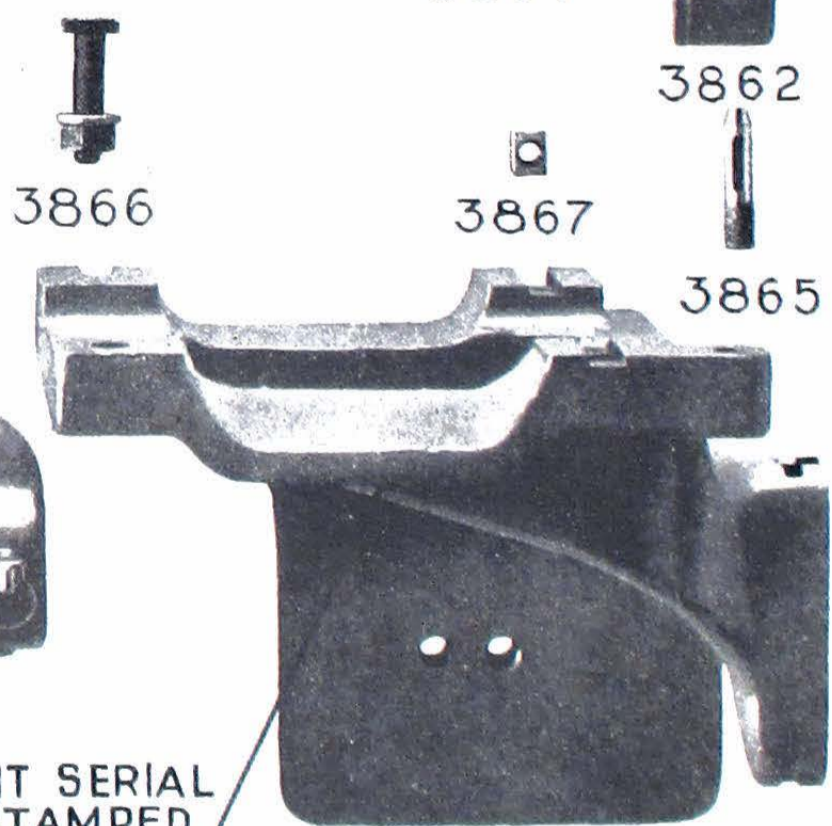

3868

ATTACHMENT SERIAL NUMBER STAMPED HERE

620

Internal Grinding Attachment
Additional Equipment

When ordering parts, state the name and serial number of the attachment, or the size, name and serial number of the fixture, in addition to the part number and name.

Internal Grinding Attachment

Additional Equipment

No. 03 Internal Grinding Fixture (Complete)	
3859	Idler Pulley Stud
3860	Idler Pulley
3861	Idler Pulley Bushing
3862	Idler Pulley Bracket
3863	Driving Pulley
3864	Idler Pulley Bracket Bolt
3865	Stand Support Locating Pin
3866	Stand Support Bolt
3867	Stand Support Tongue
3868	Stand Support
3870	4" 4-Jaw Chuck

Internal Grinding Fixture

529	Arbor (Specify Length)
539	Internal Grinding Fixture Stand
540	Wheel Bushing
541	Wheel Spindle Washer
542	Arbor Screw
543	Wheel Spindle Box
544	Outer Shell
545	Inner Shell
546	Wheel Spindle
548	Ball Bearing
549	Pulley
550	Bearing Case
552	Pulley Spindle Sleeve
553	Bearing Case Cap
554	Pulley Spindle Nut
555	Pulley Spindle
620	Outer Shell and Box Clamp Bushing
621	Wheel Spindle
3858	Ball Bearing Clamp Nut
3869	Spindle Lubrication Notice Plate
3871	Inner Shell Bushing

