

• NOTE - Cutter head repairs: Special tools are required to remove and replace ball bearings on the cutter head. When the bearings or cutter need replacement, order a complete new cutter head assembly No. 37-809, or return the old one for repair at a cost of present list prices for the new parts plus a small labor charge per bearing for installing.

KNIFE SHARPENING SERVICE - There is a nominal charge per cutter head for regrinding and setting the knives. This charge is net and F. O. B. Factory, and does not include replacement of knife blades damaged to the extent that they cannot be re-sharpened. Be sure to send the complete cutter head assembly with knife blades, ball bearings and housing, less cutter head pulley, by prepaid express or parcel post insured for repair or sharpening service.

•• IMPORTANT - Base and front table cannot be supplied separately, as the reassembled machine would not be accurate. For true alignment, we finish grind our jointer table after assembly on the base. When a new table or base is required, send a letter to Rockwell Mfg Co., Pittsburgh 8, Pa., for shipping instructions. Ship the machine less fence and knife guard. The cost will be the list price for new parts plus a nominal fixed charge for assembling and grinding the tables.

## Replacement Parts

Ref. No.	Part No.	Description	Ref. No.	Part No.	Description
• 1	Cat. #37-809	Cutterhead Assembly, incl:	38	413-94-108-0002	Rod
2	418-03-060-0002	Bearing Housing - Left Side	39	413-94-075-0001	Pointer
3	920-04-010-5355	Bearing - Left Side	40	1230199	Knob
4	920-04-010-7267	Bearing - Pulley Side	41	413-94-108-0004	Rod
5	418-03-060-0001	Bearing Housing - Pulley Side	42	928-02-232-1768	Tension Spring
6	Cat. #37-659	Set of 3 Knives (old Cat. # 659)	43	413-94-108-0003	Rod
7	NJ-254	Knife Lock Bar	44	960-02-012-1474	Nameplate
8	J-23	1/4-28 X 3/8 Spec. Hex. Hd. Screw	45	SP-2250	#4 X 3/16 Drive Screw
9	SP-658	3/8-24 X 1 Hex. Hd. Cap Screw	46	413-94-055-0001	Guide
10	SP-1704	3/8 Lockwasher	47	SP-2106	Gotter Pin
12	Cat. #37-522	Special Wrench (Old Cat. #1522)	•• 48		Base
13	Cat. #41-023	2-1/2 Dia. Curterhead Pulley (5/8 Bore), incl:	50	413-94-412-0003	Screw w/Knob
14	SP-206	5/16-18 X 5/16 Hex. Soc. Set Screw (Cup Pt.)	51	BM-46	25/64 X 15/16 X 1/8 Washer
15	SP-2655	3/16 X 3/16 X 7/8 Key	52	413-94-084-0002	Slide
16	413-94-354-0001	Knife Guard Assembly, incl:	53	SP-602	5/16-18 X 1-1/4 Hex. Hd. Cap Screw
19	SP-2106	Cotter Pin	54	413-94-027-0003	Clamp
20	413-94-071-0001	1/2 X 1-1/4 Groove Pin	55	1230199	Knob
•• 25		Table	56	SP-1615	13/32 X 13/16 X 1/16 Washer
26	SP-1186	#10-32 X 1/4 Hex. Soc. Set Screw (Cup Pt.)	57	413-94-004-0001	Bar
27	J-15	Spring	58	413-94-054-0002	Guard
28	901-06-450-2254	#8 X 3/8 Drive Screw	59	0905961	5/16 Pal Nut
29	413-94-108-0001	Rod	60	413-94-108-0005	Rod
30	BM-45	Spring Washer	61	413-94-004-0002	Bar
31	413-94-367-0001	Lever Assembly, consisting of:	62	413-94-088-0001	Stop
32	SP-2704	Lever	63	901-03-110-3318	#10-32 X 3/8 Soc. Hd. Cap Screw
33	1230208	1/8 X 3/4 Roll Pin	64	SP-1603	1/4 X 9/16 X 3/64 Washer
34	413-94-067-0001	Rod	65	SP-1701	3/16 Lockwasher
35	1230198	Lever	66	905-02-020-2496	3/16 X 5/8 Groove Pin
36	951-02-012-9001	Knob (Tapped 5/16-18)	67	413-94-067-0003	Lever
37	SP-2250	Depth of Cut Scale	68	SP-606	5/16-18 X 5/8 Hex. Hd. Cap Screw
		#4 X 3/16 Drive Screw	69	SP-1604	5/16 X 3/4 X 1/16 Washer
			70	413-94-014-0001	Bracket
			71	413-94-043-0001	Fence
			75	Cat. #1535	3/16 Hex. Wrench

\* See footnote on page 14.

•• See footnote on page 14.

## ACCESSORIES

- 50-515 STAND
- 50-518 CASTER SET FOR 50-515 STAND
- 41-043 REPLACEMENT MOTOR PULLEY
- 49-273 REPLACEMENT V-BELT
- 37-659 JOINTER KNIVES



# 37-220 6" JOINTER

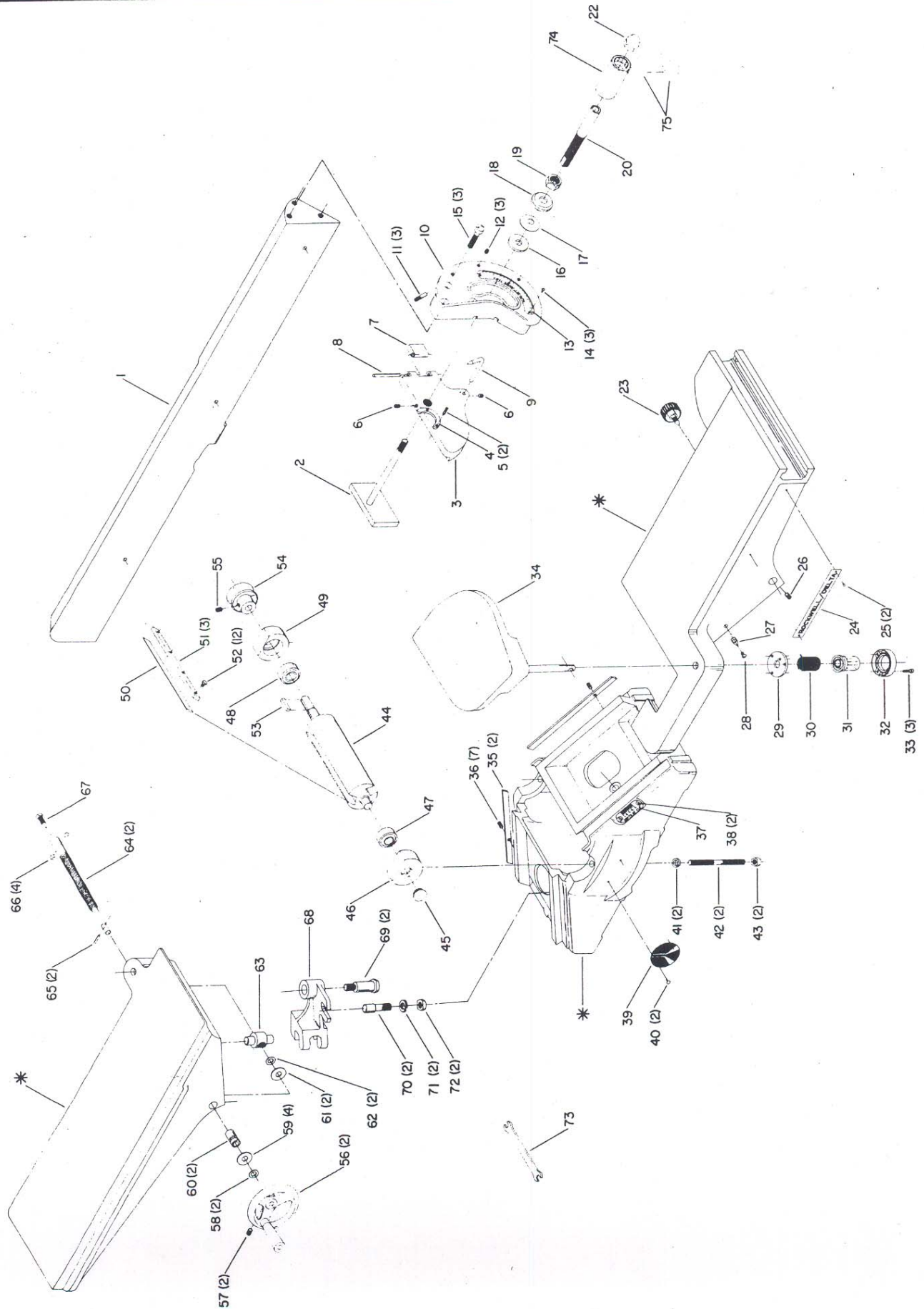

# Replacement Parts

Ref. No.	Part No.	Description	Ref. No.	Part No.	Description
*		Base	39	960-02-012-0037	Nameplate
*		Front Table	40	SP-2250	#4-3/16" Drive Screw
*		Rear Table	41	SP-1704	3/8" Lockwasher
1	DJ-4	Fence Body	42	418-03-411-0002	Stud
2	DJ-23-S	Clamp Plate w/Stud	43	SP-1207	3/8-24 Hex Nut
3	NJ-228-S	Cross Slide Ass'y., including:	44	Cat. #37-808	Cutter Head Assembly, including:
4	NJ-229	Key	45	SP-7460	Plug
5	SP-2707	5/32 x 1/2" Roll pin	46	NJ-255-S	Bearing Housing Left Side
6	SP-253	1/4-28 X 1/4" Soc. Set Screw	47	SP-5336	Bearing, Left Side
7	NJ-231	Stop Block	48	SP-5337	Bearing, Pulley Side
8	SP-2705	7/32 X 1-7/8" Roll Pin	49	NJ-252	Bearing Housing, Pulley Side
9	NJ-241	Pointer	50	Cat. #37-659	Set of Three Knives
10	DJ-5-S	Fence Segment, including:	51	NJ-254	Lock Bar
11	NJ-233	1/4-28 X 1" Headless Set Screw	52	J-23	Special Screw
12	NCS-177	1/4-28 X 1/4" Headless Set Screw	53	SP-2655	Key
13	NJ-240	Tilt Angle Scale	54	Cat. #41-033	Cutter Head Pulley, including:
14	SP-2250	#4 X 3/16" Drive Screw	55	SP-201	5/16-18 X 5/16" Hex Soc. Set Sc
15	SP-706	3/8-16 x 1-1/4" Fil. Hd. Mach. Scr.	56	1086490	Handwheel Ass'y., including:
16	NJ-239	Special Washer	57	SP-201	5/16-18 X 5/16" Hex Soc. Set Sc
17	NJ-243	Spring Washer	58	SBS-55	Special Washer
18	NJ-242	Collar	59	LBS-170	Fiber Washer
19	NJ-238	Special Jam Nut	60	418-03-017-0001	Bushing
20	NJ-236	Clamp Sleeve	61	LBS-170	Fiber Washer
22	NJ-244	Cap Nut	62	SBS-55	Special Washer
23	DJ-21-S	Hand Knob	63	DJ-17	Adjusting Nut
24	960-02-012-1420	Nameplate	64	DJ-27	Adjusting Screw
25	SP-2250	#4 X 3/16" Drive Screw	65	SP-2711	1/8 X 5/8" Roll Pin
26	SP-253	1/4-28 X 1/4" Soc. Set Screw	66	DJ-14	Lock Dog
27	SBS-46	Pointer	67	DJ-20	Lock Screw
28	SP-551	#10-32 X 1/4" Rd. Hd. Mach. Scr.	68	DJ-6-L	L. H. Bell Crank
29	DJ-10	Special Washer	68	DJ-6-R	R. H. Bell Crank
30	DJ-13	Torsion Spring	69	DJ-15	Pivot Pin
31	DJ-9	Hand Knob	70	DJ-16	Shoulder Pin
32	DJ-11	Retainer Ring	71	SP-1705	1/2" Lockwasher
33	SP-723	#8-32 X 1/2" Fil. Hd. Mach. Scr.	72	SP-1006	1/2-13 Hex Nut
34	DJ-7-W	Knife Guard	73	Cat. #37-522	Open End Wrench
35	DJ-25	Gib	74	931-04-991-5912	Wrench Assembly, Consisting of:
36	901-04-150-0256	1/4-28 X 5/8" Soc. Set Screw	75	1202610	Rod and Knob Assembly
37	DJ-26	Depth Scale			
38	SP-2252	#2 X 3/16" Drive Screw			

- IMPORTANT - Base, front and rear tables cannot be supplied separately, as the reassembled machine would not be accurate. For true alignment, we finish grind our jointer table after assembly on the base. When a new table or base is required, send a letter to Rockwell International, Power Tool Division, Pittsburgh, Pa. 15208, for shipping instructions. Ship the machine less fence and knife guard. The cost will be the list price for new parts plus a nominal fixed charge for assembling and grinding the tables.

NOTE - Cutter head repairs: Special tools are required to remove and replace ball bearings on the cutter head. When the bearings or cutter need replacement, order a complete new cutter head assembly No. 37-808, or return the old one to Rockwell International, Bellefontaine, Ohio 43311, for repair at a cost of present list prices for the new parts plus a small labor charge per bearing for installing.

KNIFE SHARPENING SERVICE - There is a nominal charge per cutter head for regrinding and setting the knives. This charge is net and F.O.B. Factory, and does not include replacement of knife blades damaged to the extent that they cannot be re-sharpened. Be sure to send the complete cutter head assembly with knife blades, ball bearings and housing, less cutter head pulley to Rockwell International, Bellefontaine, Ohio 43311, by prepaid express or parcel post insured, for repairs or sharpening service.



## REPLACING FRONT OR REAR TABLE RAISING AND LOWERING MECHANISM ON THE 37-220 6" JOINTER

1. Disconnect machine from power source, remove fence and guard, and lay jointer upside down on floor or workbench.

2. Loosen set screw in handwheel (A) Fig. 1, and remove handwheel (A) from shaft.

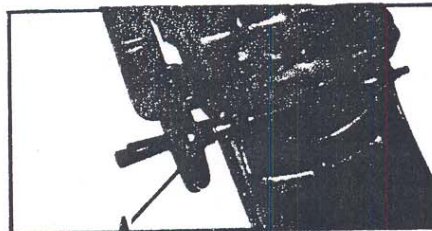

Fig. 1

3. Remove roll pin from shaft (B) Fig. 2, and remove fiber washer and steel washer (C). Then unscrew and remove pivot pin (D) Fig. 2.



Fig. 2

4. Fig. 3 illustrates the pivot pin (D), fiber washer and steel washer (C), and handwheel (A) removed from the shaft.

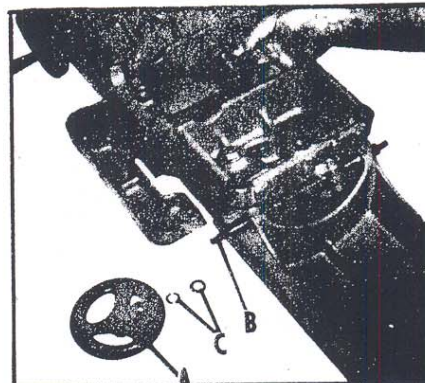

Fig. 3

5. Unscrew and remove shaft (B), as shown in Fig. 4.

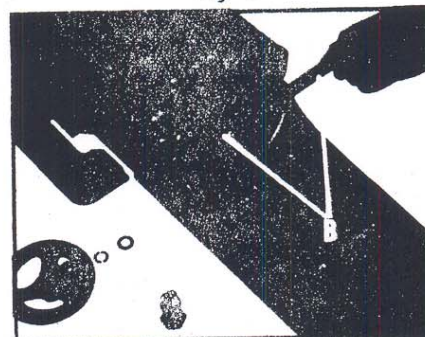

Fig. 4

6. Remove the bell crank (E) and the adjusting nut (F) Fig. 5, from the jointer.

7. Replace necessary parts and reassemble in the reverse order.

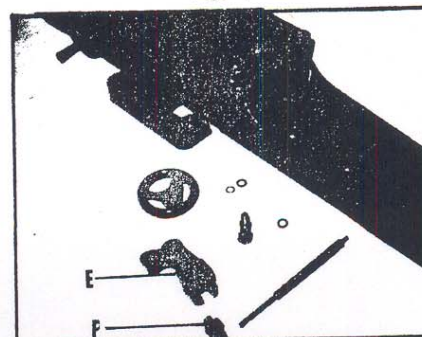

Fig. 5